

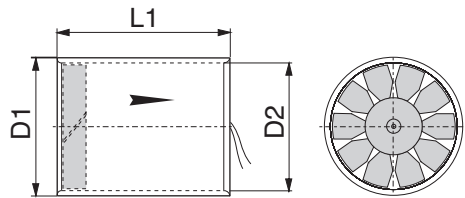

**Axiallüfter**  
**Axial Fans**  
**Ventilateurs Axial**

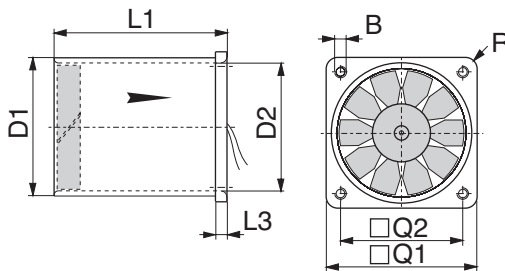

**D481T/Q**



**D483T/Q**

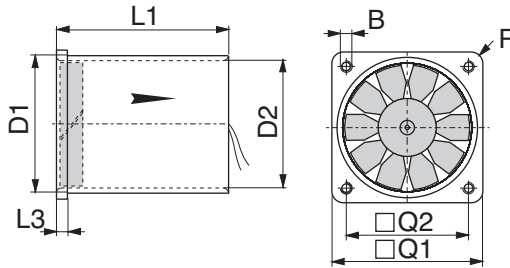

**D484T/Q**

**D481T, 483T, 484T 12 VDC**

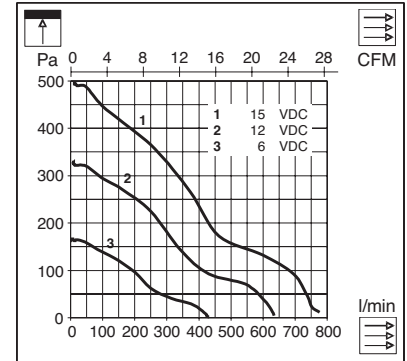

**D481T, 483T, 484T 24 VDC**

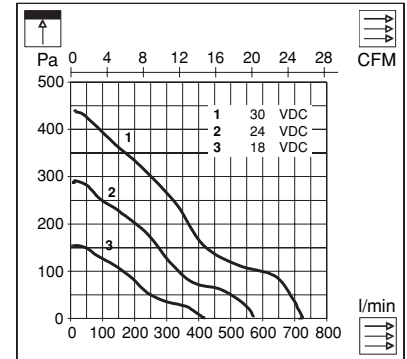

**D481Q, 483Q, 484Q 12 VDC**

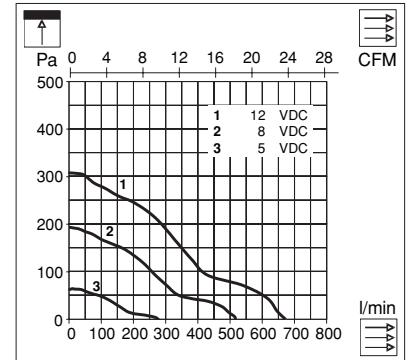

**D481Q, 483Q, 484Q 24 VDC**

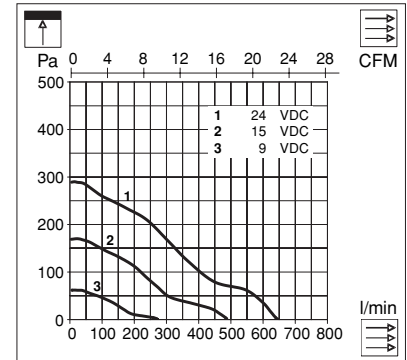

D480	mm	inch
D1	48	1.900
D2	44.4	1.748
L1	60	2.362
L3	4	0.157
B	M3	
Q1	52	2.047
Q2	42	1.653
R	4	0.157



## Technische Daten

## Technical data

## Caractéristiques techniques

Die D480Q-Baureihe ist mit einem bürstenlosen Motor, mit integrierter Elektronik (3 Litzenversion; + Vcc, Gnd, Tachosignal) ausgerüstet

- sehr lange Laufzeit
- Spannungsbereich 5-15 VDC/9-30 VDC
- Tachosignal
- Strombegrenzung

Option: 10 Litzen Ausgang mit weiteren Funktionen

The serie D480Q is equipped with a brushless motor, with integrated electronic (3 leads version; + Vcc, Gnd, tachosignal)

- Long life
- voltage range 5-15 VDC/9-30 VDC
- tacho signal
- current limitation

Option: 10 leads-version with further functions

La série D480Q est équipée d'un moteur "brushless" avec électronique intégrée, (3 fils version; + Vcc, Gnd, tachosignal)

- Usage longue vie
- gamme de tension 5-15 VDC/9-30 VDC
- signal tacho
- limite de courant

Option: version 10 fils avec fonctions supplémentaires

Types			D481T/D483T/D484T		D481Q/D483Q/D484Q	
<b>U</b>	U <sub>N</sub>	V	<b>12</b>	<b>24</b>	<b>12</b>	<b>24</b>
	U	V	9...15	18...30	5...15	9...30
<b>I</b>	I <sub>N</sub>	mA	295	119	456	220
	I <sub>max</sub>	mA	354	143	570	275
	I <sub>block</sub>	A	5.6	4.3	2.4	1.5
<b>P</b>	P <sub>N</sub>	W	3.5	2.9	5.5	5.3
	n	min <sup>-1</sup>	11'520	10'660	11'450	11'050
	$\dot{V}$	l/min; CFM	634/22.38	570/20.12	626/22.08	644/22.72
	p	Pa	325	285	308	290
	LpA	dB(A)	53	51	53	52
<b>MTTF</b>	MTTF	hr	12'000		40'000	
	T	°C/F	-20...+65 / -5...+150		-20...+65 / -5...+150	
	m	g/oz.	164/5.78		148/5.22	
	Lead Length	mm/inch	220/8.66 (AWG 24)		220/8.66 (AWG 26)	
	Housing Material		Aluminium		Aluminium	
	Sleeve Bearing		-		-	
	Ball Bearing		•		•	
	Brushless Motor		-		•	
	Flat Finger Guard		•		•	
	Circular Finger Guard		•		•	
	Explosion Protection		-		<b>i</b>	

### Zusätzliche Funktionen 10 Litzen Version (R-Version)

- Analog Ausgang (variable Drehzahl)
- PLL (konstante Drehzahl)
- Stop-Funktion
- Richtungswechsel
- NOS
- Tachosignal

### Additional Functions 10 Lead Version (R-Version)

- Analog output (variable speed)
- PLL (constant speed)
- Brake function
- Direction
- NOS
- Tacho signal

### Fonctions supplémentaires version à 10 fils (R-version)

- PWM (vitesse variable)
- PLL (vitesse constant)
- Function stop
- Changer de direction
- NOS
- Signal tacho

Connector  
for 10 lead version

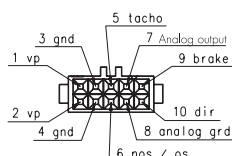

Typ: Tyco V23535-3280-101