

THIS INFORMATION IS CONFIDENTIAL AND PROPRIETARY TO CW INDUSTRIES INCORPORATED AND ITS AFFILIATES. IT MAY NOT BE DISCLOSED TO ANYONE, OTHER THAN CW INDUSTRIES PERSONNEL, WITHOUT WRITTEN AUTHORIZATION FROM CW INDUSTRIES INCORPORATED, SOUTHAMPTON, PENNSYLVANIA USA.

Rating	6A 14V DC, 3A 28V DC
Contact Resistance	50m ohm max.
Insulation Resistance	DC 500V 100M ohm min.
Dielectric Strength	AC 1500V 1 minute
Operating Temperature	-0° C ~ 55° C

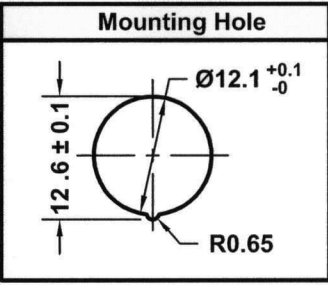

Cut-Out 0.7 ~ 3.0 mm thk.

Frames are nylon (UL flame: 94V-2).  
Illuminated actuators are molded in PC,  
available in Red, Amber or Green colors.  
Terminals are silver plated brass.

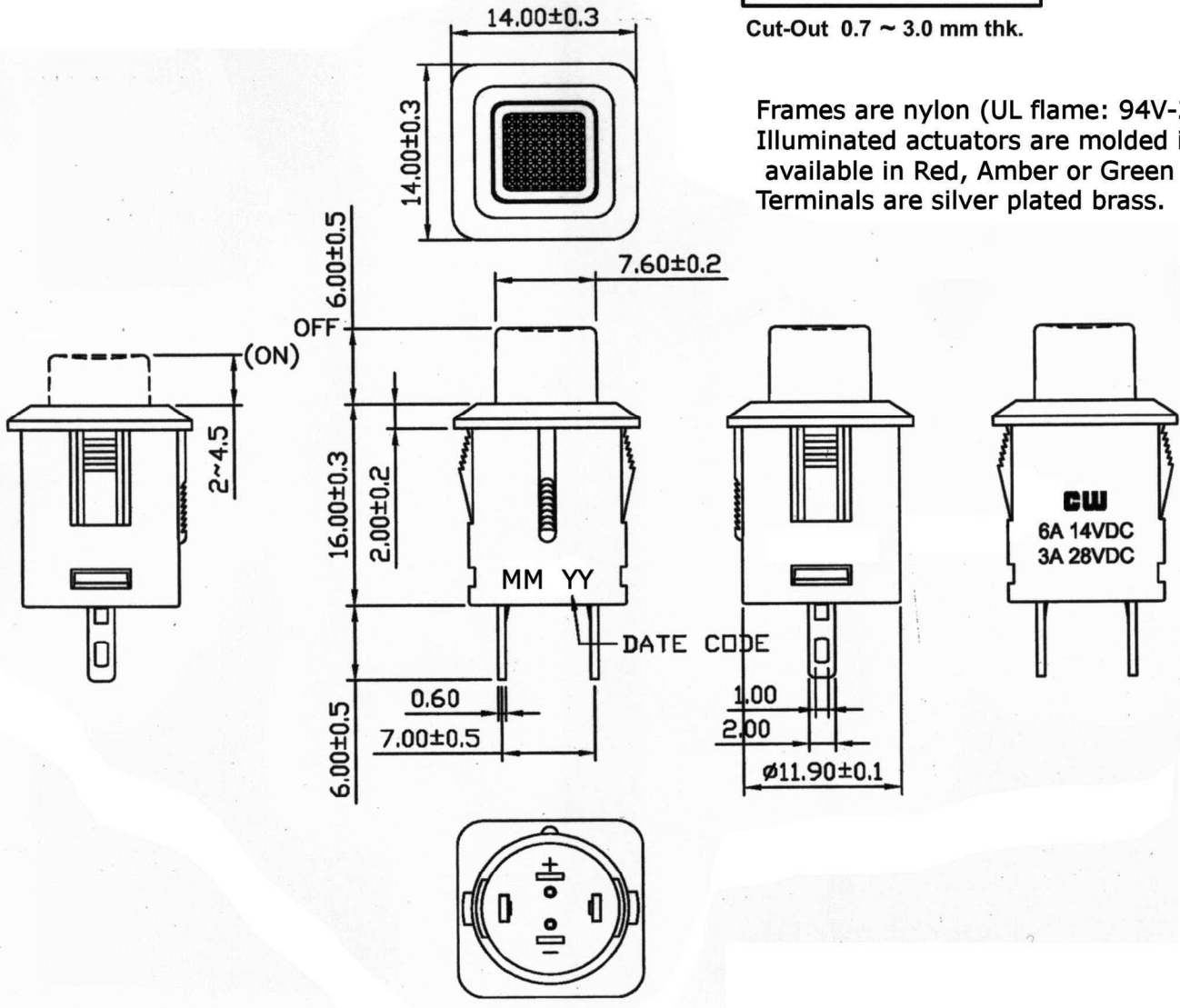

**FUNCTION**

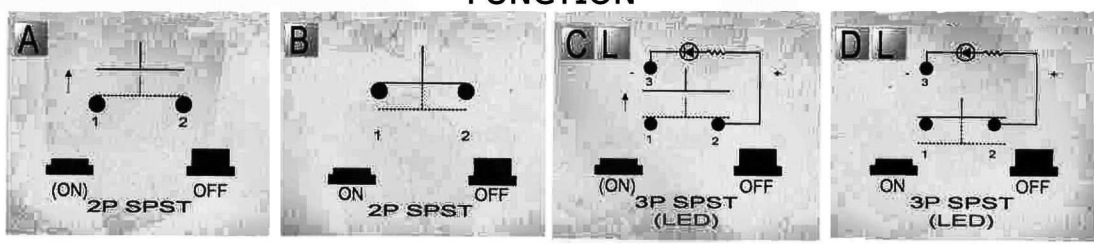

( ) = Momentary Function

**TERMINAL**



RoHS Compliant

**CW INDUSTRIES**  
Southampton, Pa. 18966  
Tel 215.355.7080/www.cwind.com

Date Drawn: 2/08/11

Rev. 0

Unit: mm

Checked By: G.GULD

Title: **PUSH BUTTON SWITCH**

CW P/N: **GPB554XSERIES**