

# COMMON MODE CHOKES

# ACM0434CI

- Common mode choke for lan and telecom applications
- High Impedance to minimize common mode noise
- Excellent EMI performance
- Industrial temperature: -40°C to +130°C

Electrical Specifications @25°C±3							
Part Number	Turns Ratio @10KHz,0.1V	OCL @10KHz 0.1V		DCR		HI-POT 1mA/2S	R.Current
		1-2	4-3	1-2	4-3		
ACM0434CI	1:1±2%	1.8mH min	1.8mH min	80m Max	80m Max	pin(1-2) to pin( 3-4)	2.5A

All specifications subject to change without notice.

## MECHANICAL

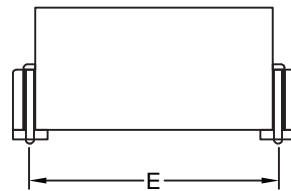
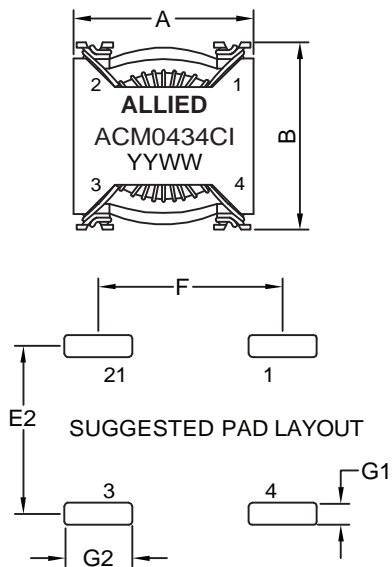

DIM	MILLIMETERS
A	17.02MAX
B	19.56MAX
C	9.9MAX
E1	16.51±0.4
E2	16.51TYP
F	11.30TYP
G1	1.52TYP
G2	4.45TYP

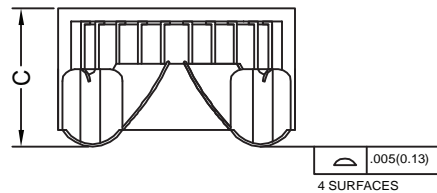

Unless otherwise specified all tolerances are:±0.25 in mm

## SCHEMATICS

