

G50**25 kV**

Make & Break Load Switching
RoHS Compliant, date code 0701 and later

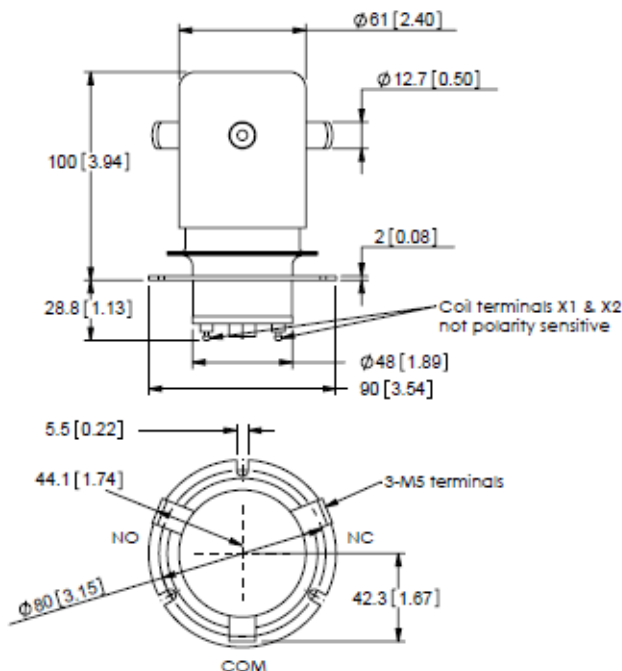

PRODUCT SPECIFICATIONS		
Contact & Relay Ratings	Units	G50
Contact Form		C
Contact Arrangement		SPDT
Voltage, Test Max., Contacts & to Base (15 μ A Leakage Max., dc or 60Hz)	kV Peak	30
Voltage, Operating Max., Contacts & to Base (15 μ A Leakage Max.)		
dc or 60 Hz	kV Peak	25
2.5 MHz	kV Peak	-
16 MHz	kV Peak	-
32 MHz	kV Peak	-
Current, Continuous Carry Max		
dc or 60 Hz	Amps	110
2.5 MHz	Amps	-
16 MHz	Amps	-
32 MHz	Amps	-
Coil Hi-Pot (V RMS, 60 Hz)	V	500
Capacitance		
Across Open Contacts	pF	5
Contacts to Ground	pF	5
Resistance, Contact Max @ 1A, 28 Vdc	ohms	0.005
Operate Time	ms	100
Release Time	ms	15
Life, Mechanical	cycles	1 million
Weight, Nominal	g (oz)	1000 (35)
Vibration, Operating, Sine (55-500 Hz Peak)	G's	10
Shock, Operating, 1/2 Sine 11ms (Peak)	G's	30
Temperature Ambient Operating	$^{\circ}$ C	-55 to +125
Maximum Terminal Temperature	$^{\circ}$ C	200

COIL RATINGS	
Nominal, Volts dc	26.5
Pick-up, Volts dc, Max.	16
Drop-Out, Volts dc	1-10
Coil Resistance (Ohms $\pm 10\%$)	60

Ratings listed are for 25 $^{\circ}$ C, sea level conditions

For more information, refer to

[Relay User Instructions](#)

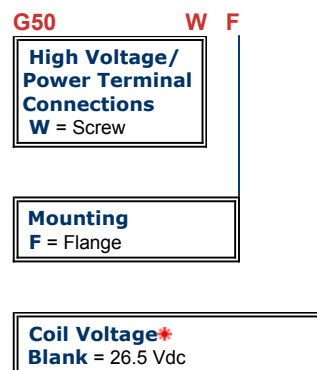

05/17/13

GIGAVAC®

GIGAVAC® - P.O. Box 4428 - Santa Barbara, CA 93140-4428 - ph +(805) 684-8401 - +(805) 755-2000
fx +(805) 684-8402 - info@gigavac.com - www.gigavac.com - ©Copyright 2003- 2013 GIGAVAC, LLC.