

THE INFORMATION CONTAINED IN THIS DRAWING IS THE SOLE PROPERTY OF BUD INDUSTRIES INC. ANY REPRODUCTION IN PART OR WHOLE WITHOUT THE WRITTEN PERMISSION OF BUD INDUSTRIES INC. IS PROHIBITED.

ISSUE		REVISIONS
(A)	REVISOR	6-30-08 DAB
(B)	PER ECN # 10404	12-4-08 DAB
(C)	PER ECN # 10446	1-13-09 BT

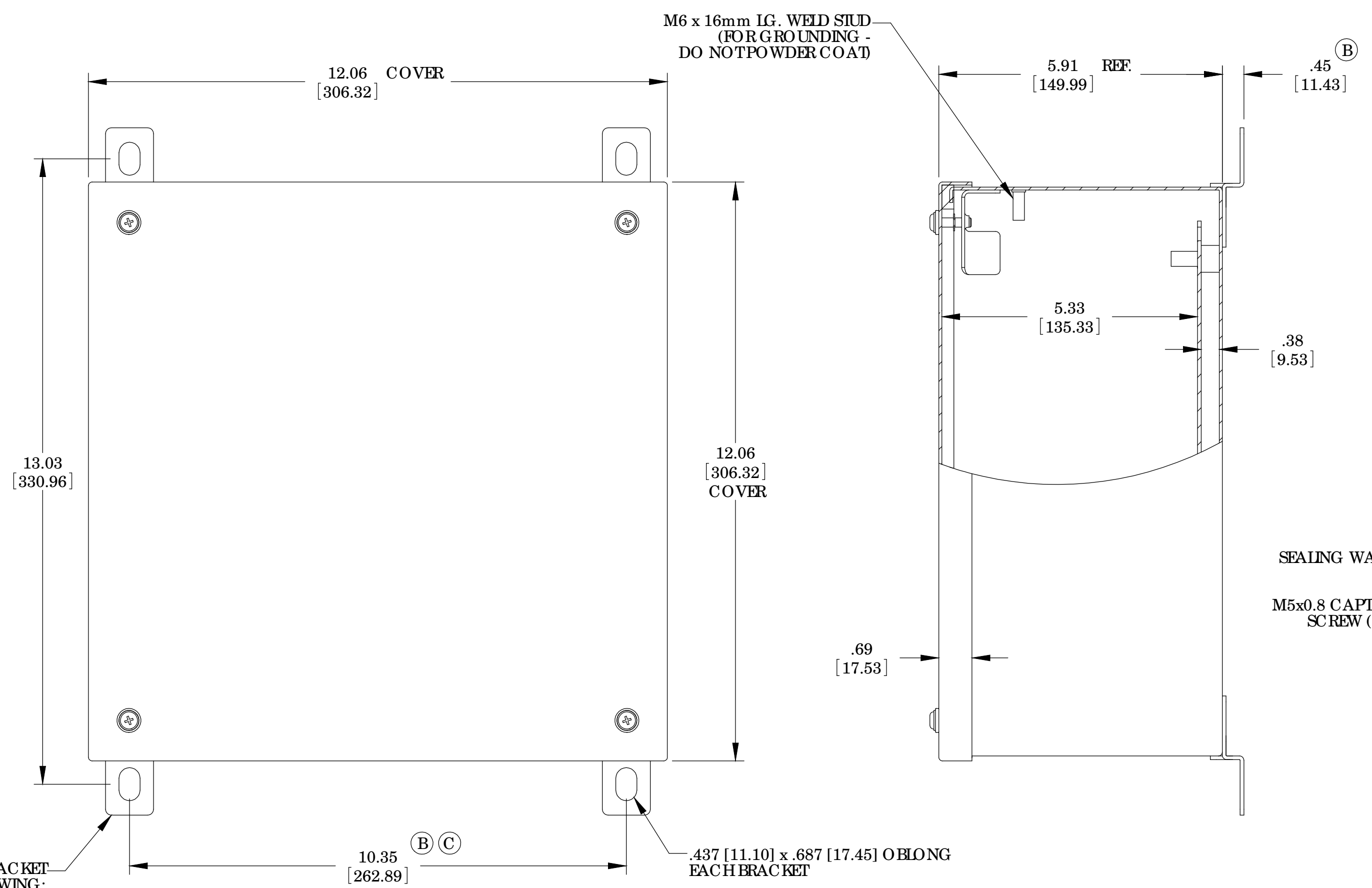

MATERIAL:
 BODY, COVER MOUNTING BRACKETS, COVER - 16 GA. [1.5mm] C.R.S.
 INTERNAL PANEL - 14 GA. [2.0mm] C.R.S.
 WALL MOUNTING BRACKETS - 14 GA. [2.0mm] STAINLESS STEEL
 HARDWARE - STAINLESS STEEL
 GASKET - .25 [6.35] THICK NBR PRENE (BLACK) OR EQUIVALENT
 SEALING WASHERS - BLACK NBR PRENE OR EQUIVALENT

FINISH:
 BODY & COVER - LIGHT GRAY SMOOTH POWDER COAT
 INTERNAL PANEL - ZINC CHROMATE
 WALL MOUNTING BRACKETS - NATURAL

WALL MOUNTING BRACKET KIT TO CONTAIN THE FOLLOWING:
 (4) BRACKETS, (4) BOLTS, (4) SEALING WASHERS, (4) FLAT WASHERS, (4) LOCK WASHERS & (4) HEX NUTS

RETAINING CLIP (4x)

SEALING WASHER (4x)
 M5x0.8 CAPTIVE SCREW (4x)

SEE DETAIL 'B' (INSIDE VIEW)

WELD & GRIND SMOOTH ALL CORNERS

NO GAP BETWEEN GASKET JOINT. OPTIONALLY JOINT MAY BE SEALED WITH ADHESIVE.

.50 TYP. [12.70]

DETAIL B SCALE 2 : 2.75

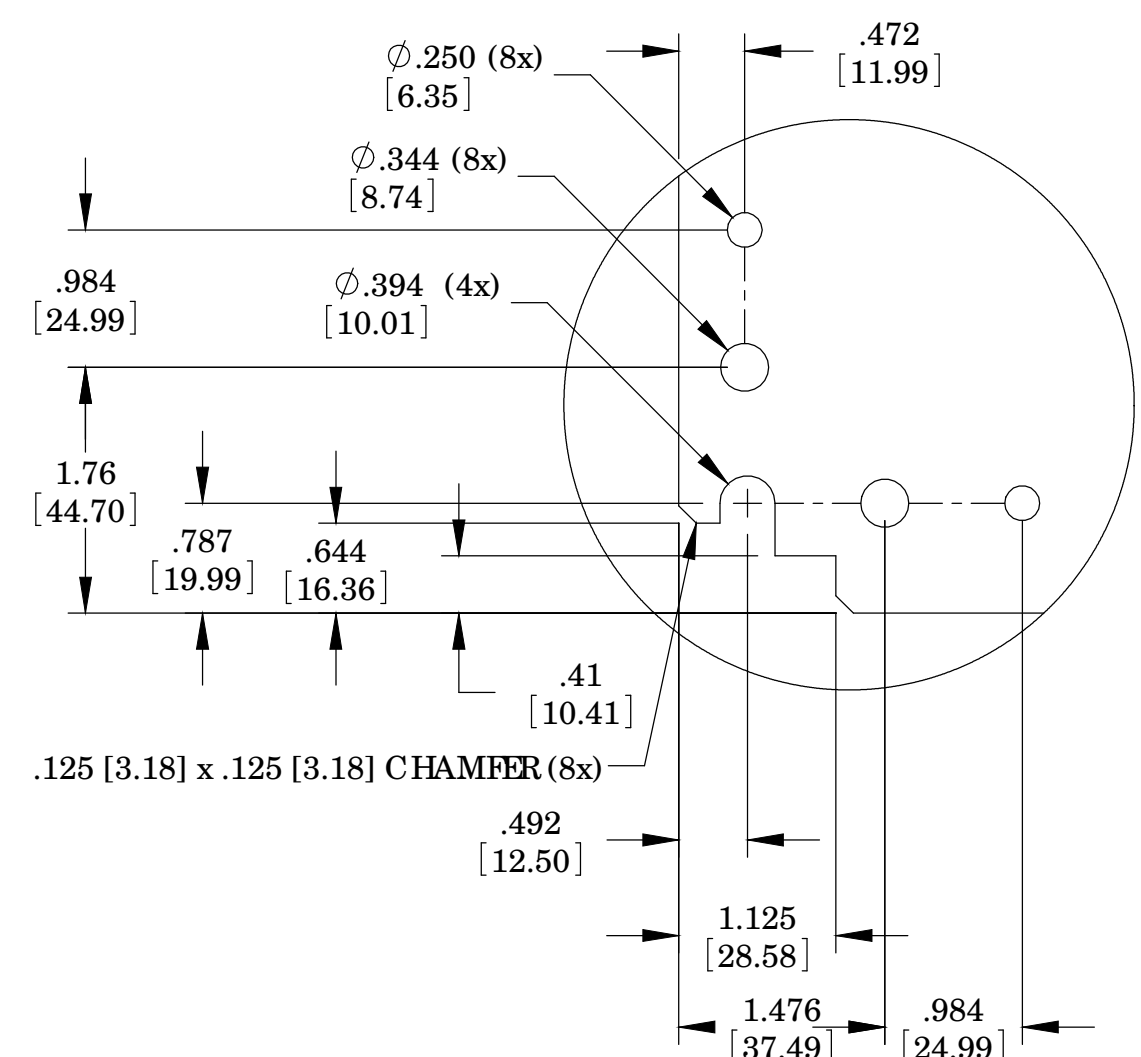
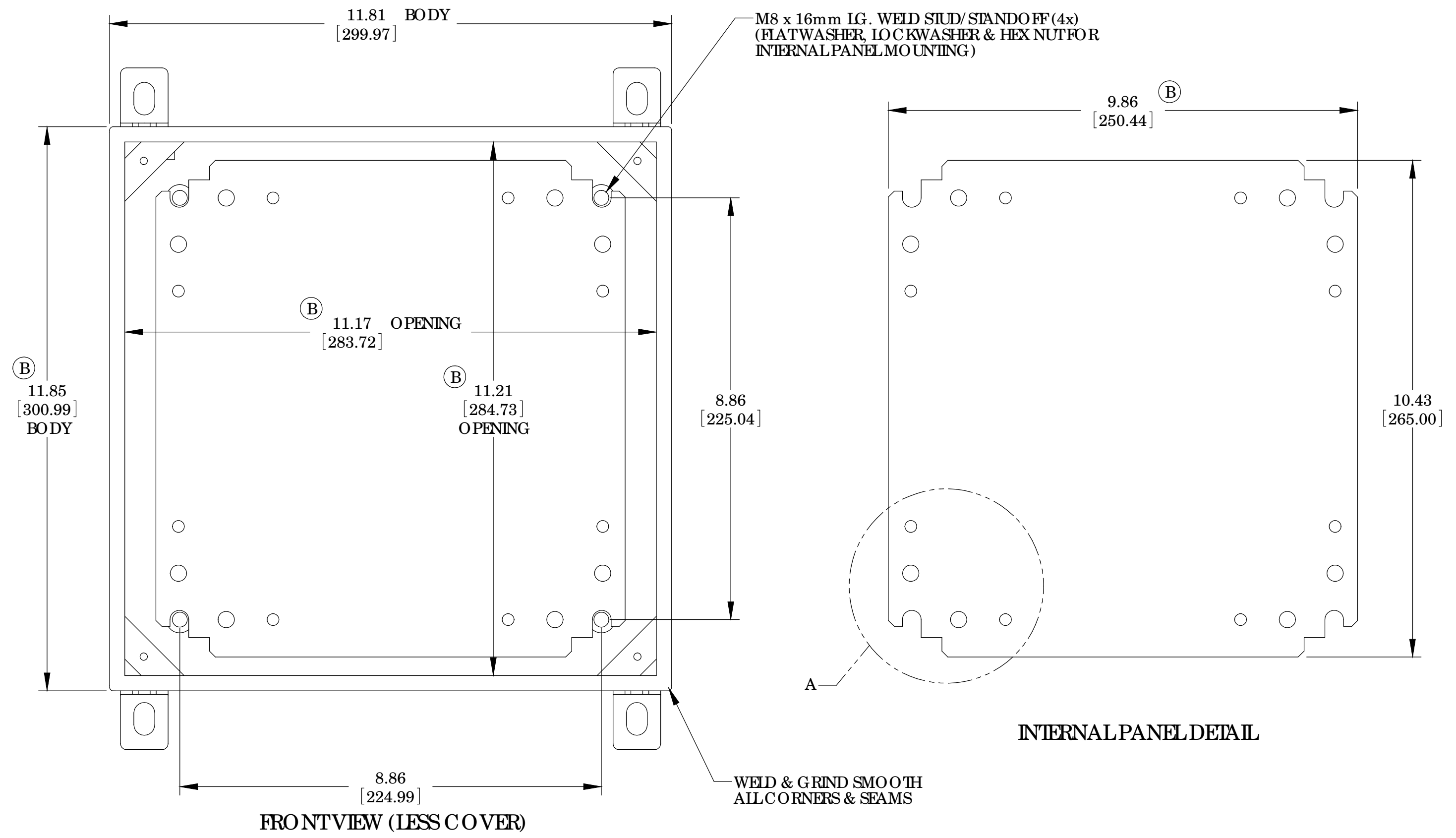

FRONT VIEW (LESS COVER)

DETAIL A SCALE 2 : 2.75

UNLESS OTHERWISE SPECIFIED ALL DIMENSIONS ARE IN INCHES		CAD GENERATED DRAWING DO NOT MANUALLY UPDATE		BUD INDUSTRIES INC.	
DESIGNED BY	DAB	DATE	5-5-08	NEMA SHEET METAL BOX w/LIFT-OFF SCREW COVER	
DRAWN BY	DAB	DATE	5-5-08		
MATERIAL	AS NOTED	FINISH	AS NOTED	SCALE	1

QTY	USED ON	DO NOT SCALE DRAWING	SCALE	CAD FILE	SHEET 1 OF 1
2					