

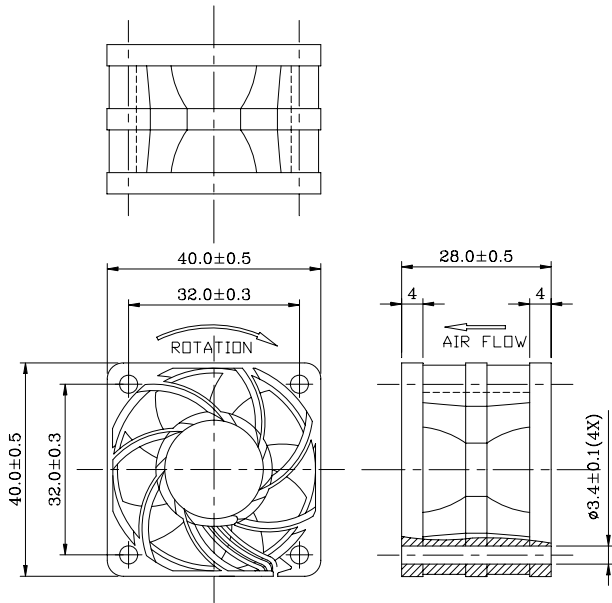
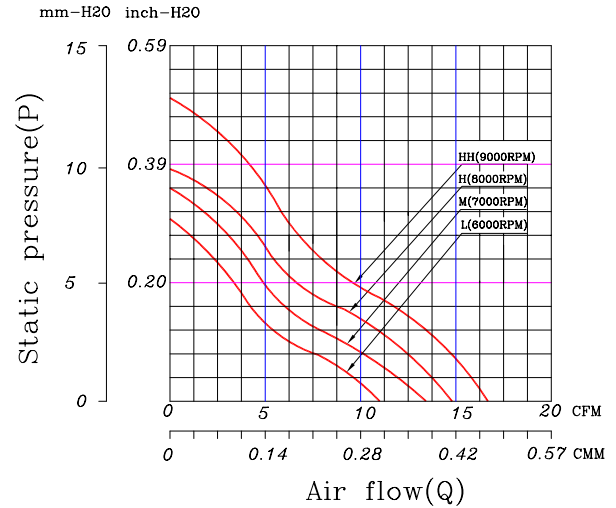

40 x 40 x 28 mm Series
12/24 VDC
Dimensions

Performance Curves

Air exhaust over struts. Rotational direction CCW looking at rotor

| Brushless DC Motor | Bearing Type |
|--------------------------|-------------------|
| Housing: PBT 94V0 | ● CeraDyna A |
| Impeller: PBT 94V0 | ● CeraDyna C |
| Weight: 30 g | ● 2-Ball |
| Impedance protected | ● 1-Ball-1-Sleeve |
| Lead wire UL 1095 AWG 28 | ● Sleeve |

| Function options | |
|-----------------------|----------------------|
| ● Frequency Generator | ● Auto Restart |
| ○ Temperature Control | ● Rotation Detection |
| ○ PWM Control | |

* Safety Approval: CE, UL, TUV

* All fans are with electronic protection against reverse polarity. The fan only operates when the polarity is correct.

Specifications

| Model | Rated Voltage (VDC) | Rated Current (Amp) | Input Power (Watts) | Nominal Speed (RPM) | Airflow (CFM) | Static Pressure (inch-H ₂ O) | Noise Level (dBA) |
|---------------|---------------------|---------------------|---------------------|---------------------|---------------|---|-------------------|
| FD1240-A00XXM | 12 | 0.31 | 3.72 | 9000 | 16.65 | 0.50 | 41.00 |
| FD1240-A10XXM | 12 | 0.24 | 2.88 | 8000 | 14.80 | 0.39 | 36.00 |
| FD1240-A20XXM | 12 | 0.19 | 2.28 | 7000 | 12.95 | 0.35 | 33.00 |
| FD1240-A30XXM | 12 | 0.14 | 1.68 | 6000 | 11.10 | 0.30 | 29.00 |
| FD2440-A00XXM | 24 | 0.24 | 5.76 | 9000 | 16.65 | 0.50 | 41.00 |
| FD2440-A10XXM | 24 | 0.16 | 3.84 | 8000 | 14.80 | 0.39 | 36.00 |
| FD2440-A20XXM | 24 | 0.12 | 2.88 | 7000 | 12.95 | 0.35 | 33.00 |
| FD2440-A30XXM | 24 | 0.10 | 2.40 | 6000 | 11.10 | 0.30 | 29.00 |

* All readings are typical value at rated voltage.

 * Please refer to **PART NUMBER SYSTEM** for bearing type and part number "XX" designation.

* Specifications are subject to change without prior notice.

* Please specify revision number when ordering.