

SERIES 2A

- Sub-miniature toggle switches

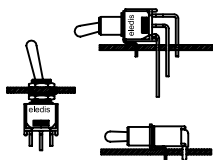

AGENCY APPROVALS



File N° E195524



File N° E195524

CHARACTERISTICS

- A tiny switch suitable for most miniature equipments.
- High current switching up to 3 Amps @ 120 VAC or 28 VDC.

SPECIFICATIONS

Contact Rating: **S** (silver) - 3A with resistive load @ 125 VAC or 28 VDC - 1.5A with resistive load @ 250 VAC - **A** (gold) or **K*** (gold/tin-lead) - 0.4 VA max @ 20 VAC or DC max

Electrical life: 30,000 make and break cycles at full load

Contact Resistance: 20 mΩ max. initial @ 2-4 VDC - 100 mA, for both silver and gold plated contacts

Insulation Resistance: 1000 MΩ min.

Dielectric Strength: 1500 VRMS @ sea level

Operating Temperature: -30°C to 85°C

MATERIALS

Case: Dially phthalate (DAP)

Plunger: Brass, chrome plated

Bushing: Brass, nickel plated

Terminal support: Brass, electrotin plated

Housing: Stainless Steel

HOW TO ORDER

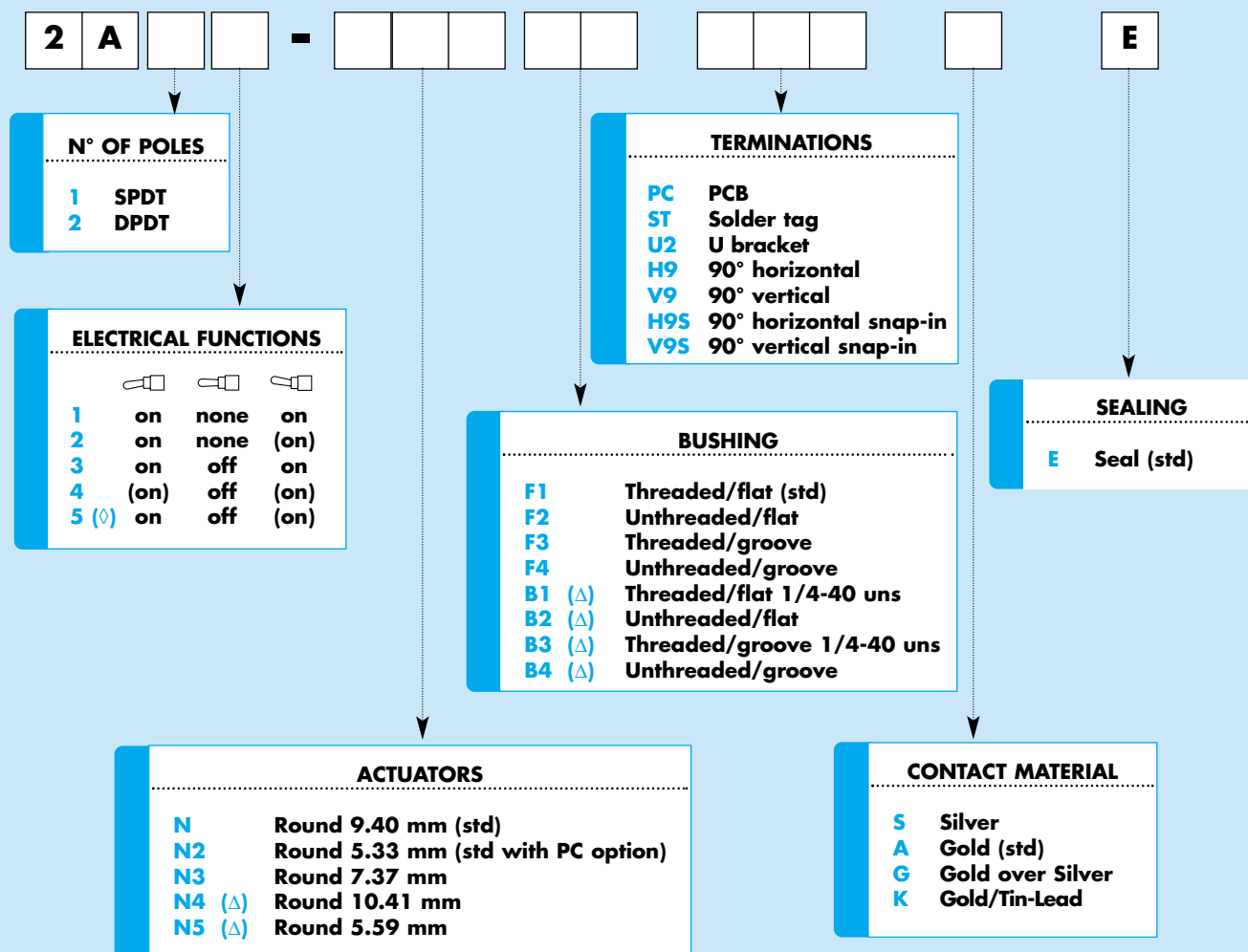

(Δ) Min qty required

(∅) Please enquire

SERIES 2A

ELECTRICAL FUNCTIONS

SPDT			
1	on	none	on
2	on	none	(on)
3	on	off	on
4	(on)	off	(on)
5 (Δ)	on	off	(on)
2 - 3	open	2 - 1	

2 Comm.



(Δ) Please enquire

DPDT			
1	on	none	on
2	on	none	(on)
3	on	off	on
4	(on)	off	(on)
5	on	off	(on)
2-3, 5-6	open	2-1, 5-4	

2 Comm. 5 Comm.

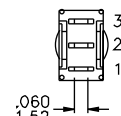
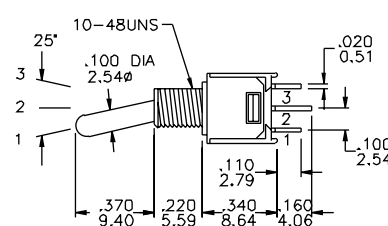
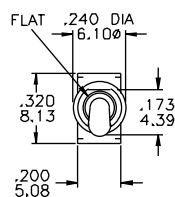
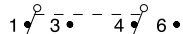

Part N° shown: 2A11-NF1STSE

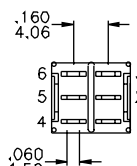
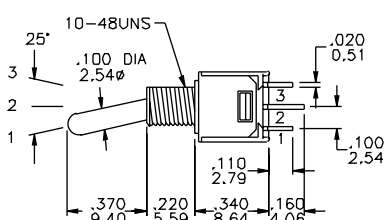
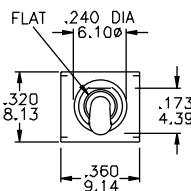

Part N° shown: 2A21-NF1STSE

ACTUATORS

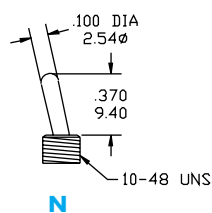

N

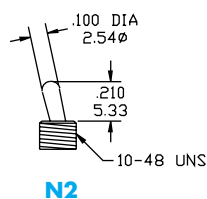

N2

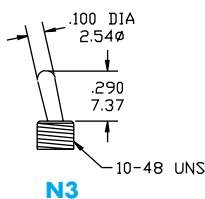

N3

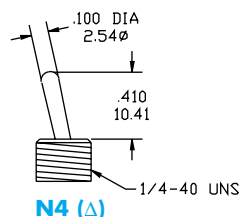

N4 (Δ)

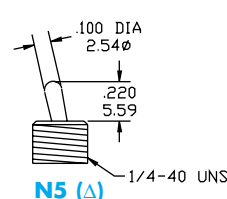

N5 (Δ)

(Δ) Min qty required

BUSHING

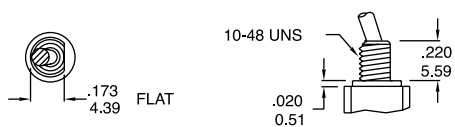

F1 Threaded

F2 Non Threaded

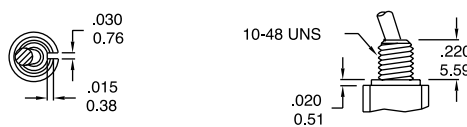

F3 Threaded

F4 Non Threaded

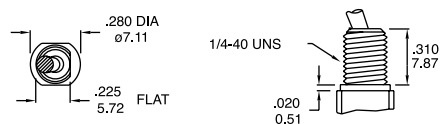

B1 (Δ) Threaded flat

B2 (Δ) Non Threaded flat

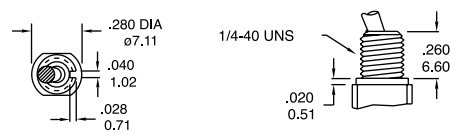

B3 (Δ) Threaded

B4 (Δ) Non Threaded

(Δ) Min qty required.

Note: B Bushings can fit actuators N4 and N5 only.

SERIES 2A

TERMINATIONS

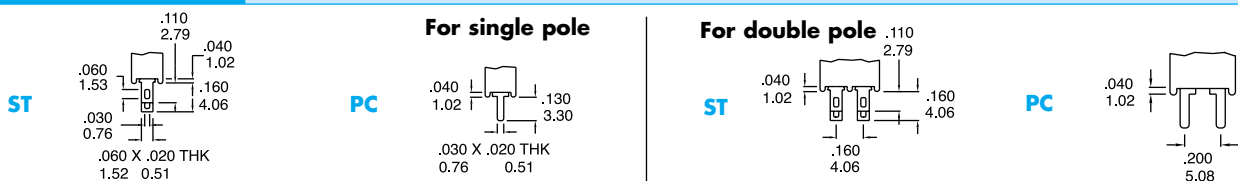
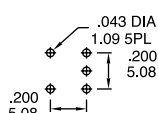
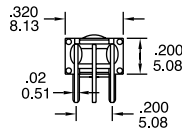
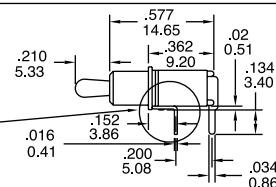
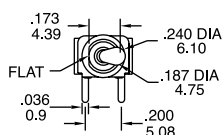
**H9
SPDT**

Part N° shown: 2A11-N2F2H9AE

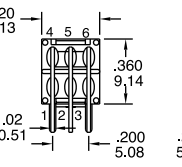
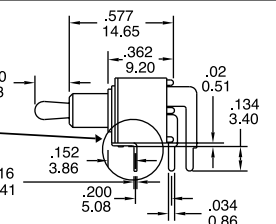
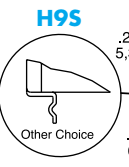
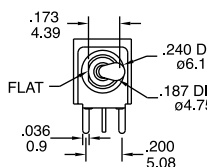
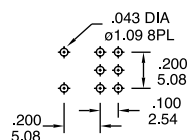
**H9
DPDT****P.C. LAYOUT**

Part N° shown: 2A21-N2F2H9AE

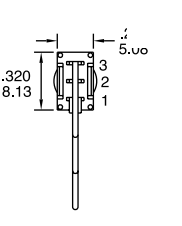
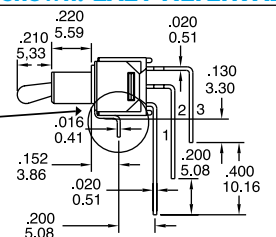
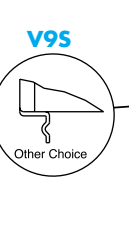
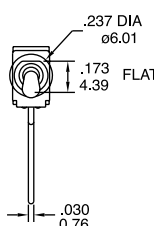
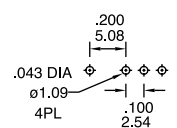
**V9
SPDT****P.C. LAYOUT**

Part N° shown: 2A11-N2F2V9AE

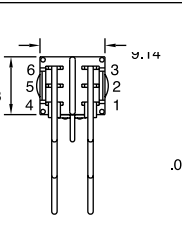
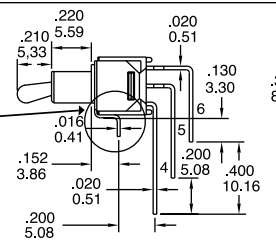
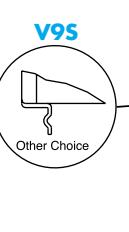
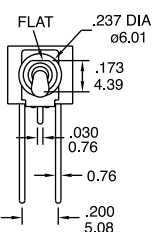
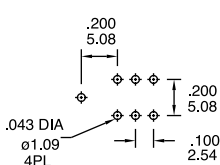
**V9
DPDT****P.C. LAYOUT**

Part N° shown: 2A21-N2F2V9AE

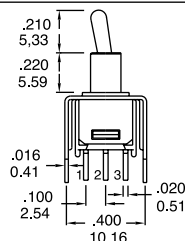
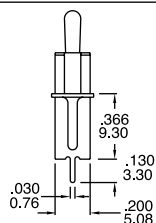
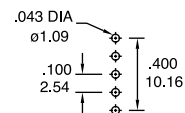
**U2
SPDT****P.C. LAYOUT**

Part N° shown: 2A11-N2F2U2AE

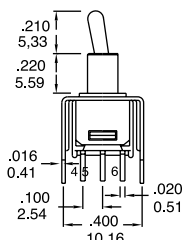
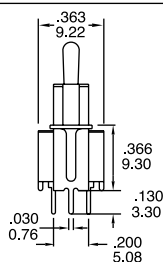
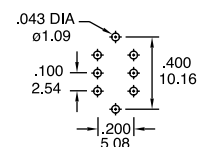
**U2
DPDT****P.C. LAYOUT**

Part N° shown: 2A21-N2F2U2AE

SERIES 2A

CONTACT MATERIALS

CONTACT RATINGS

S **Moving Contacts:** coin silver, silver plated
Terminals: brass, silver plated
Rating: 3 Amps @ 120 VAC or 28 VDC
 1.5 Amps @ 250 VAC

A (std) **Moving Contacts:** brass with gold plate over nickel plate
Terminals: brass with gold plate over nickel plate
Rating: 0.4 Volts/Amps max @ 20 VAC or DC max

K (Δ) Same as **A**, but with pre-tinned terminals

G **Moving Contacts:** coin silver gold plated
Terminals: brass silver plated and gold plated
Note: **G** option used for either "high" (2 Amps @ 250 VAC) or "low" (0.4 Volts/Amps max) contact rating (one exclude the other)

(Δ) Min qty required

PANEL CUT-OUT

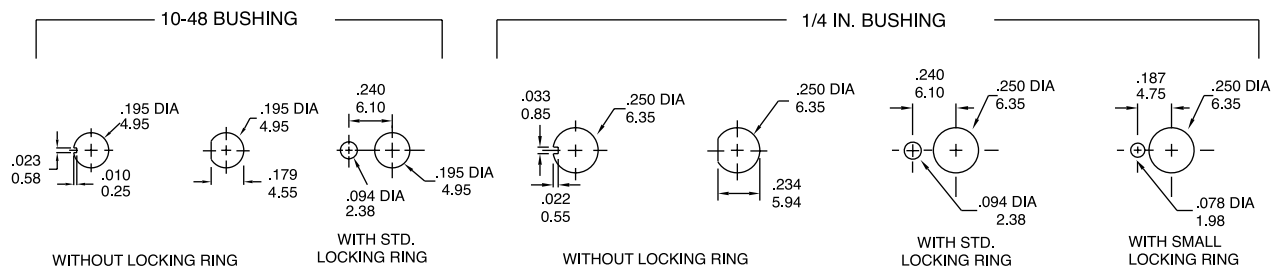

ACCESSORIES

NUTS

STD.200

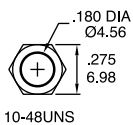

10-48UNS



For series 2A
HDW21

RINGS & WASHERS

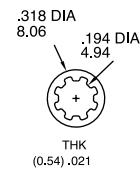
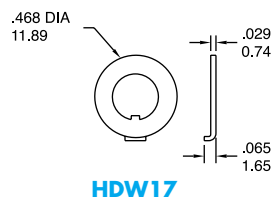

For series 2A
HDW22

STANDARD SUPPLY

- 2 Nuts**
- 1 Locking Ring**
- 1 Lock Washer**

SERIES 2A

PACKAGING

Transparent Trays 15x21x4 cm

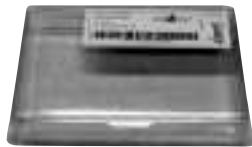

Qty per tray: (ST, PC Terminals)
 Series 2A1x 500 pcs
 2A2x 200 pcs

MARKING (on products)



The switches are individually marked with the following information:

- Side 1** TRADE MARK
 SERIES AND MODEL
 DATE CODE
- Side 2** RATING
 CONTACTS

Note: Not all informations may be available on some products.

LABELLING (on packaging)

The label on each tray gives full information on the products contained.

P/N: EL.FNC.: Q.TY: DATE CODE: 	 Made in Taiwan
Remarks	

A Bar code indicating Model, Quantity, Date Code enables easy traceability.