

Coaxial

Power Splitter/Combiner

4 Way-0° 50Ω 10 to 800 MHz

ZBSC-413+
ZBSC-413



Maximum Ratings

Operating Temperature	-55°C to 100°C
Storage Temperature	-55°C to 100°C
Power Input (as a splitter)	1W max.
Internal Dissipation	0.250W max.

Coaxial Connections

SUM PORT	S
PORT 1	1
PORT 2	2
PORT 3	3
PORT 4	4

Features

- wideband, 10 to 800 MHz
- rugged, shielded case

Applications

- VHF/UHF
- receivers/transmitters

Connectors	Model	Price	Qty.
SMA	ZBSC-413(+)	\$99.95	(1-9)

+ RoHS compliant in accordance with EU Directive (2002/95/EC)

The +Suffix identifies RoHS Compliance. See our web site for RoHS Compliance methodologies and qualifications.

Splitter Electrical Specifications

FREQ. RANGE (MHz)	ISOLATION (dB)						INSERTION LOSS (dB) ABOVE 6.0 dB						PHASE UNBALANCE (Degrees)			AMPLITUDE UNBALANCE (dB)		
	L		M		U		L		M		U		L	M	U	L	M	U
	Typ.	Min	Typ.	Min	Typ.	Min	Typ.	Max.	Typ.	Max.	Typ.	Max.	Max.	Max.	Max.	Max.	Max.	Max.
10-800	26	20	18	15	18	15	0.6	1.0	1.0	1.5	1.6	2.0	4	8	8	0.2	0.4	0.6

L = low range [f_L to 10 f_L] M = mid range [$10 f_L$ to $f_U/2$] U = upper range [$f_U/2$ to f_U]

Outline Drawing

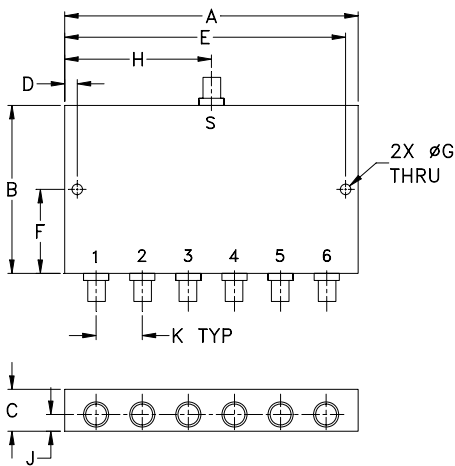

Outline Dimensions (inch/mm)

A	B	C	D	E	F
3.50	2.00	.50	.150	3.350	1.00
88.90	50.80	12.70	3.81	85.09	25.40
G	H	J	K	wt	
.125	1.75	.20	.55	grams	
3.18	44.45	5.08	13.97	120	

Typical Performance Data

Freq. (MHz)	Insertion Loss (dB)				Amp. Unbal. (dB)	Isolation (dB)			Phase Unbal. (deg.)	VSWR S	VSWR 1	VSWR 2	VSWR 3	VSWR 4
	S-1	S-2	S-3	S-4		1-2	1-4	3-4						
10.00	6.35	6.36	6.35	6.34	0.01	35.02	35.64	34.88	0.05	1.07	1.05	1.05	1.05	1.05
50.00	6.39	6.38	6.38	6.39	0.01	33.68	35.96	33.63	0.06	1.07	1.04	1.04	1.04	1.05
100.00	6.42	6.41	6.42	6.42	0.00	31.47	34.89	31.62	0.14	1.11	1.05	1.05	1.05	1.04
140.00	6.47	6.47	6.47	6.47	0.00	29.80	33.64	30.02	0.22	1.12	1.06	1.06	1.06	1.07
200.00	6.54	6.54	6.54	6.55	0.01	27.93	31.98	28.25	0.12	1.17	1.08	1.07	1.07	1.08
300.00	6.67	6.67	6.67	6.66	0.01	26.02	29.66	26.40	0.24	1.22	1.10	1.10	1.10	1.11
400.00	6.70	6.71	6.70	6.71	0.01	25.30	27.90	25.88	0.29	1.24	1.13	1.13	1.13	1.15
450.00	6.70	6.71	6.72	6.71	0.01	25.45	27.31	26.13	0.41	1.24	1.14	1.14	1.14	1.14
500.00	6.72	6.72	6.73	6.73	0.01	25.86	26.70	26.70	0.46	1.24	1.16	1.16	1.16	1.19
550.00	6.84	6.84	6.85	6.84	0.01	26.81	26.31	27.88	0.48	1.25	1.17	1.17	1.17	1.18
600.00	6.82	6.83	6.83	6.83	0.01	28.21	25.97	29.70	0.45	1.24	1.18	1.19	1.18	1.21
650.00	6.88	6.88	6.90	6.90	0.02	30.44	25.73	32.60	0.51	1.24	1.19	1.20	1.20	1.22
700.00	6.94	6.95	6.96	6.96	0.02	33.79	25.57	36.63	0.80	1.23	1.20	1.21	1.21	1.23
750.00	6.97	6.98	7.00	6.99	0.03	36.64	25.63	35.87	0.73	1.24	1.21	1.22	1.22	1.23
800.00	7.08	7.07	7.10	7.10	0.03	33.06	25.63	30.50	0.73	1.22	1.21	1.22	1.22	1.24

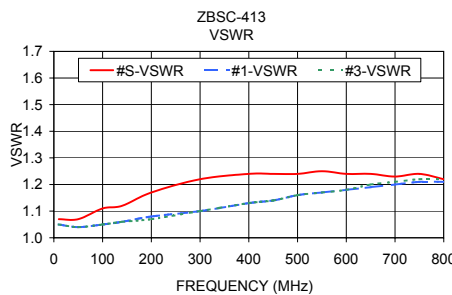
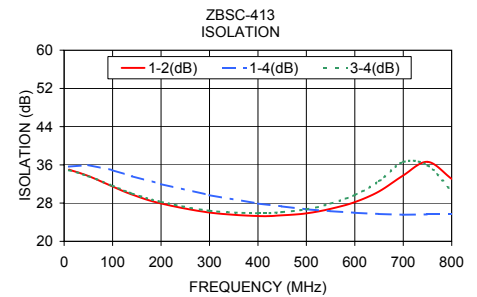
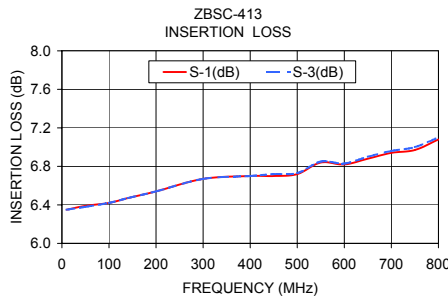

electrical schematic

