

Coaxial

# Voltage Controlled Oscillator

## ZX95-3412C+

Linear Tuning 3312 to 3412 MHz

### Features

- low phase noise
- low pushing
- low pulling
- protected by US patent 6,790,049



CASE STYLE: GB956

### Applications

- r & d
- lab
- instrumentation
- wireless communication
- WiMAX 3.5 GHz

Connectors	Model	Price	Qty.
SMA	ZX95-3412C-S+	\$40.95 ea.	(1-9)

**+RoHS Compliant**  
The +Suffix identifies RoHS Compliance. See our web site for RoHS Compliance methodologies and qualifications

### Electrical Specifications

MODEL NO.	FREQ. (MHz)		POWER OUTPUT (dBm)	PHASE NOISE dBc/Hz SSB at offset frequencies, kHz				TUNING					NON HARMONIC SPURIOUS (dBc)	HARMONICS (dBc)		PULLING pk-pk @ 12 dB (MHz)	PUSHING (MHz/V)	DC OPERATING POWER				
	Min.	Max.		Typ.	1	10	100	1000	VOLTAGE RANGE (V)	SENSITIVITY (MHz/V)	PORT CAP (pF)	3 dB MODULATION BANDWIDTH (MHz)		Typ.	Typ.			Max.	Typ.	Typ.	Vcc (volts)	Current (mA)
ZX95-3412C+	3312	3412	-0.6	-77	-105	-127	-148	0.5	4.5	50-65	14	110	-90	-15	-10	0.8	0.2	5	40			

### Maximum Ratings

Operating Temperature	-55°C to 85°C
Storage Temperature	-55°C to 100°C
Absolute Max. Supply Voltage (Vcc)	7.0V
Absolute Max. Tuning Voltage (Vtune)	6.5V
All specifications	50 ohm system

Permanent damage may occur if any of these limits are exceeded.

### Outline Drawing

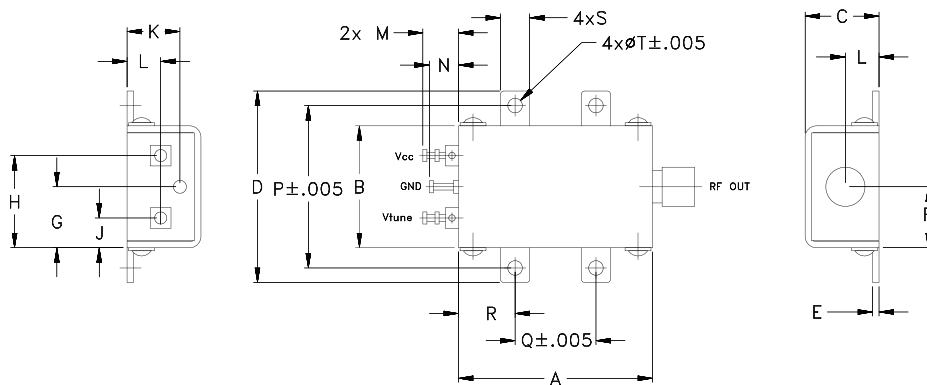

### Outline Dimensions (inch/mm)

A	B	C	D	E	F	G	H	J	K	L	M	N	P	Q	R	S	T	wt.
1.20	.75	.46	1.18	.04	.38	.38	.57	.18	.33	.21	.22	.18	1.00	.50	.35	.18	.106	grams
30.48	19.05	11.68	29.97	1.02	9.65	9.65	14.48	4.57	8.38	5.33	5.59	4.57	25.40	12.70	8.89	4.57	2.69	35.0



For detailed performance specs & shopping online see web site

P.O. Box 350166, Brooklyn, New York 11235-0003 (718) 934-4500 Fax (718) 332-4661 The Design Engineers Search Engine Provides ACTUAL Data Instantly at [minicircuits.com](http://minicircuits.com)

**Notes:** 1. Performance and quality attributes and conditions not expressly stated in this specification sheet are intended to be excluded and do not form a part of this specification sheet. 2. Electrical specifications and performance data contained herein are based on Mini-Circuit's applicable established test performance criteria and measurement instructions. 3. The parts covered by this specification sheet are subject to Mini-Circuits standard limited warranty and terms and conditions (collectively, "Standard Terms"); Purchasers of this part are entitled to the rights and benefits contained therein. For a full statement of the Standard Terms and the exclusive rights and remedies thereunder, please visit Mini-Circuits' website at [www.minicircuits.com/MCLStore/terms.jsp](http://www.minicircuits.com/MCLStore/terms.jsp).

REV. OR  
M118620  
EDR-9123F2  
ZX95-3412C+  
RAV  
120905  
Page 1 of 2

# Performance Data & Curves\*

# ZX95-3412C+

V TUNE	TUNE SENS (MHz/V)	FREQUENCY (MHz)			POWER OUTPUT (dBm)			Icc (mA)	HARMONICS (dBc)			FREQ. PUSH (MHz/V)	FREQ. PULL (MHz)	PHASE NOISE (dBc/Hz) at offsets				FREQ OFFSET (KHz)	PHASE NOISE at 3362 MHz (dBc/Hz)
		-55°C	+25°C	+85°C	-55°C	+25°C	+85°C		F2	F3	F4			1kHz	10kHz	100kHz	1MHz		
0.00	47.79	3229.8	3220.0	3212.7	-0.34	-0.66	-1.14	32.23	-18.6	-16.8	-36.8	0.56	0.37	-77.7	-105.5	-127.7	-147.5	1.0	-77.35
0.25	45.11	3241.4	3231.9	3224.8	-0.34	-0.62	-1.04	32.24	-18.8	-16.7	-35.5	0.42	0.79	-77.6	-105.3	-127.6	-148.3	2.4	-88.12
0.50	43.56	3252.4	3243.2	3236.2	-0.40	-0.62	-0.98	32.25	-18.3	-16.8	-35.7	0.34	1.03	-78.7	-105.6	-127.5	-148.0	4.5	-96.56
0.75	43.59	3263.3	3254.1	3247.1	-0.43	-0.65	-0.98	32.26	-17.4	-17.4	-35.6	0.30	1.03	-78.3	-106.3	-127.9	-147.7	6.9	-101.15
1.00	44.18	3274.2	3265.0	3257.9	-0.47	-0.69	-1.00	32.27	-16.7	-18.6	-35.7	0.27	0.97	-79.0	-105.7	-128.1	-148.5	8.5	-103.47
1.25	45.14	3285.3	3276.0	3268.8	-0.46	-0.74	-1.01	32.27	-16.9	-17.9	-36.6	0.25	0.71	-77.1	-105.7	-128.2	-148.6	10.0	-105.03
1.50	46.47	3296.7	3287.3	3279.9	-0.39	-0.74	-1.04	32.27	-16.8	-17.6	-35.5	0.22	0.57	-78.7	-105.6	-127.3	-148.5	16.2	-110.09
1.75	48.01	3308.4	3298.9	3291.3	-0.28	-0.67	-1.02	32.28	-16.2	-17.8	-36.6	0.19	0.77	-76.7	-105.5	-127.2	-148.3	30.8	-116.33
2.00	49.74	3320.5	3310.9	3303.1	-0.21	-0.57	-0.94	32.28	-15.7	-17.3	-36.5	0.15	0.98	-76.7	-105.1	-127.4	-147.8	56.5	-121.69
2.25	52.10	3333.1	3323.4	3315.3	-0.19	-0.48	-0.84	32.28	-15.5	-17.4	-38.9	0.12	1.09	-77.2	-105.5	-127.7	-148.4	85.2	-125.82
2.50	54.70	3346.3	3336.4	3328.1	-0.16	-0.48	-0.78	32.27	-15.6	-18.3	-40.1	0.08	1.05	-77.7	-105.4	-127.5	-147.4	100.0	-127.32
2.75	57.36	3360.2	3350.1	3341.5	-0.22	-0.48	-0.77	32.27	-15.3	-17.6	-42.4	0.05	0.58	-76.9	-105.2	-127.3	-148.8	159.1	-131.55
3.00	60.27	3374.8	3364.4	3355.5	-0.31	-0.55	-0.79	32.26	-14.5	-18.9	-42.7	0.04	0.58	-78.0	-105.1	-127.9	-148.6	239.8	-135.26
3.25	62.66	3390.1	3379.5	3370.3	-0.37	-0.67	-0.86	32.26	-14.7	-19.0	-44.2	0.08	1.10	-77.8	-104.8	-127.0	-149.0	361.5	-138.09
3.50	64.16	3405.8	3395.1	3385.7	-0.27	-0.72	-0.98	32.26	-15.0	-18.8	-47.3	0.23	1.19	-75.7	-105.1	-127.5	-148.3	440.0	-140.50
3.75	64.72	3421.8	3411.2	3401.7	-0.13	-0.60	-1.00	32.26	-14.2	-18.7	-47.3	0.48	0.88	-74.9	-104.6	-127.1	-148.1	545.0	-142.35
4.00	64.48	3437.9	3427.4	3417.9	-0.08	-0.47	-0.85	32.27	-14.2	-18.6	-49.4	0.88	0.53	-75.7	-104.7	-127.4	-148.4	663.3	-144.39
4.25	64.10	3453.9	3443.5	3434.1	-0.09	-0.45	-0.76	32.26	-14.4	-20.3	-49.0	1.36	1.04	-77.6	-103.7	-127.5	-147.7	821.7	-146.63
4.50	62.03	3469.8	3459.5	3450.0	-0.22	-0.50	-0.82	32.25	-13.3	-19.3	-49.2	1.90	1.07	-75.9	-103.6	-127.2	-147.8	1000.0	-147.96

\*at 25°C unless mentioned otherwise

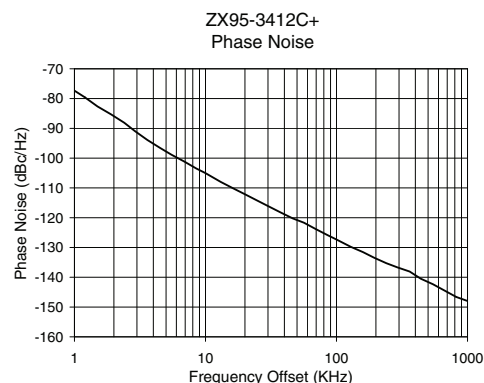
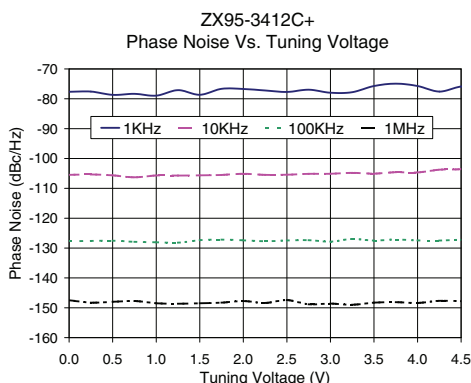
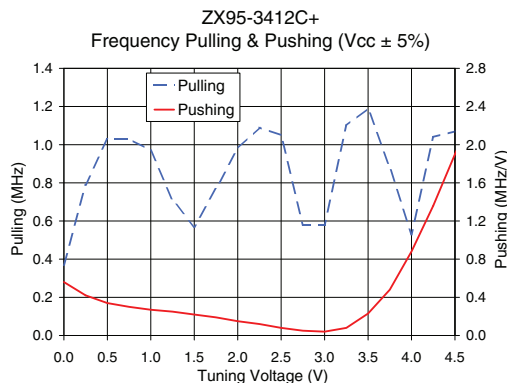
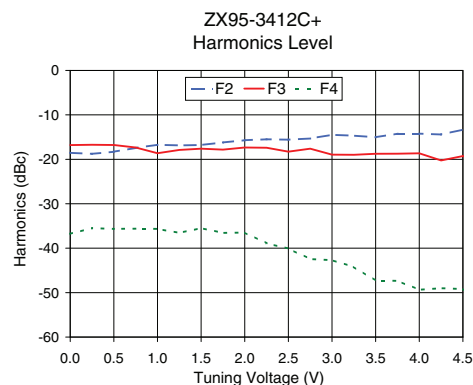
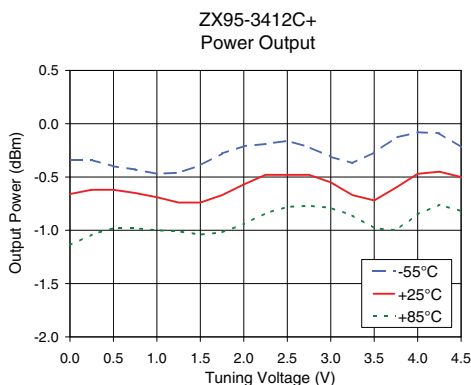
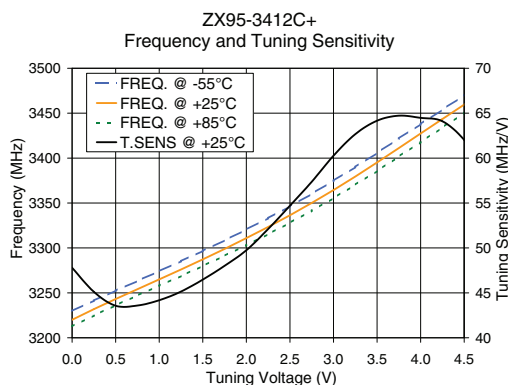

For detailed performance specs & shopping online see web site

P.O. Box 350166, Brooklyn, New York 11235-0003 (718) 934-4500 Fax (718) 332-4661 The Design Engineers Search Engine Provides ACTUAL Data Instantly at [minicircuits.com](http://minicircuits.com)

IF/RF MICROWAVE COMPONENTS

Notes: 1. Performance and quality attributes and conditions not expressly stated in this specification sheet are intended to be excluded and do not form a part of this specification sheet. 2. Electrical specifications and performance data contained herein are based on Mini-Circuit's applicable established test performance criteria and measurement instructions. 3. The parts covered by this specification sheet are subject to Mini-Circuits standard limited warranty and terms and conditions (collectively, "Standard Terms"); Purchasers of this part are entitled to the rights and benefits contained therein. For a full statement of the Standard Terms and the exclusive rights and remedies thereunder, please visit Mini-Circuits' website at [www.minicircuits.com/MCLStore/terms.jsp](http://www.minicircuits.com/MCLStore/terms.jsp).