

Coaxial

# Voltage Controlled Oscillator

## ZX95-3270+

5V Tuning for PL IC's 3150 to 3270 MHz

### Features

- linear tuning characteristics
- low pulling
- protected by US patent 6,790,049

### Applications

- r & d
- lab
- instrumentation
- wireless communications
- wireless microphones



CASE STYLE: GB956

Connectors	Model	Price	Qty.
SMA	ZX95-3270-S+	\$44.95 ea.	(1-9)

**+RoHS Compliant**  
The +Suffix identifies RoHS Compliance. See our web site for RoHS Compliance methodologies and qualifications

### Electrical Specifications

MODEL NO.	FREQ. (MHz)		POWER OUTPUT (dBm)	PHASE NOISE dBc/Hz SSB at offset frequencies, KHz				TUNING					NON HARMONIC SPURIOUS (dBc)	HARMONICS (dBc)		PULLING pk-pk @ 12 dB (MHz)	PUSHING (MHz/V)	DC OPERATING POWER	
	Min.	Max.		Typ.	1	10	100	1000	VOLTAGE RANGE (V)	SENSI-TIVITY (MHz/V)	PORT CAP (pF)	3 dB MODULATION BANDWIDTH (MHz)		Typ.	Typ.			Typ.	Typ.
ZX95-3270+	3150	3270	+2.5	-71	-96	-116	-137	0.5	5	82	10	340	-90	-20	-12	2.5	4.5	5	33

### Maximum Ratings

Operating Temperature	-55°C to 85°C
Storage Temperature	-55°C to 100°C
Absolute Max. Supply Voltage (Vcc)	6.5V
Absolute Max. Tuning Voltage (Vtune)	6.5V
All specifications	50 ohm system

Permanent damage may occur if any of these limits are exceeded.

### Outline Drawing

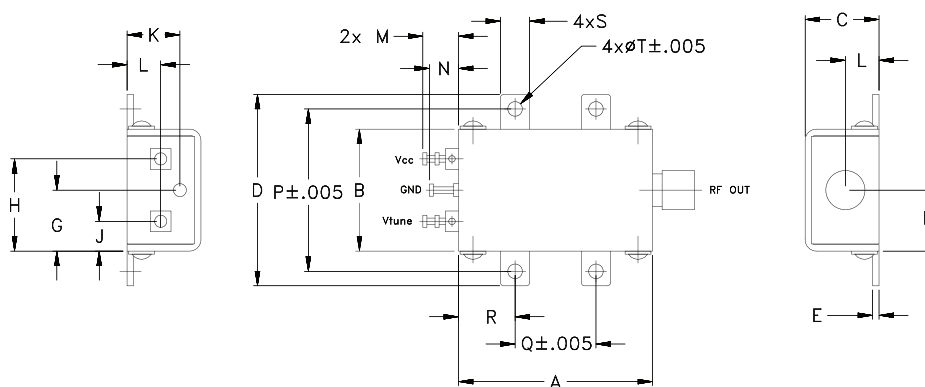

### Outline Dimensions (inch/mm)

A	B	C	D	E	F	G	H	J	K	L	M	N	P	Q	R	S	T	wt.
1.20	.75	.46	1.18	.04	.38	.38	.57	.18	.33	.21	.22	.18	1.00	.50	.35	.18	.106	grams
30.48	19.05	11.68	29.97	1.02	9.65	9.65	14.48	4.57	8.38	5.33	5.59	4.57	25.40	12.70	8.89	4.57	2.69	35.0



For detailed performance specs & shopping online see web site

P.O. Box 350166, Brooklyn, New York 11235-0003 (718) 934-4500 Fax (718) 332-4661 The Design Engineers Search Engine Provides ACTUAL Data Instantly at [minicircuits.com](http://minicircuits.com)

**Notes:** 1. Performance and quality attributes and conditions not expressly stated in this specification sheet are intended to be excluded and do not form a part of this specification sheet. 2. Electrical specifications and performance data contained herein are based on Mini-Circuit's applicable established test performance criteria and measurement instructions. 3. The parts covered by this specification sheet are subject to Mini-Circuits standard limited warranty and terms and conditions (collectively, "Standard Terms"); Purchasers of this part are entitled to the rights and benefits contained therein. For a full statement of the Standard Terms and the exclusive rights and remedies thereunder, please visit Mini-Circuits' website at [www.minicircuits.com/MCLStore/terms.jsp](http://www.minicircuits.com/MCLStore/terms.jsp).

REV. OR  
M108877  
EDR-7748  
ZX95-3270+  
RAV  
120905  
Page 1 of 2

# Performance Data & Curves\*

# ZX95-3270+

V TUNE	TUNE SENS (MHz/V)	FREQUENCY (MHz)			POWER OUTPUT (dBm)			Icc (mA)	HARMONICS (dBc)			FREQ. PUSH (MHz/V)	FREQ. PULL (MHz)	PHASE NOISE (dBc/Hz) at offsets				FREQ OFFSET (KHz)	PHASE NOISE at 3210 MHz (dBc/Hz)
		-55°C	+25°C	+85°C	-55°C	+25°C	+85°C		F2	F3	F4			1kHz	10kHz	100kHz	1MHz		
0.00	116.26	3007.7	2991.0	2973.1	1.86	2.22	2.17	27.57	-25.3	-37.7	-55.2	4.15	2.02	-71.6	-94.6	-114.6	-134.7	1.0	-69.15
0.50	97.02	3060.0	3045.4	3029.8	2.07	2.35	2.20	27.60	-24.9	-40.5	-53.8	4.29	1.49	-70.9	-94.8	-115.6	-135.6	2.0	-79.06
0.75	93.86	3084.3	3069.7	3054.0	2.08	2.38	2.27	27.60	-23.1	-39.0	-53.2	4.46	2.45	-73.7	-94.5	-115.7	-135.7	3.5	-85.41
1.00	87.33	3106.8	3093.1	3077.5	2.12	2.41	2.26	27.62	-23.0	-39.4	-52.8	4.37	2.21	-70.6	-94.8	-115.7	-135.8	6.0	-90.93
1.25	87.56	3128.9	3115.0	3100.2	2.13	2.46	2.28	27.63	-21.7	-37.4	-53.0	4.36	1.76	-71.4	-96.0	-116.4	-136.6	8.5	-93.71
1.50	86.43	3150.6	3136.9	3121.8	2.19	2.46	2.33	27.63	-20.7	-35.4	-51.8	4.49	2.11	-71.8	-95.3	-116.4	-136.5	10.0	-95.09
1.75	82.97	3171.7	3158.5	3143.3	2.32	2.51	2.34	27.65	-20.9	-35.7	-52.7	4.56	2.11	-70.6	-95.4	-116.1	-136.5	20.8	-102.98
2.00	83.23	3192.7	3179.2	3164.6	2.34	2.64	2.39	27.69	-20.2	-36.5	-53.9	4.47	2.36	-70.4	-95.7	-116.1	-136.4	35.5	-107.78
2.25	82.69	3213.4	3200.0	3185.3	2.39	2.63	2.47	27.71	-19.5	-36.8	-58.5	4.48	1.45	-68.9	-95.6	-116.3	-136.7	60.7	-111.27
2.50	81.52	3233.6	3220.7	3206.1	2.42	2.64	2.49	27.74	-19.4	-39.6	-60.9	4.41	1.41	-72.5	-95.8	-116.6	-136.8	86.7	-115.34
2.75	82.56	3254.1	3241.1	3226.7	2.42	2.68	2.50	27.75	-20.4	-41.8	-63.2	4.41	2.19	-70.3	-95.6	-116.6	-136.8	100.0	-116.40
3.00	82.60	3274.7	3261.7	3247.3	2.41	2.70	2.51	27.77	-19.5	-41.1	-60.2	4.39	1.99	-71.8	-95.9	-116.9	-136.9	148.1	-120.15
3.25	83.20	3295.2	3282.4	3268.1	2.37	2.68	2.54	27.79	-19.1	-43.0	-58.7	4.31	0.90	-71.2	-96.2	-116.9	-137.0	253.0	-124.34
3.50	83.68	3316.0	3303.2	3288.8	2.28	2.61	2.51	27.81	-20.1	-45.6	-59.5	4.39	1.73	-69.2	-95.7	-117.0	-136.8	361.5	-127.73
3.75	83.10	3336.9	3324.1	3309.6	2.37	2.61	2.44	27.83	-19.3	-44.5	-57.1	4.39	2.13	-69.6	-96.0	-117.4	-137.4	432.2	-129.39
4.00	84.03	3357.7	3344.9	3330.6	2.40	2.68	2.45	27.86	-19.5	-45.7	-54.3	4.28	1.54	-68.5	-95.9	-117.2	-137.2	507.5	-130.63
4.25	84.26	3378.9	3365.9	3351.4	2.31	2.65	2.56	27.88	-20.1	-46.6	-52.9	4.37	0.76	-70.4	-95.9	-117.4	-137.5	606.7	-132.22
4.50	83.55	3399.8	3386.9	3372.4	2.32	2.61	2.52	27.91	-20.1	-45.9	-51.5	4.28	1.93	-69.9	-96.1	-117.3	-137.4	712.4	-133.63
4.75	82.59	3420.5	3407.8	3393.4	2.37	2.64	2.46	27.95	-19.1	-47.2	-50.4	4.18	1.95	-71.4	-95.8	-117.3	-137.5	851.6	-135.39
5.00	83.24	3441.6	3428.5	3414.1	2.30	2.66	2.53	27.97	-19.4	-48.7	-50.1	4.16	1.48	-71.1	-96.3	-117.5	-137.6	1000.0	-136.66

\*at 25°C unless mentioned otherwise

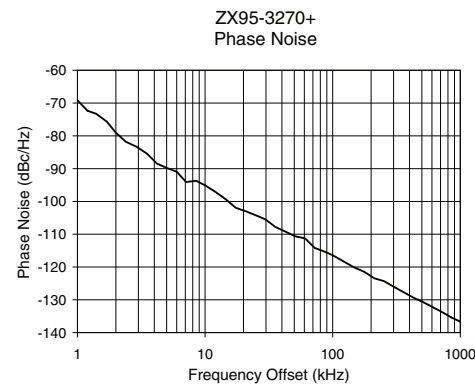
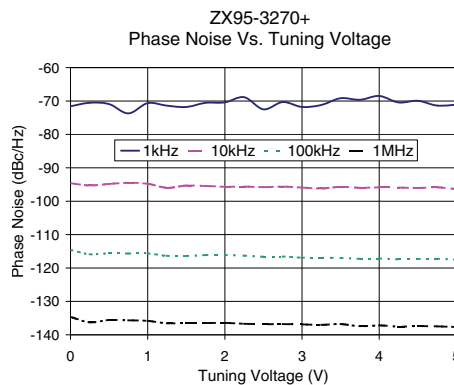
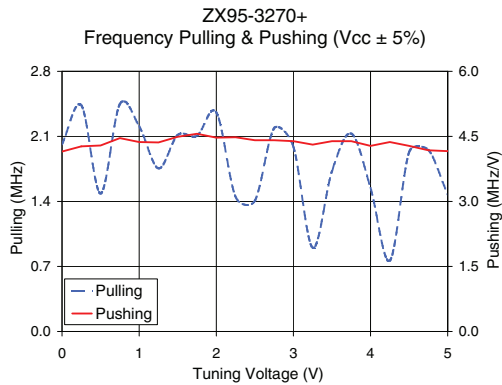
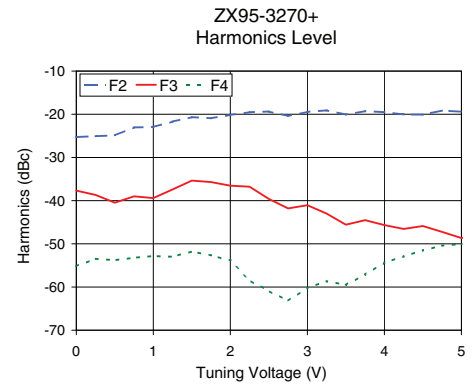
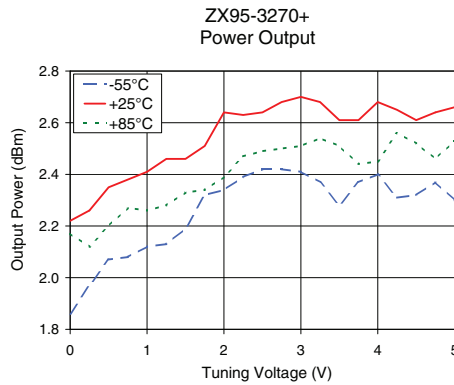
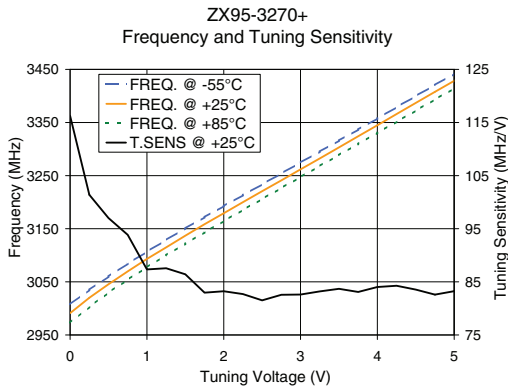

For detailed performance specs & shopping online see web site

P.O. Box 350166, Brooklyn, New York 11235-0003 (718) 934-4500 Fax (718) 332-4661 The Design Engineers Search Engine Provides ACTUAL Data Instantly at [minicircuits.com](http://minicircuits.com)

Notes: 1. Performance and quality attributes and conditions not expressly stated in this specification sheet are intended to be excluded and do not form a part of this specification sheet. 2. Electrical specifications and performance data contained herein are based on Mini-Circuit's applicable established test performance criteria and measurement instructions. 3. The parts covered by this specification sheet are subject to Mini-Circuits standard limited warranty and terms and conditions (collectively, "Standard Terms"); Purchasers of this part are entitled to the rights and benefits contained therein. For a full statement of the Standard Terms and the exclusive rights and remedies thereunder, please visit Mini-Circuits' website at [www.minicircuits.com/MCLStore/terms.jsp](http://www.minicircuits.com/MCLStore/terms.jsp).