

Coaxial

# Voltage Controlled Oscillator

## ZX95-2710C+

Low Noise 2670 to 2700 MHz

### Features

- linear tuning characteristics
- low phase noise
- low pushing
- low pulling
- protected by US patent 6,790,049

### Applications

- r & d
- lab
- instrumentation
- wireless communication
- point-to-point



CASE STYLE: GB956

Connectors	Model	Price	Qty.
SMA	ZX95-2710C-S+	\$50.95 ea.	(1-9)

**+RoHS Compliant**  
The +Suffix identifies RoHS Compliance. See our web site for RoHS Compliance methodologies and qualifications

### Electrical Specifications

MODEL NO.	FREQ. (MHz)		POWER OUTPUT (dBm)	PHASE NOISE dBc/Hz SSB at offset frequencies, kHz				TUNING					NON HARMONIC SPURIOUS (dBc)	HARMONICS (dBc)		PULLING pk-pk @12 dB (MHz)	PUSHING (MHz/V)	DC OPERATING POWER	
	Min.	Max.		Typ.	1	10	100	1000	VOLTAGE RANGE (V)	SENSITIVITY (MHz/V)	PORT CAP (pF)	3 dB MODULATION BANDWIDTH (MHz)		Typ.	Max.			Typ.	Max.
ZX95-2710C+	2670	2700	+3.5	-83	-110	-131	-150	0.5	5.5	16	18	100	-90	-14	-	0.3	0.4	5	35

### Maximum Ratings

Operating Temperature	-55°C to 85°C
Storage Temperature	-55°C to 100°C
Absolute Max. Supply Voltage (Vcc)	6V
Absolute Max. Tuning Voltage (Vtune)	7V
All specifications	50 ohm system

Permanent damage may occur if any of these limits are exceeded.

### Outline Drawing

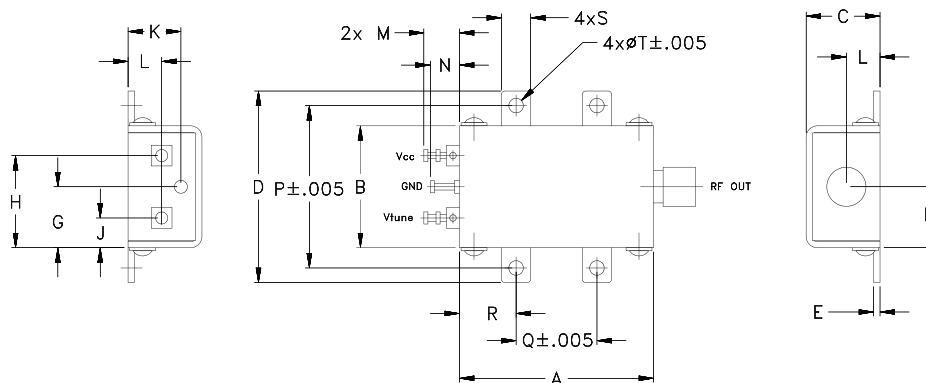

### Outline Dimensions (inch/mm)

A	B	C	D	E	F	G	H	J	K	L	M	N	P	Q	R	S	T	wt.
1.20	.75	.46	1.18	.04	.38	.38	.57	.18	.33	.21	.22	.18	1.00	.50	.35	.18	.106	grams
30.48	19.05	11.68	29.97	1.02	9.65	9.65	14.48	4.57	8.38	5.33	5.59	4.57	25.40	12.70	8.89	4.57	2.69	35.0



For detailed performance specs & shopping online see web site

P.O. Box 350166, Brooklyn, New York 11235-0003 (718) 934-4500 Fax (718) 332-4661 The Design Engineers Search Engine Provides ACTUAL Data Instantly at [minicircuits.com](http://minicircuits.com)

Notes: 1. Performance and quality attributes and conditions not expressly stated in this specification sheet are intended to be excluded and do not form a part of this specification sheet. 2. Electrical specifications and performance data contained herein are based on Mini-Circuit's applicable established test performance criteria and measurement instructions. 3. The parts covered by this specification sheet are subject to Mini-Circuits standard limited warranty and terms and conditions (collectively, "Standard Terms"); Purchasers of this part are entitled to the rights and benefits contained therein. For a full statement of the Standard Terms and the exclusive rights and remedies thereunder, please visit Mini-Circuits' website at [www.minicircuits.com/MCLStore/terms.jsp](http://www.minicircuits.com/MCLStore/terms.jsp).

# Performance Data & Curves\*

# ZX95-2710C+

V TUNE	TUNE SENS (MHz/V)	FREQUENCY (MHz)			POWER OUTPUT (dBm)			Icc (mA)	HARMONICS (dBc)			FREQ. PUSH (MHz/V)	FREQ. PULL (MHz)	PHASE NOISE (dBc/Hz) at offsets				FREQ OFFSET (KHz)	PHASE NOISE at 2685 MHz (dBc/Hz)
		-55°C	+25°C	+85°C	-55°C	+25°C	+85°C		F2	F3	F4			1KHz	10KHz	100KHz	1MHz		
0.00	21.87	2651.8	2644.5	2638.8	2.99	3.19	3.28	21.79	-15.0	-33.6	-29.0	0.23	0.47	-84.4	-109.9	-130.9	-150.9	1.0	-84.63
0.25	19.75	2656.9	2649.9	2644.6	3.07	3.33	3.41	21.84	-14.9	-33.5	-29.3	0.28	0.41	-84.6	-110.2	-131.5	-150.7	2.1	-92.82
0.50	18.43	2661.6	2654.9	2649.7	3.13	3.40	3.54	21.87	-14.8	-33.6	-29.0	0.30	0.33	-83.2	-110.1	-131.5	-149.5	4.2	-101.22
1.00	16.97	2670.4	2663.9	2658.8	3.25	3.53	3.65	21.93	-14.9	-33.6	-28.2	0.33	0.16	-83.4	-110.5	-131.6	-150.0	6.1	-104.77
1.25	16.55	2674.6	2668.1	2663.1	3.30	3.58	3.71	21.95	-15.0	-33.5	-28.4	0.33	0.09	-83.9	-110.5	-131.3	-150.7	8.7	-108.07
1.50	16.24	2678.6	2672.2	2667.2	3.33	3.64	3.77	21.97	-15.1	-33.4	-28.5	0.34	0.01	-84.4	-109.9	-132.1	-150.6	10.0	-109.77
1.75	16.02	2682.7	2676.3	2671.3	3.37	3.68	3.82	21.98	-15.1	-33.4	-28.4	0.34	0.06	-82.5	-109.9	-131.1	-149.7	25.2	-118.79
2.00	15.88	2686.7	2680.3	2675.3	3.40	3.71	3.85	21.99	-15.1	-33.5	-28.3	0.35	0.12	-83.6	-110.2	-130.9	-150.2	43.1	-123.64
2.25	15.83	2690.6	2684.3	2679.3	3.44	3.74	3.88	22.00	-15.1	-33.7	-28.5	0.35	0.18	-84.1	-110.0	-131.1	-150.3	61.6	-126.71
2.50	15.79	2694.6	2688.2	2683.2	3.47	3.77	3.90	22.00	-15.1	-33.5	-28.6	0.35	0.23	-84.3	-110.1	-131.0	-150.0	88.0	-130.18
2.75	15.77	2698.5	2692.2	2687.1	3.50	3.80	3.93	22.00	-15.2	-33.6	-28.6	0.36	0.27	-83.7	-109.8	-130.9	-150.6	100.0	-131.15
3.00	15.81	2702.4	2696.1	2691.0	3.55	3.83	3.95	22.00	-15.3	-33.6	-28.8	0.36	0.31	-82.8	-109.5	-131.3	-149.1	150.3	-134.28
3.25	15.87	2706.4	2700.1	2695.0	3.60	3.85	3.98	22.01	-15.5	-34.0	-29.2	0.36	0.34	-82.7	-109.3	-131.1	-149.9	214.7	-137.27
3.50	15.94	2710.4	2704.0	2698.9	3.64	3.90	4.00	22.00	-15.6	-34.3	-29.5	0.37	0.36	-83.0	-109.3	-131.3	-149.9	306.7	-139.56
3.75	16.03	2714.4	2708.0	2702.8	3.67	3.94	4.04	21.99	-15.7	-34.4	-29.8	0.37	0.37	-82.9	-109.3	-131.1	-149.6	430.5	-142.48
4.00	16.16	2718.4	2712.0	2706.8	3.69	3.98	4.07	21.99	-15.8	-34.3	-30.0	0.37	0.37	-83.4	-109.5	-130.4	-150.1	505.5	-144.15
4.25	16.27	2722.5	2716.1	2710.8	3.69	4.01	4.10	21.98	-15.9	-34.3	-29.9	0.38	0.37	-83.8	-109.0	-130.9	-149.9	604.2	-146.11
4.50	16.41	2726.6	2720.1	2714.8	3.69	4.02	4.12	21.96	-16.0	-34.3	-30.0	0.38	0.35	-82.3	-108.8	-130.8	-150.1	709.5	-147.23
5.00	16.81	2734.9	2728.4	2723.0	3.69	4.02	4.12	21.92	-16.1	-34.0	-30.6	0.39	0.30	-82.4	-108.9	-130.6	-150.4	995.8	-150.12
5.50	17.15	2743.4	2736.8	2731.3	3.63	4.00	4.11	21.88	-16.3	-33.7	-30.5	0.40	0.22	-82.6	-108.7	-130.3	-150.8	1000.0	-150.14

\*at 25°C unless mentioned otherwise

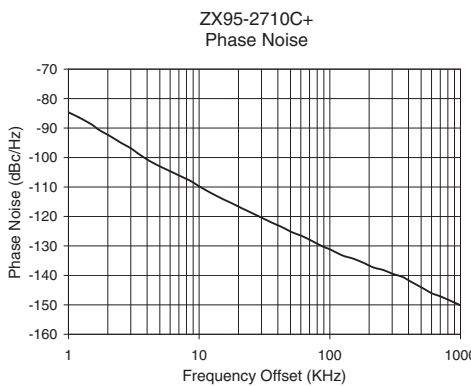
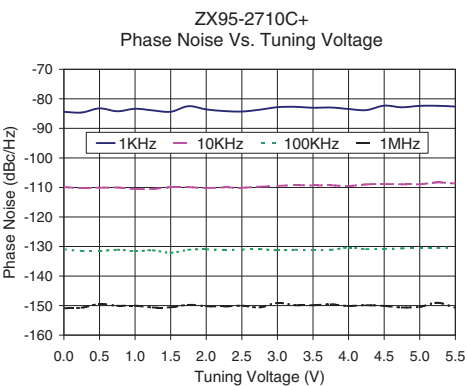
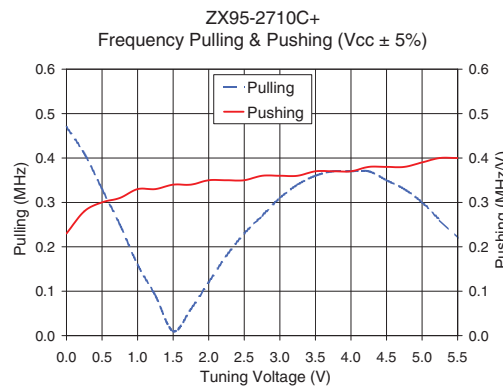
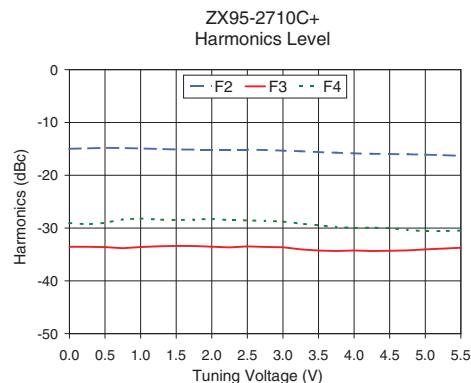
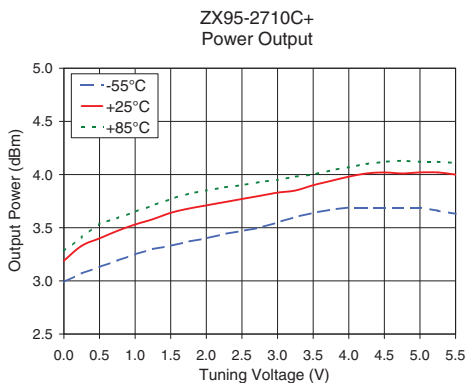
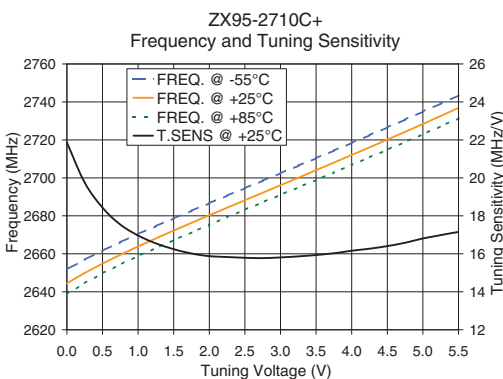

For detailed performance specs & shopping online see web site

P.O. Box 350166, Brooklyn, New York 11235-0003 (718) 934-4500 Fax (718) 332-4661 The Design Engineers Search Engine Provides ACTUAL Data Instantly at [minicircuits.com](http://minicircuits.com)

IF/RF MICROWAVE COMPONENTS

Notes: 1. Performance and quality attributes and conditions not expressly stated in this specification sheet are intended to be excluded and do not form a part of this specification sheet. 2. Electrical specifications and performance data contained herein are based on Mini-Circuit's applicable established test performance criteria and measurement instructions. 3. The parts covered by this specification sheet are subject to Mini-Circuits standard limited warranty and terms and conditions (collectively, "Standard Terms"); Purchasers of this part are entitled to the rights and benefits contained therein. For a full statement of the Standard Terms and the exclusive rights and remedies thereunder, please visit Mini-Circuits' website at [www.minicircuits.com/MCLStore/terms.jsp](http://www.minicircuits.com/MCLStore/terms.jsp).