



DEFINITY™ G80

BENEFITS

- Dimmable to 5% of light on most dimmers.²
- 8 Watts – up to 84% more efficient than comparable 50 Watt Incandescent lamp.
- Maintenance free operation, lasts up to 20 times longer than conventional lighting.
- RoHS compliant – contains no mercury or lead.

FEATURES¹

Equivalent Source	
Standard	Up to 50W Incandescent
L70 lumen depreciation design criteria =	50,000 hours
Housing	Aluminum
Socket	E27 (Europe)
Operating Temperature	-20° C to +40° C
MOL	118.88mm
Voltage	230 VAC
Weight	150g
Power Factor	≥.70

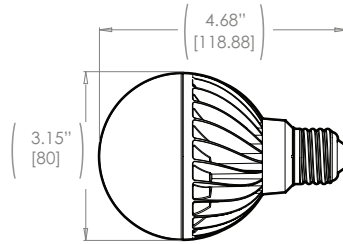

Specifications supplied are nominal. Please refer to the DOE's Lighting Facts Tolerance Guidelines.
¹ Values are nominal, advances from further innovation, specifications are subject to change.
² See dimmer compatibility chart page on next page.

ORDERING INFORMATION \ \ DFN 25 WW 230

Family	Product	Color (CCT)	Voltage
DFN Definity	25 G80	W27 Warm White 2700K	230 220 - 240 Volt - 50 - 60Hz
		WW Warm White 3000K	
		NW Neutral White 4000K	
		CW Cool White 5000K	

CERTIFICATIONS EUROPE



ENVIRONMENT



DIMMER CAPABILITIES

Base BL112-WIT; BaseLine Inbouw BL112, Opbouw BL115; Busch 2250U, 2200, 2247U; Clipsal 32E450UDM, 32E450LM, 32E450TM, 32V 500 Series; HPM 400L; Jung 244EX; Kopp Rome 23278; Niko 310-01701, 310-01401; Lichtregler T43; Praxis Halo

G80¹

Part Number	Base Type	Watts	Lumens	Voltage	Efficacy	CRI	LIFE
DFN 25 NW 230	E27	8W	475	230	59	85	50,000
DFN 25 WW 230	E27	8W	450	230	56	85	50,000
DFN 25 W27 230	E27	8W	410	230	51	85	50,000
DFN 25 CW 230	E27	8W	575	230	72	67	50,000

NW: Neutral White WW: Warm White W27: Warm White 2700K CW: Cool White

Specifications supplied are nominal. Please refer to the DOE's Lighting Facts Tolerance Guidelines.

¹ Values are nominal, advances from further innovation, specifications are subject to change.

Cautions

- Turn power off before inspection, installation, or removal.
- Risk of Electric Shock – Do not use where directly exposed to water or weather.
- Suitable for indoor-dry and damp locations only.
- Not for use in completely enclosed recessed fixtures.
- Do not open – no user serviceable parts inside.
- Use on 220-240, 50 - 60Hz.
- This device is not intended for use with emergency exit fixtures or emergency exit lights.
- Added weight of the device may cause instability of a freestanding portable luminaire.
- This device complies with Part 15 of the FCC rules and has been tested and found to comply with the limits for a Class B digital device. These limits are designed to provide reasonable protection against harmful interference in a residential installation. This equipment generates, uses and can radiate radio frequency energy and, if not installed and used in accordance with the instructions, may cause harmful interference to radio communications. Any changes or modifications not expressly approved by the manufacturer could void the user's authority to operate the equipment.
- For compatible dimmers, see www.LSGC.com/Library



Specifications are typical values and may change without notification.
Copyright © Lighting Science Group Corporation 2011 All rights reserved.

DFN G80_5011_world

Europe:

Klarinetweg 28 | 4337 RA Middelburg | The Netherlands
+31 113 272020 | customerServiceEU@lsgc.com

Asia / Asia Pacific:

+61 (0)2 98998777 | www.lsgc.com
3/9 Hoyle Ave. | Castle Hill, NSW 2154 | Australia

India:

+91-120-4660330
C-33, Phase - II Noida, Uttar Pradesh, India. Pin: 201 305