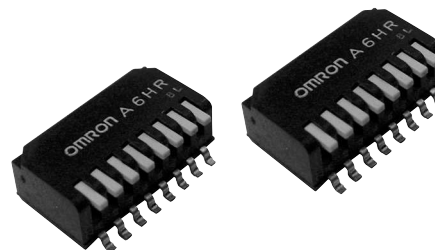

Half-pitch Piano DIP Switch A6HR

Piano type models available in Half-pitch.

- Gold-plated twin contacts will ensure high reliability.
- Embossed tapping models available for automatic mounting. (small reel also available)
- Temperature-resistant resin allows at peak reflow temperatures of 260°C.

NEW

Ordering Information

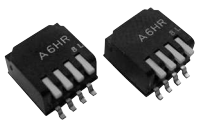
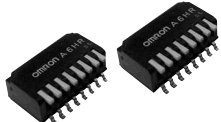
	Part Number			
	Tube Packaging		Embossed tapping packaging	
				
Number of poles		Quantity per Tube		Quantity per reel
2	A6HR-2104	125	A6HR-2104-P	1,000
4	A6HR-4104	70	A6HR-4104-P	
6	A6HR-6104	50	A6HR-6104-P	
8	A6HR-8104	40	A6HR-8104-P	
10	A6HR-0104	30	A6HR-0104-P	

Note: 1. Small reels of 500 pieces are also available. Order "-PM" version instead of "-P".
2. Switches cannot be washed.

Specifications

■ Characteristics

Switching Capacity		25 mA at 24 VDC
Minimum permissible load		10 μ A (minimum current) at 3.5 VDC
Contact resistance		200 m Ω max. (initial value)
Insulation resistance		100 M Ω min. (at 100 VDC)
Dielectric strength		300 VAC for 1 min between terminals
Operating force		29.5 to 500 gf (0.29 to 4.9 N)
Vibration resistance	Malfunction durability	10 to 55 Hz, 1.5-mm double amplitude
Shock resistance	Malfunction durability	490 m/s ² min.
Service life	Electrical	1,000 operations min.
Ambient operating temperature		-30 to 85°C at 60% RH max. (with no icing or condensation)
Ambient operating humidity		35% to 95% (at 5 to 35°C)
Weight		0.13g (2 poles), 0.22g (4 poles), 0.3g (6 poles), 0.4g (8 poles), 0.48g (10 poles)

Note: Data shown are of initial value.

Dimensions

- Note:** 1. All units are in millimeters unless otherwise indicated.
2. Unless otherwise specified, a tolerance of ± 0.4 mm applies to all dimensions.

■ **Standard**
A6HR-□104

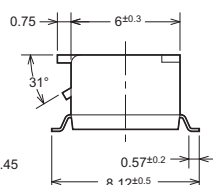
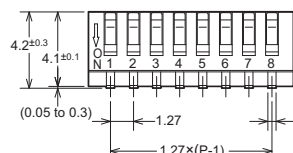
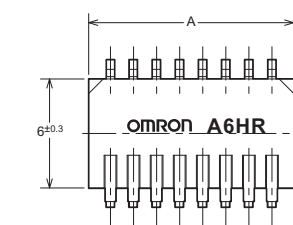

Dimensions of PCB pad (Top View)

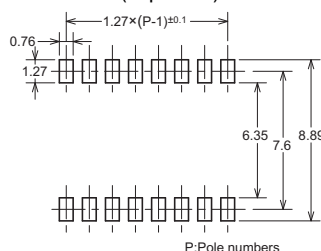

No. of poles	Models	Dimension A
2	A6HR-2104	3.67
4	A6HR-4104	6.21
6	A6HR-6104	8.75
8	A6HF-8102	11.29
10	A6HR-0104	13.83

Internal Connections (Top View)



Precautions

■ Correct Use

Soldering

- Set the Switch to OFF before soldering.
- Observe the following conditions for reflow soldering.
(Measurement location: Top of Switch)

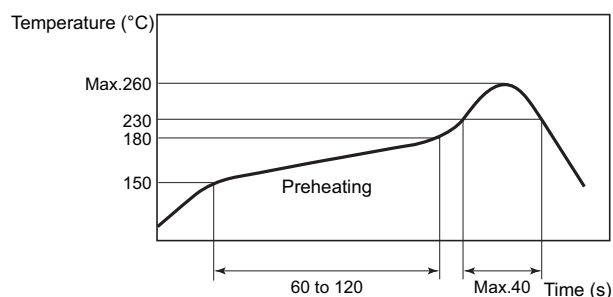

- Do not manually solder the switches.
- Subject the switches to a reflow solder process only once.

Washing

A6HR switches are non-washable models.

Packing Specifications

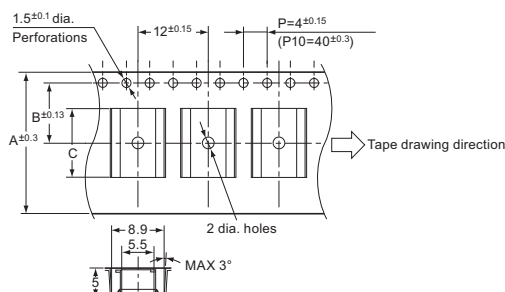

No. of poles	2	4	6	8	10
Dimension					
A \pm 0.3	16	16	16	24	24
B \pm 0.13	7.5	7.5	7.5	11.5	11.5
C	(4.45)	(7.0)	(9.55)	(12.1)	(14.6)

Environment for Storage and Use

To prevent discoloration of the terminals and other problems during storage, do not store the A6HR in locations subject to the following conditions.

High temperatures or humidity/Corrosive gases
Direct sunlight/Contact with water

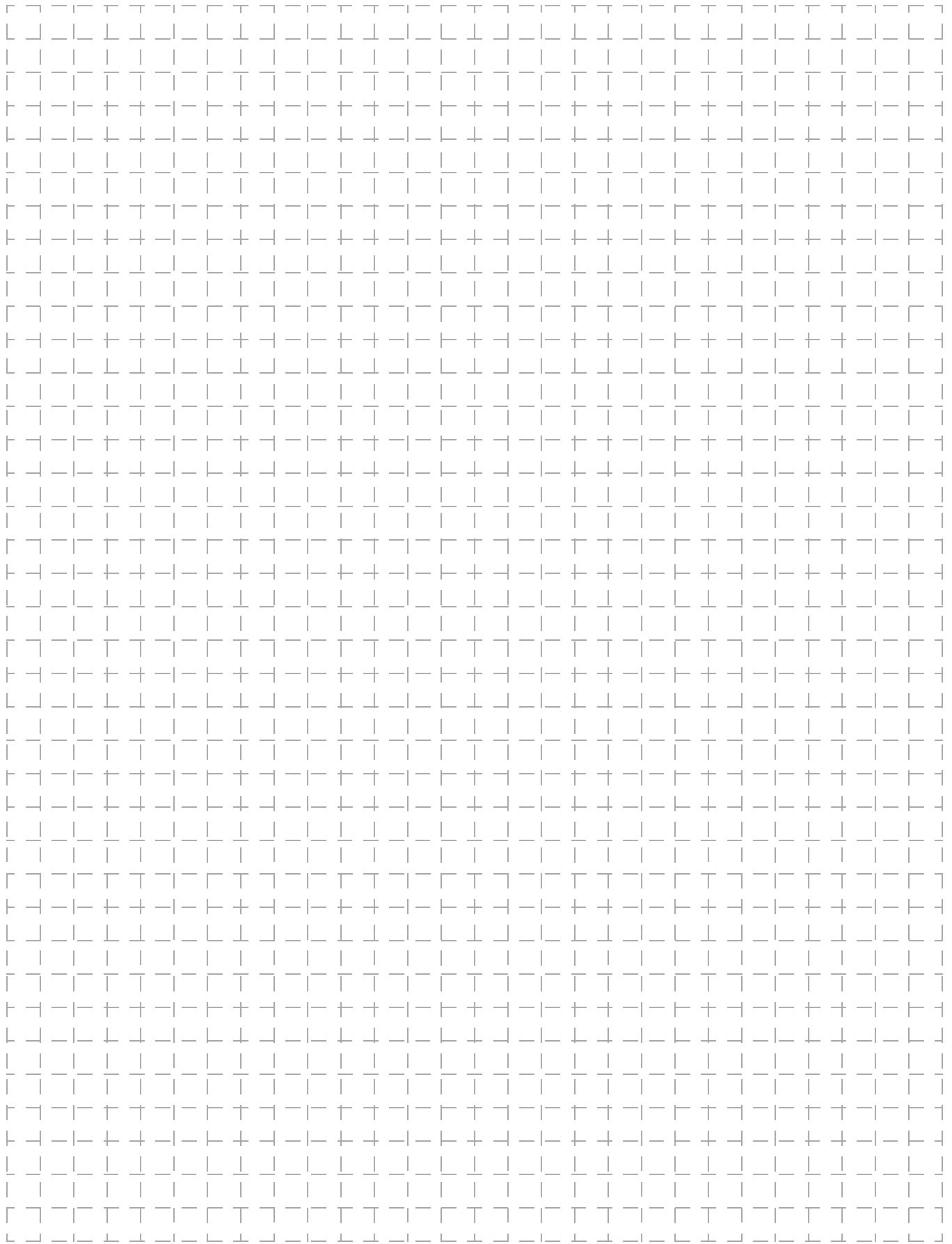

All sales are subject to Omron Electronic Components LLC standard terms and conditions of sale, which can be found at http://www.components.omron.com/components/web/webfiles.nsf/sales_terms.html

ALL DIMENSIONS SHOWN ARE IN MILLIMETERS.

To convert millimeters into inches, multiply by 0.03937. To convert grams into ounces, multiply by 0.03527.

OMRON[®]

**OMRON ELECTRONIC
COMPONENTS LLC**

55 E. Commerce Drive, Suite B
Schaumburg, IL 60173

847-882-2288

OMRON ON-LINE

Global - <http://www.omron.com>

USA - <http://www.components.omron.com>

Cat. No. A191-E-1

11/10

Specifications subject to change without notice

Printed in USA