

Make the Right Connection with Adaptec 6Gb/s SAS HD Cables

Adaptec® by PMC Series 7/7Q/7H/7He RAID adapters are the industry's first adapters with mini SAS HD connectors. These physically smaller connectors allow for 24 native ports in an MD2-Low Profile form factor. With mini SAS HD connectors, one adapter can fully accommodate the maximum 2.5-inch bays in a 2U chassis. Our first-to-market right-angle connectors provide installation ease and flexibility. The 6Gb/s SAS HD cables can also be used with Adaptec's 12Gb/s Series 8 adapters (products will retain 6Gb/s speed). Adaptec delivers big innovation in a small package.



ACK-I-HDmSAS-mSAS-1M & .5M



The Adaptec I-HDmSAS-mSAS-1M and .5M are internal mini SAS HD x4 (SFF-8643) to mini SAS (SFF-8087) x 4 cables. They measure 1 or .5 meters and are used for connecting a Series 7/7Q/7H/7He adapter to a SAS/SATA backplane with mini SAS HD connectors.

- Part Number: 2279700-R | Dimension: 1 Meter
- Part Number: 2281200-R | Dimension: 0.5 Meter

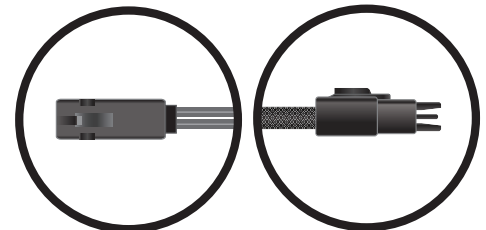

ADAPTER
END

DEVICE/
BACKPLANE
END

ACK-I-rA-HDmSAS-mSAS-.8M & .5M



The Adaptec I-rA-HDmSAS-mSAS-.8M and .5M are internal right-angle mini SAS HD x4 (SFF-8643) to mini SAS (SFF-8087) x4 cables. They measure .8 or .5 meters and are used for connecting a Series 7/7Q/7H/7He adapter to a SAS/SATA backplane with mini SAS HD connectors.

- Part Number: 2280200-R | Dimension: 0.8 Meter
- Part Number: 2281300-R | Dimension: 0.5 Meter

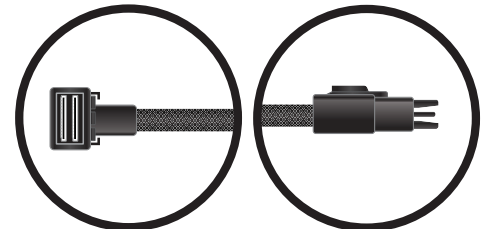

ADAPTER
END

DEVICE/
BACKPLANE
END

ACK-I-HDmSAS-4SATA-SB-.8M



The Adaptec I-HDmSAS-4SATA-SB-.8M is an internal mini SAS HD x4 (SFF-8643) to (4) x1 Serial ATA (adapter based) fan-out cable with sideband signals. It measures .8 meters and is used for connecting a Series 7/7Q/7H/7He adapter to SATA disks, or a SAS/SATA backplane.

- Part Number: 2279800-R
- Dimension: 0.8 Meter

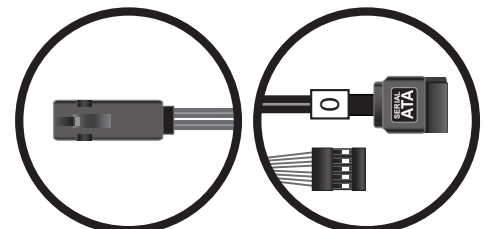

ADAPTER
END

DEVICE/
BACKPLANE
END

ACK-I-rA-HDmSAS-4SATA-SB-.8M



The Adaptec I-rA-HDmSAS-4SATA-SB-.8M is an internal right-angle mini SAS HD x4 (SFF-8643) to (4) x1 Serial ATA (adapter based) fan-out cable with sideband signals. It measures .8 meters and is used for connecting a Series 7/7Q/7H/7He adapter to SATA disks, or a SAS/SATA backplane.

- Part Number: 2280000-R
- Dimension: 0.8 Meter

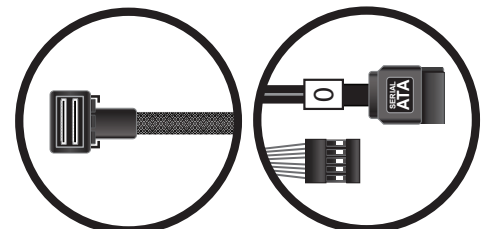

ADAPTER
END

DEVICE/
BACKPLANE
END

Adaptec 6Gb/s SAS HD Cables for Series 7/7Q/7H/7He Adapters



ACK-I-rA-HDmSAS-4rASATA-SB-.8M

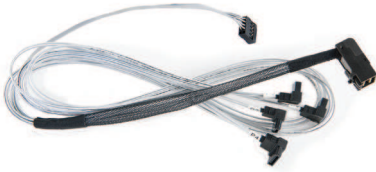

The Adaptec I-rA-HDmSAS-4rASATA-SB-.8M is an internal right-angle mini SAS HD x4 (SFF-8643) to right-angle (4) x1 Serial ATA fan-out cable with sideband signals. It measures .8 meters and is used for connecting a Series 7/7Q/7H/7He adapter to SATA disks, or a SAS/SATA backplane.

- Part Number: 2279900-R
- Dimension: 0.8 Meter

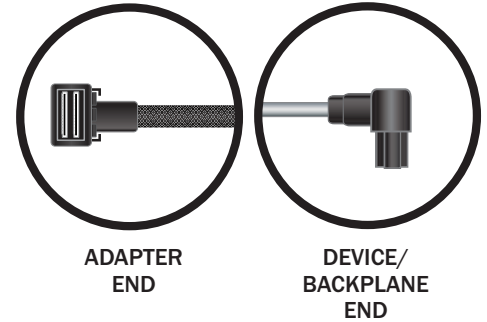

ACK-I-HDmSAS-4SAS-SB-.8M

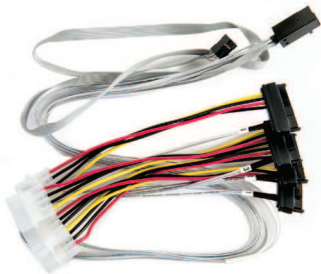

The Adaptec I-HDmSAS-4SAS-SB-.8M is an internal mini SAS HD x4 (SFF-8643) to (4) x1 Serial Attached SCSI (SFF-8482 adapter based) fan-out cable with sideband signals. It measures .8 meters and is used for connecting a Series 7/7Q/7H/7He adapter to SAS disks.

- Part Number: 2280100-R
- Dimension: 0.8 Meter

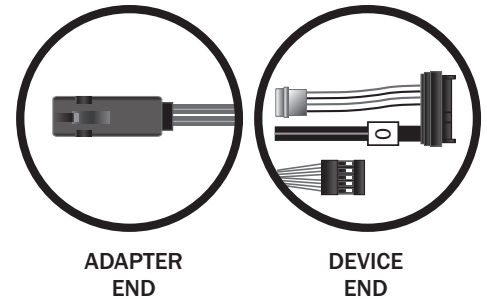

ACK-I-rA-HDmSAS-4SAS-SB-.8M



The Adaptec I-rA-HDmSAS-4SAS-SB-.8M is an internal right-angle mini SAS HD x4 (SFF-8643) (4) x1 Serial Attached SCSI (SFF-8482, adapter based) fan-out cable with sideband signals. It measures .8 meters and is used for connecting a Series 7/7Q/7H/7He adapter to SAS disks.

- Part Number: 2279600-R
- Dimension: 0.8 Meter

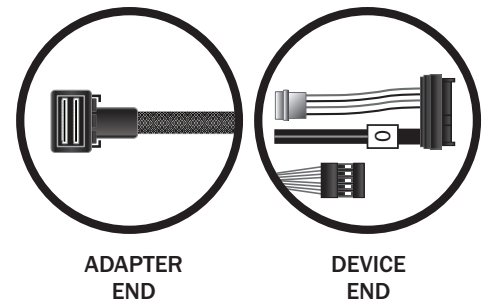

ACK-E-HDmSAS-E-mSAS-2M



The Adaptec E-HDmSAS-E-mSAS-2M is an external Mini SAS HD x4 (SFF-8644) to external mini SAS (SFF-8088) cable. It measures 2 meters and is used for connecting a Series 7/7H/7He adapter to an external enclosure with mini SAS HD connectors.

- Part Number: 2280300-R
- Dimension: 2 Meter

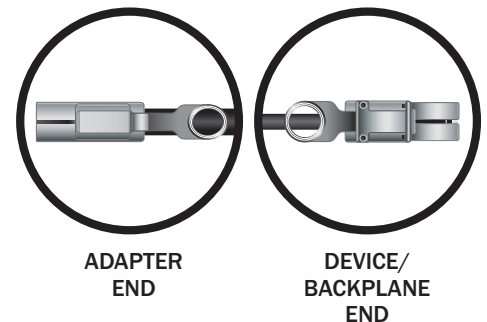

For more information, visit: www.adaptec.com/cables



PMC-Sierra, Inc.
1380 Bordeaux Dr.
Sunnyvale, CA 94089 USA
Tel: +1 (408) 239-8000

World Wide Web: www.adaptec.com

Pre-Sales Support: **US and Canada:** 1 (800) 442-7274 or (408) 957-7274 or adaptec-sales@pmcs.com
UK: +44 1276 854 528 or uk_sales@pmcs.com
Australia: +61-2-90116787
Germany: +49-89-45640621 or adaptec-sales.germany@pmcs.com
Singapore: +65-92351044