

AFJ

AFJ

Black Nylon Based Stepped Adjustable Leveling Feet

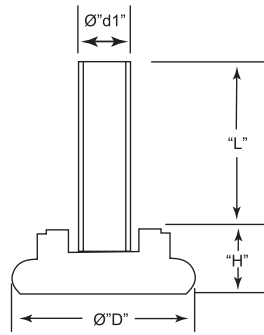

- Economic leveler for uneven surfaces
- Polymer cushion provides shock absorption

Material: Nylon Base, Low-Carbon Steel Stud with Zinc-Plated Finish					
Color: Black					
Part No.	"D" Base Ø	"H" Height	"L"	"d1" Thread Size	Standard Pack
AFJ1010A	1.00 (25.4)	.375 (9.5)	.875 (22.2)	1/4-20	600
AFJ1020A			1.000 (25.4)		560
AFJ1030A			1.500 (38.1)		520
AFJ1040A			1.750 (44.5)	5/16-18	480
AFJ1050A			.875 (22.2)		600
AFJ1060A			1.000 (25.4)		560
AFJ1070A			1.500 (38.1)		520
AFJ1080A			1.750 (44.5)		480