

**Overview**

The BM15 series high torque stepper motors have a 1.8° step angle, NEMA15 dimensions and are available in single or dual shaft versions. They feature 4 leads but can be provided also with 6 or 8 leads upon request. Custom lead length adaptation is available.

The dual shaft motors are optionally available with a differential encoder.



**Specifications**

Model Number		Current / Phase	Resistance / Phase	Inductance / Phase	Holding Torque	Rotor Inertia	Weight	Detent Torque	Length
Single Shaft	Dual Shaft	A	Ω	mH	g-cm (oz-in)	g-cm <sup>2</sup>	kg	g-cm	mm
BM15-9-S	BM15-9-D	0.4	6.6	7.5	648 (9)	11	0.12	50	20
BM15-24-S	BM15-24-D	0.65	7.0	9.3	1728 (24)	20	0.18	120	34
BM15-29-S	BM15-29-D	0.4	30	32	2088 (29)	20	0.18	120	34
BM15-31-S	BM15-31-D	0.6	15	16	2200 (31)	20	0.18	120	34
BM15-40-S	BM15-40-D	0.5	24	45	2880 (40)	24	0.20	180	38

Step Angle	1.8°
Step Angle Accuracy	±5% (full step, no load)
Resistance Accuracy	±10%
Inductance Accuracy	±20%
Temperature Rise	80°C max. (rated current, both phases on)
Ambient Temperature	-20°C ~ +50°C
Insulation Resistance	100MΩ min., 500VDC
Dielectric Strength	500VAC for one minute
Shaft Radial Play	0.02 max. (450 g load)
Shaft Axial Play	0.08 max. (450g load)
Max. Radial Force	28N (20mm from the flange)
Max. Axial Force	10N
Direction of Rotation	CW (when viewing from the front flange)

**Dimensions in mm**

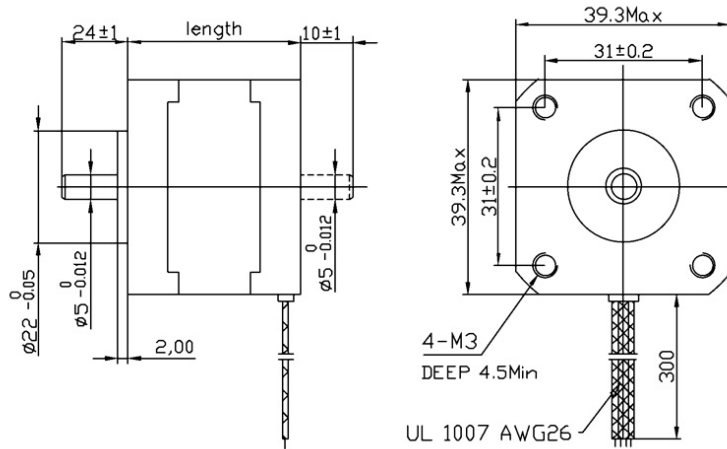

**Connection**

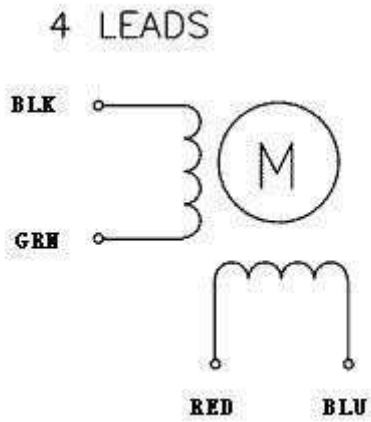

*Torque Speed Curves*

