

DESCRIPTION: **975 SERIES D-SUB BACKSHELL**

**BACKSHELL KIT INCLUDES:**

- (2) BACKSHELL HAVLES
- (2) 4-40 THUMBSCREWS
- (2) HOUSING SCREWS
- (1) STRAIN RELIEF CLAMP
- (2) STRAIN RELIEF SCREWS
- (2) CABLE SLOT SHUT-OFFS (9 POS HAS NONE)

975-YYY-020R121

SERIES \_\_\_\_\_

POSITIONS \_\_\_\_\_

009 \_\_\_\_\_

015 \_\_\_\_\_

025 \_\_\_\_\_

037 \_\_\_\_\_

MATERIAL \_\_\_\_\_

020 = METALIZED PLASTIC

COLOR: \_\_\_\_\_

12 = NICKEL OVER COPPER

PUT-UPS \_\_\_\_\_

1 = KIT

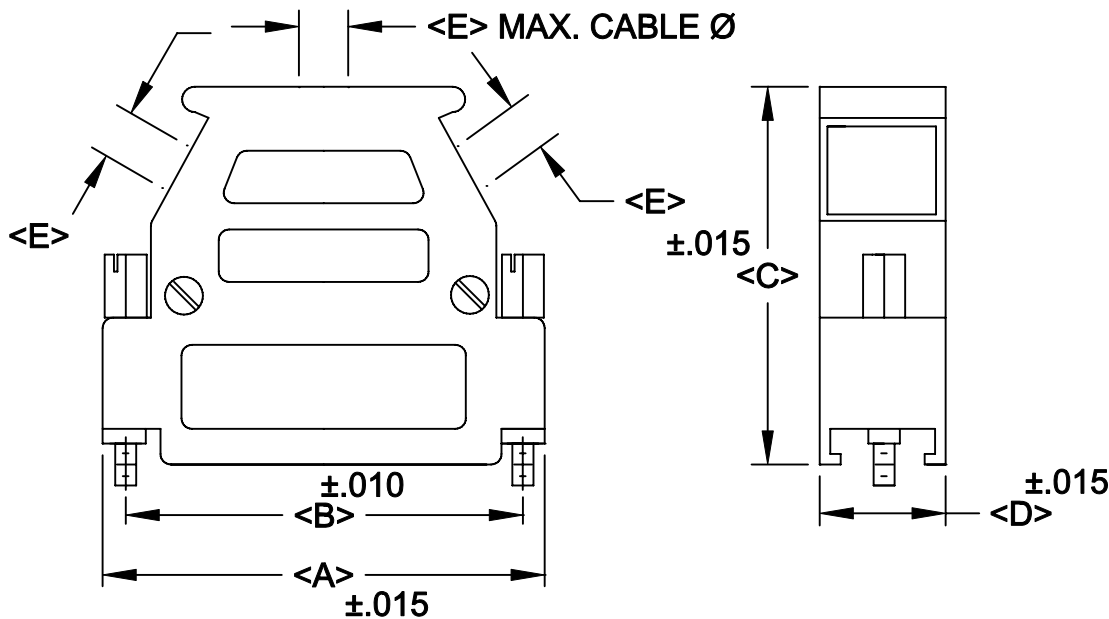

( 9 POS DOES NOT HAVE SIDE ENTRIES)

POS.	A	B	C	D	E
9	1.213	.984	1.800	.600	.300
	30.81	24.99	45.72	15.24	7.62
15	1.541	1.312	1.800	.600	.335
	39.14	33.32	45.72	15.24	8.51
25	2.088	1.852	1.800	.600	.375
	53.04	47.04	45.72	15.24	9.53
37	2.735	2.500	1.800	.600	.400
	69.47	63.50	45.72	15.24	10.16

PLASTIC: ABS POLYLAC U.L. 94V-O  
 PLATING: NICKEL OVER COPPER  
 THUMBSCREWS: STEEL  
 HOUSING SCREWS: STEEL  
 OPERATING TEMP: -30°C TO +90°C

RoHS COMPLIANT

	THESE DRAWINGS AND SPECIFICATIONS ARE THE PROPERTY OF NorComp AND SHALL NOT BE REPRODUCED, COPIED OR USED AS THE BASIS FOR THE MANUFACTURE OR SALE OF APPARATUS WITHOUT WRITTEN PERMISSION.		DRAWN: <b>PAM JENKINS</b>	DATE: <b>6-10-05</b>
			CHECKED:	DATE:
<b>NorComp</b>	SCALE	SHEET	OF	REV <b>1</b>
	DWG NO.		<b>975-YYY-020R121</b>	