

5,000 V - 20,000 V Single Phase Bridge

2.0 A Forward Current

70 ns Recovery Time

SPB50UFA
SPB100UFA
SPB150UFA
SPB200UFA

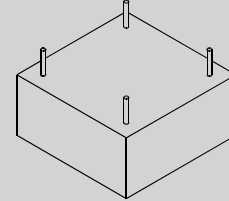

ELECTRICAL CHARACTERISTICS AND MAXIMUM RATINGS

Part Number	Working Reverse Voltage (Vrwm)	Average Rectified Current (Io)			Reverse Current @ Vrwm (Ir)		Forward Voltage (Vf)		1 Cycle Surge Current tp=8.3ms (Ifsm)	Repetitive Surge Current (Ifrm)	Reverse Recovery Time (1) (Trr)	Case Length (L)
		70 °C	55 °C	25 °C	25 °C	100 °C	25 °C	25 °C				
		Oil	Heatsink	No Heatsink								
	Volts	Amps	Amps	Amps	µA	µA	Volts	Amps	Amps	Amps	ns	in.
SPB50UFA	5000	2.0	1.5	0.70	1.0	25	12.0	1.5	50	10	70	1.50
SPB100UFA	10000	2.0	1.5	0.70	1.0	25	18.0	1.5	50	10	70	1.75
SPB150UFA	15000	2.0	1.5	0.70	1.0	25	30.0	1.5	50	10	70	2.25
SPB200UFA	20000	2.0	1.5	0.70	1.0	25	36.0	1.5	50	10	70	2.50

(1)Trr Testing: If=0.5A, Ir=1.0A, Irr=0.25A *Op. Temp.= -55°C to +150°C Stg. Temp.= -55°C to +150°C

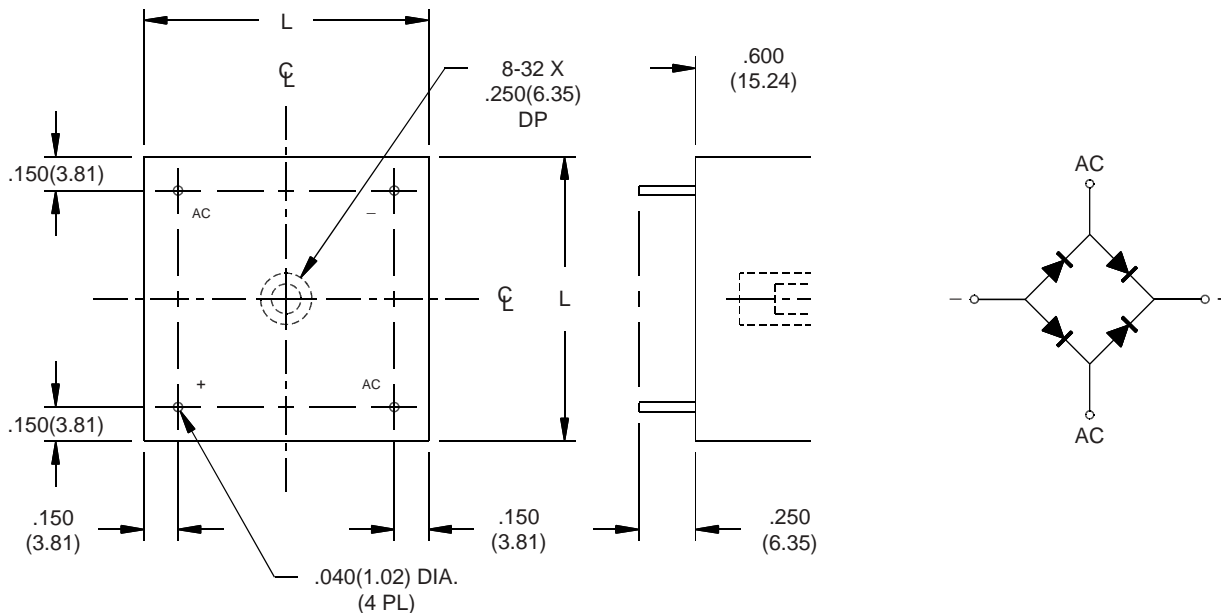

Dimensions: In. (mm) • All temperatures are ambient unless otherwise noted. • Data subject to change without notice.



VOLTAGE MULTIPLIERS INC.
 8711 W. Roosevelt Ave.
 Visalia, CA 93291

TEL 559-651-1402
 FAX 559-651-0740
www.voltagemultipliers.com

SPB50UFA SPB100UFA SPB150UFA SPB200UFA

