

High Voltage Diodes - Formed Lead

Original Released: 05-03-07
Revised Date: 08-29-12

0.75A - 2.00A • 30ns - 50ns • Hermetic

ELECTRICAL CHARACTERISTICS AND MAXIMUM RATINGS												
Part Number	Working Reverse Voltage (V _{rw})	Average Rectified Current (I _o)		Reverse Current @ V _{rw} (I _r)		Forward Voltage (V _f)		1 Cycle Surge Current t _p =8.3ms (I _{fsm})	Repetitive Surge Current (I _{frm})	Reverse Recovery Time (3) (T _{rr})	Thermal Impd. θ _{J-C}	Junction Cap. @50VDC @1kHz (C _j)
		55 °C(1)	100 °C(2)	25 °C	100 °C	25 °C		25 °C	25 °C	25 °C	25 °C	25 °C
	Volts	Amps	Amps	µA	µA	Volts	Amps	Amps	Amps	ns	°C / W	pF
1N6837LL	5000	0.75	0.50	1.0	25	12.0	0.50	20	4	30	5.0	16
1N6838LL	2000	2.00	1.50	1.0	25	4.50	1.50	60	10	50	5.0	20
1N6839LL	5000	1.00	0.60	1.0	25	10.0	0.60	30	6	50	5.0	16

(1)TC=55°C (2)TC=100°C (3)I_f=0.5A, I_r=1.0A, I_{rr}=0.25A *Op. Temp.= -65°C to +175°C Stg. Temp.= -65°C to +200°C



Part	A	B
1N6837LL	.390(9.91) MAX.	.260 (6.60)
1N6838LL	.350(8.89) MAX.	.220 (5.59)
1N6839LL	.390(9.91) MAX.	.260 (6.60)

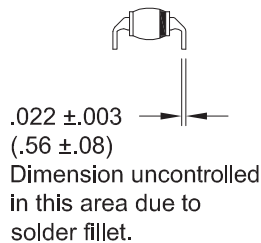
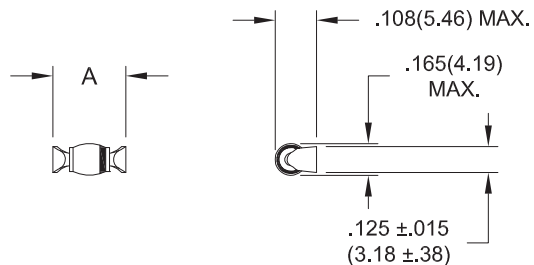
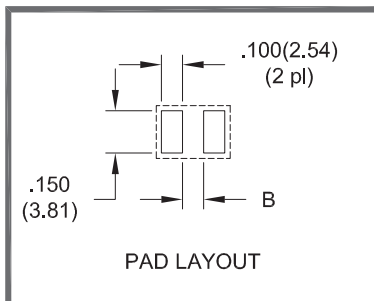

Dimensions: In. (mm) • All temperatures are ambient unless otherwise noted. • Data subject to change without notice.



Voltage Multipliers Inc.

8711 W. Roosevelt Ave.
Visalia, CA 93291 USA

Tel: 559.651.1402
Fax: 559.651.0740

www.voltagemultipliers.com
www.highvoltagepowersupplies.com

1N6837LL 1N6838LL 1N6839LL

