

**Mallory Sonalert Products, Inc.**

Part #:

ZA016LDMT6**Sales Outline Drawing**

Revision:

B**Specifications:**

Sound Level Category:	Loud	Loud	Loud	Loud
Mode of Operation:	Continuous	Slow Pulse @ 1 PPS	Fast Pulse @ 10 PPS	Siren Sweep 2.8 - 3.4 kHz @ 5 Sweeps per Sec.
Loudness @ 2 FT:	85 to 95 dB(A) Typ.	85 to 95 dB(A) Typ.	85 to 95 dB(A) Typ.	85 to 95 dB(A) Typ.
Pulse Rate (PPS):		1	10	5
Frequency:	3300 ± 500 Hz	3300 ± 500 Hz	3300 ± 500 Hz	2800-3400 Hz
Connection:	"+" to Positive, "-" to Ground	"+" to Positive, "-" and "1" to Ground	"+" to Positive, "-" and "2" to Ground	"+" to Positive, "-", "1" and "2" to Ground
Voltage Rating:	6 to 16 VDC			
Current Draw:	40mA MAX			
Housing Material:	6/6 Nylon, Color: Black			
Storage Temperature:	-40° to +55°C			
Operating Temperature:	-30° to +50°C			
Panel Mounting:	Recommended hole size is 22.5 mm. Thread front will fit standard 22.5mm hole.			
Knurled Nut:	Used to attach part to panel. The max recommended torque is 10 in-lbs.			
Weight (Typical):	28 g			
NEMA 3R, 4X, & 12:	Approved with use of ACC03.			
Options:	Please contact factory.			

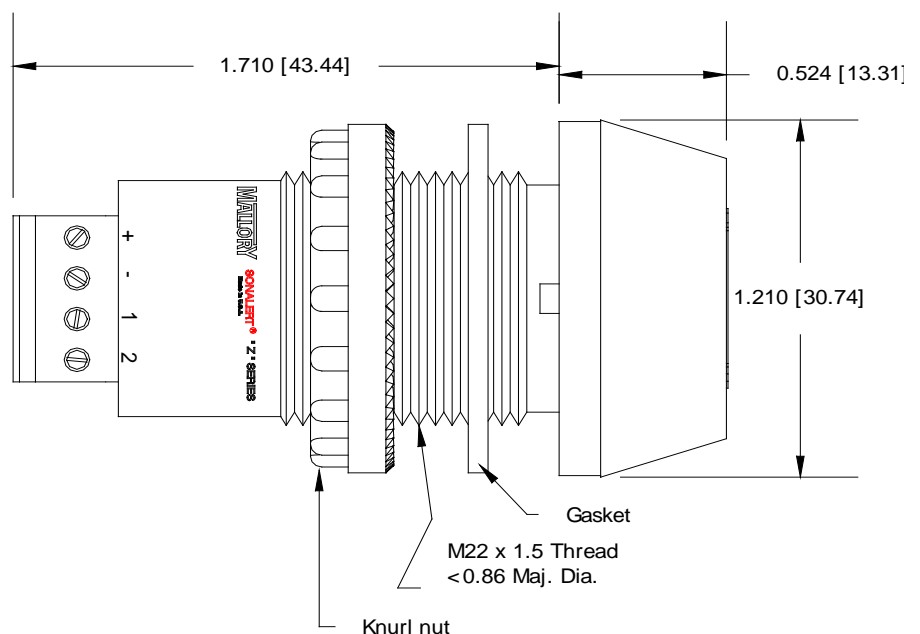
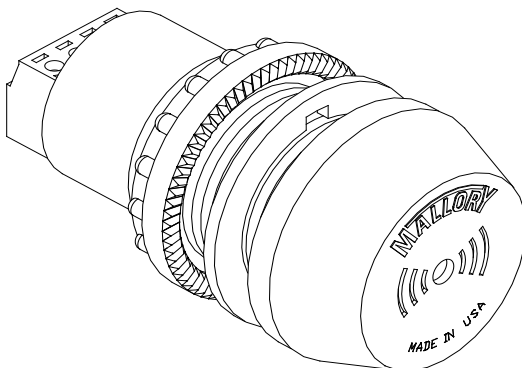
Dimensions: Inches (mm)**cUL Recognized****ROHS Compliant**

Mounting Instructions

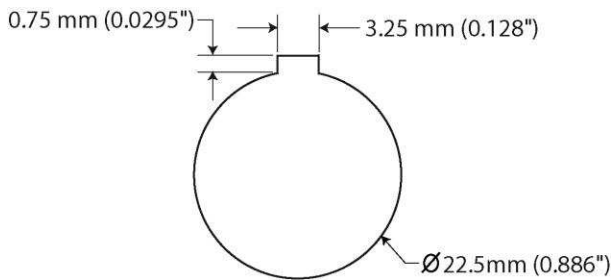

Panel Hollet Out

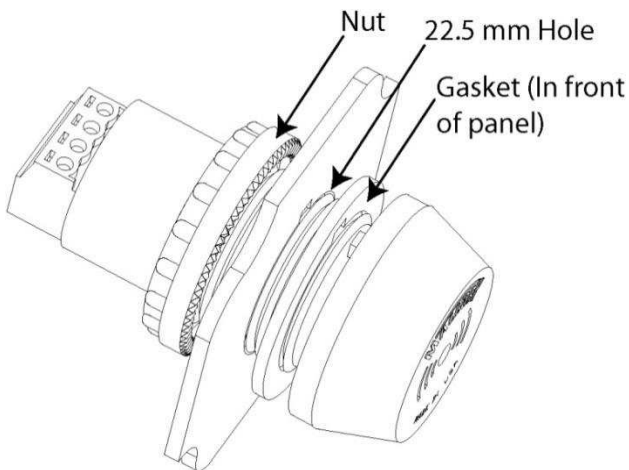

xPaneHole Si22.5 mm with Keyway

xMaximum Panel Thickness 12.7 mm (0.5 in)

xMaximum Nut Torque **10 in-lbs (1.13 n-m)**

Terminal Block Connection:

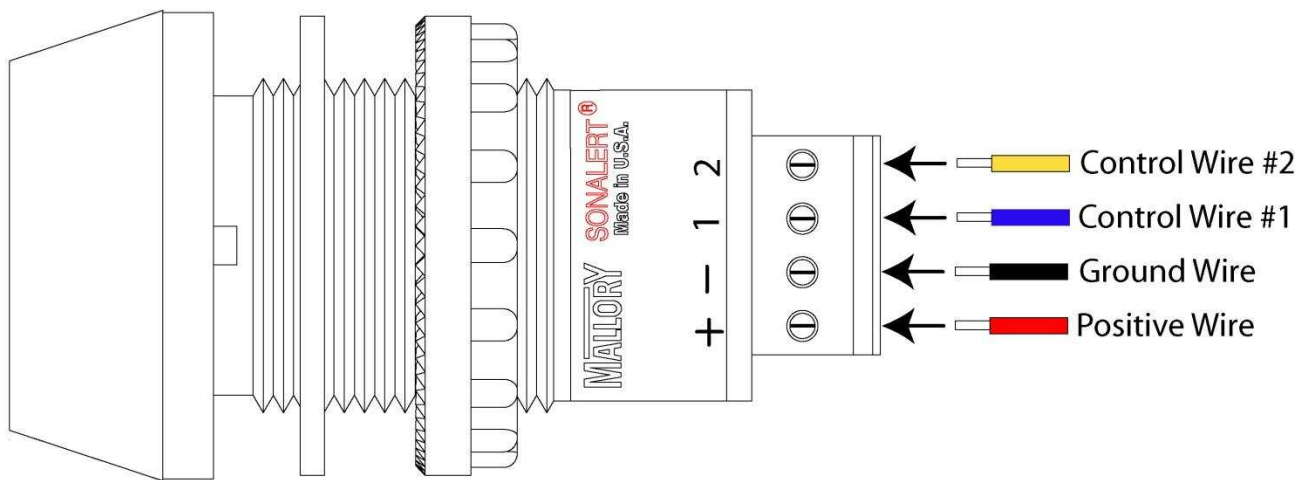

xWire Strip Length: 6.5 mm (0.256 in)

xWire Si30 to 16 AWG

xMaximum Screw Torque: 2 in-lbs (0.226 n-m)