

DEPT	
1	1
2	
3	
4	2
5	
6	
7	
8	
9	
10	
11	
12	
NC	
JZ	

PART NAME:

FEMALE TERMINAL

PART NO: 3000H 484A/

PART NUMBER	MATERIAL	FINISH
3000H 484A	.020 THICK BRASS	PRETINNED
3000H 484AB	.020 THICK BRASS	NONE

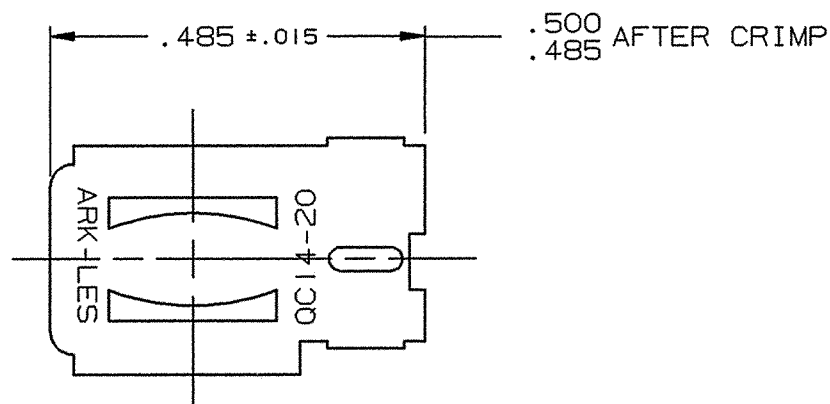
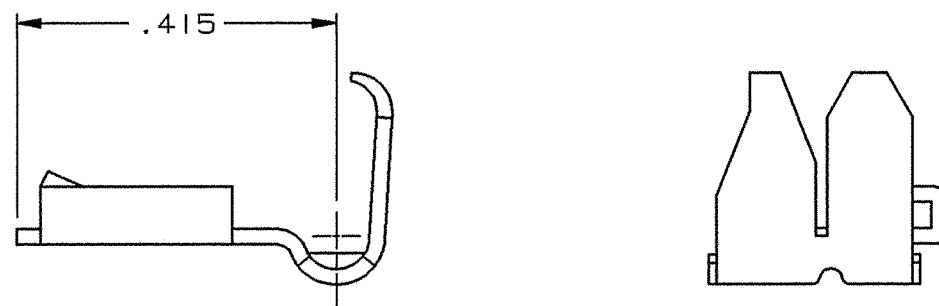
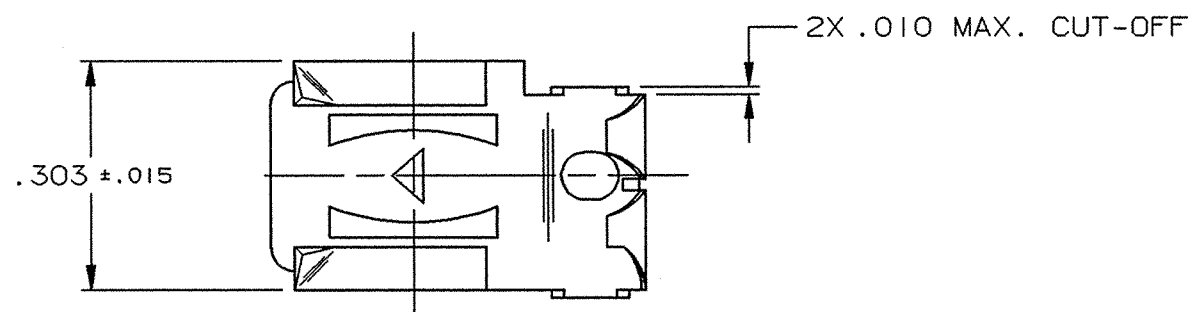

NOTES:

1. TO ACCEPT A .250 X .032 MALE TAB.
2. TO ACCOMMODATE # 14 - # 20 GAUGE WIRE.
3. RECOMMENDED STRIP LENGTH: 5/16 ±1/32.
4. INSERTION/WITHDRAWAL FORCES TO COMPLY WITH UL 310.
5. FOR TERMINALS LOOSE PIECE SEE 3000H 484A/-1K. (FOR LOOSE PIECE PRE-FORMED WIRE GRIPS ONLY).
6. FOR STANDARD REELING SEE FIGURE 1.
7. FOR REVERSE REELING ADD SUFFIX "R" TO PART NUMBER (i.e. 3000H 484AR) SEE FIGURE 2.
8. WIRE LEADS MAY BE ATTACHED IN A SPECIAL APPLICATOR WHICH FORMS ONE WIRE GRIP EAR TO PROVIDE AN INSULATION GRIP. THIS CAN ONLY BE USED ON WIRES WITH INSULATION RANGE OF .040-.120. (#18-#20 WIRE ONLY)

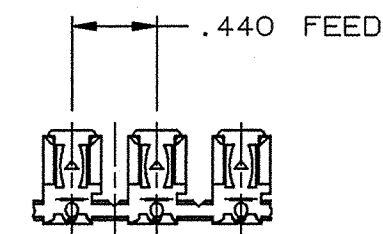

ARK-LES
UNCONTROLLED

FABRICATED TERMINAL STRIP

SCALE: 1=1

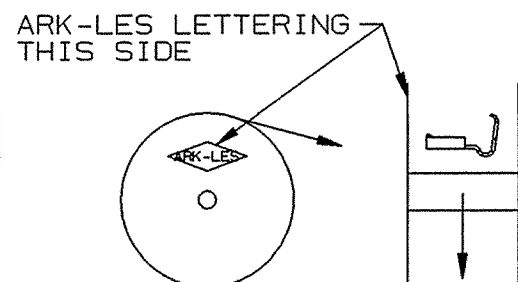

FIGURE 1
STANDARD REELING
(I.E. 3000H 484A)

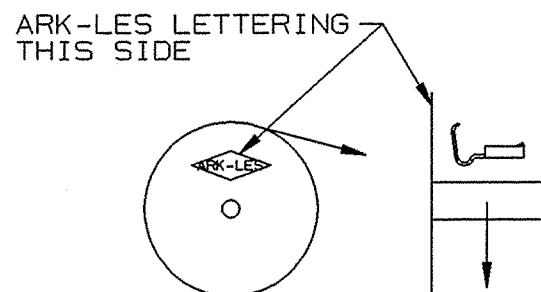

FIGURE 2
REVERSE REELING
(I.E. 3000H 484AR)

				PROD. REL.	86153	6/2/72	RT	TOLERANCES UNLESS OTHERWISE SPECIFIED:		
				QUOTE REL.	83915	2/29/72	DW	DECIMALS ±.010	METRIC ±0.25mm	ANGLES ±1°
				DR:	R. TASTULA	12/6/02		MATERIAL: SEE TABLE		
				CHK'D:	R.W.T.	12-18-02		FINISH: SEE TABLE		
				APP:	J. S. Miller	1-22-03		PART NO: 3000H 484A/		
R	REVISED PER ECR #12441	12/6/02	RT	SUPERCEDES DWG. DATED:	3/1/88					
REV.	DESCRIPTION	DATE	DR.	SCALE: 4:1	CAD NO: BT00109					

ORIGINAL IF RED