

DEPT	1
1	
2	
3	
4	3
5	
6	
7	
8	
9	
10	
11	
12	
NC	
JZ	

PART NAME: FEMALE TERMINAL

PART NO: 3650H103A/-2

PART NO.	MATERIAL	FINISH
3650H103A-2	.010 BRASS	PRETINNED
3650H103AB-2	.010 BRASS	NONE

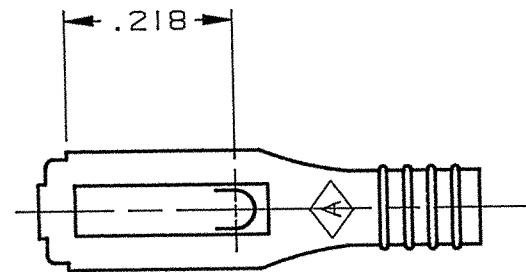
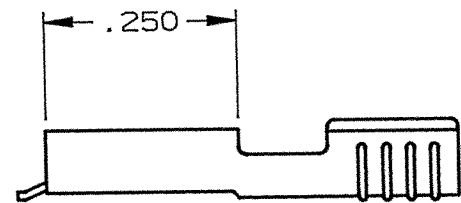
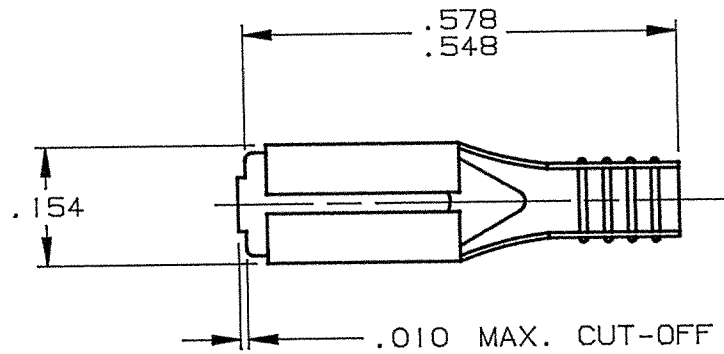

- NOTES:
- MUST ACCEPT MALE TAB .110/.125 X .032.
 - WIRE RANGE: #18-#24 AWG.
 - FOR REVERSE REELING ADD SUFFIX "R" TO PART NUMBER (i.e. 3650H103A-2R).
 - FOR LOOSE PIECE PARTS ADD "-1" TO PART NUMBER (i.e. 3650H103A-2-1).
 - RECOMMENDED STRIP LENGTH: 7/32 ± 1/32.

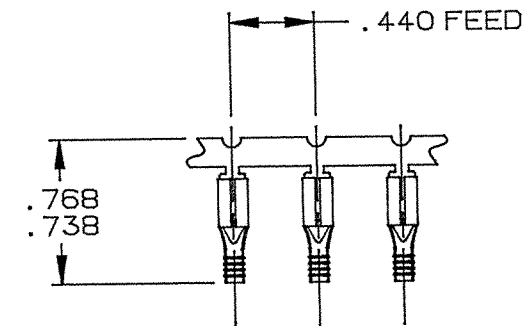

FABRICATED TERMINAL STRIP

SCALE 1=1

ARK-LES UNCONTROLLED

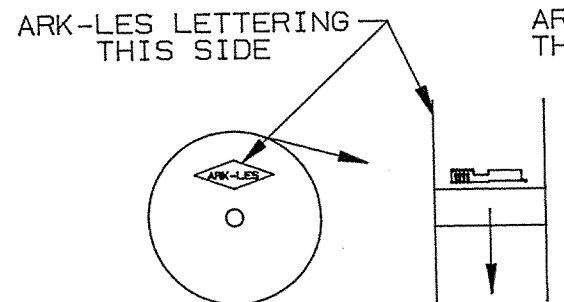

STANDARD REELING
(I.E. 3650H103A-2)

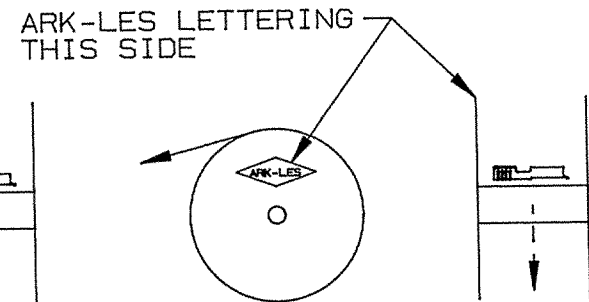

REVERSE REELING
(I.E. 3650H103A-2R)

REV.	DESCRIPTION	DATE	DR.	SCALE: 4=1	CAD NO: BUM0024	TOLERANCES UNLESS OTHERWISE SPECIFIED: DECIMALS ±.010 METRIC ±0.25mm ANGLES ±1°
P	REVISED & REDRAWN PER ECR •11590	9/1/98	RT			MATERIAL: SEE TABLE
						FINISH: SEE TABLE
						PART NO: 3650H103A/-2

ORIGINAL IF RED