

LTR	REVISION	DATE	APPD
-	RELEASE	08-05-05	

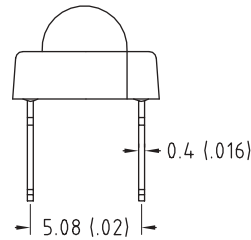
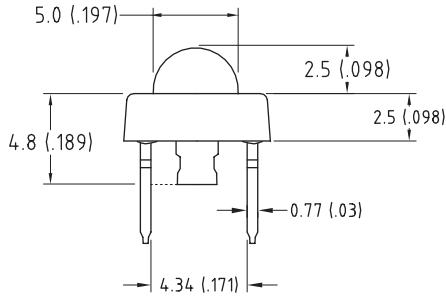
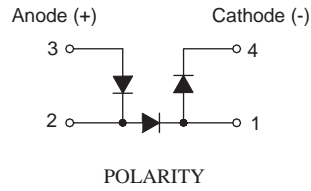
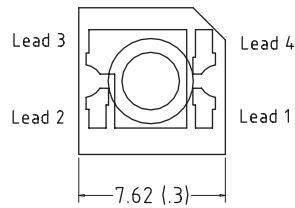

- \* The anode (lead 3) and cathode (lead 4) are designated in the drawing above. Only these leads should be electrically connected on the circuit board. Leads 1 and 2 are not electrically neutral.  
**Do not electrically connect leads 1 and 2 to the circuit board.**
- \* The anode lead (lead 3) is the main heat conducting lead. For better heat dissipation, circuit design should provide for large metal pads surrounding the anode lead.

CHIP MATERIAL	LENS COLOR	EMISSION COLOR
InGaN	WATER CLEAR	INCAND. WHITE

**Notes:**

1. ALL DIMS ARE IN MILLIMETERS (INCHES).
2. TOLERANCE IS  $\pm 0.25\text{mm}$  ( $\pm 0.010"$ ) UNLESS OTHERWISE SPECIFIED.
3. PROTRUDED RESIN UNDER FLANGE IS 1.0mm (.04") MAX.
4. LEAD SPACING IS MEASURED WHERE LEADS EMERGE FROM THE PACKAGE.
5. LEADS TO BE SOLDERABLE AND CAPABLE OF MEETING THE SOLDERABILITY REQUIREMENTS OF MIL-STD-202, METHOD 208.
6. MANUFACTURE DATE SHALL NOT BE OLDER THAN 26 WEEKS (6 MONTHS).

**ATTENTION**  
OBSERVE PRECAUTIONS  
FOR HANDLING-  
ELECTROSTATIC  
SENSITIVE  
DEVICES



-PROPRIETARY-  
This document contains Proprietary information of LEDTRONICS, INC. It may not be copied, used or disclosed for any purpose without the prior express written consent of LEDTRONICS, INC.

.XXX  $\pm$  .010 TOLERANCE PER ANSI-Y14.5  
.XX  $\pm$  .025 (UNLESS OTHERWISE STATED)  
ANGLES  $\pm$  0°30'  
FRACT.  $\pm$  1/32

TITLE <b>SPL330CIW1KH-3S</b>					
DWG NO DSMS0072		SCALE 2:1		SHEET 1 OF 3	
DATE 08-05-05		DATE 08-05-05		DATE 08-05-05	
CODE IDENT NO. 8Z410	DWG BY RM	CHK BY PL 08-15-05	QA GZ 08-15-05	MNFG	CUSTOMER

LTR	REVISION	DATE	APPD
-	RELEASED	08-05-05	

### Absolute Maximum Ratings at Ta 25°C

Parameter	MAX.	Unit
Power Dissipation	220	mW
Peak Forward Current (1/10 Duty Cycle, 0.1ms Pulse Width)	100	mA
Continuous Forward Current	20	mA
Derating Linear From 50°C	0.4	mA/°C
Reverse Voltage*	5	V
Electrostatic Discharge (ESD)	150	V
Operating Temperature Range	-20°C to +80°C	
Storage Temperature Range	-30°C to +100°C	
Lead Soldering Temperature [4mm (.157") From Body]	260°C for 5 Seconds	

\* VR rating tested for each individual chip

### Electrical Optical Characteristics at Ta=25°C

Parameter	Symbol	Min.	Typ.	Max.	Unit	Test Condition
Luminous Intensity	I <sub>v</sub>	3000	3500	---	mcd	I <sub>f</sub> =20mA (Note 1)
Viewing Angle	2θ <sub>1/2</sub>	---	70	---	Deg	(Note 2)
Forward Voltage	V <sub>f</sub>	---	9.5	11	V	I <sub>f</sub> =20mA
Reverse Current	I <sub>R</sub>	---	---	50	μA	V <sub>R</sub> =5V
SCP	---	---	---	---	---	---
Lumens	---	---	---	---	---	---
Radiant Intensity	---	---	11100	---	μW/sr	---

Color Rank (CCT)	(CIE1931 x, y coordinates)
BIN 1 (2800K~3000K)	(0.4208, 0.3725); (0.4355, 0.3766); (0.4683, 0.4394); (0.4516, 0.4353)
BIN 2 (3000K~3200K)	(0.4093, 0.3669); (0.4208, 0.3725); (0.4516, 0.4353); (0.4373, 0.4311)

**Notes:**

- Luminous intensity is measured with a light sensor and filter combination that approximates the CIE eye-response curve.
- θ<sub>1/2</sub> is the off-axis at which the luminous intensity is half the axial luminous intensity.
- Forward voltage measurement allowance is ±0.1V
- Luminous intensity measurement allowance is ±10%
- Respective CCT ranges for each color rank are for reference only. Binning is done according to CIE 1931 x, y coordinates.



**-PROPRIETARY-**  
 This document contains Proprietary information of LEDTRONICS, INC.  
 It may not be copied, used or disclosed for any purpose without the prior express written consent of LEDTRONICS, INC.  
 .XXX ± .010 TOLERANCE PER ANSI-Y14.5  
 .XX ± .025 (UNLESS OTHERWISE STATED)  
 ANGLES ± 0°30'  
 FRACT. ± 1/32

TITLE		SPL330CIW1KH-3S			
DWG NO	SCALE	SHEET	DATE		
DSMS0072-A	NTS	2 OF 3	08-05-05		
CODE IDENT NO.	DWG BY	CHK BY	QA	MNFG	CUSTOMER
8Z410	RM				

LTR	REVISION	DATE	APPD
-	RELEASED	08-05-05	

CIE 1931 Chromaticity Diagram

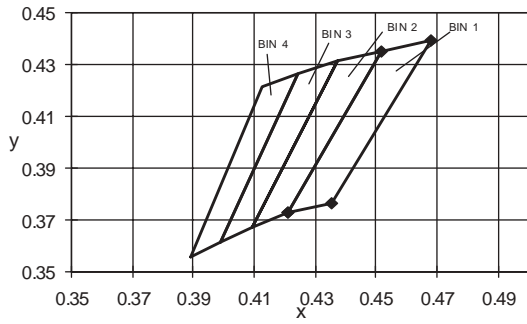

Spectral Radiance

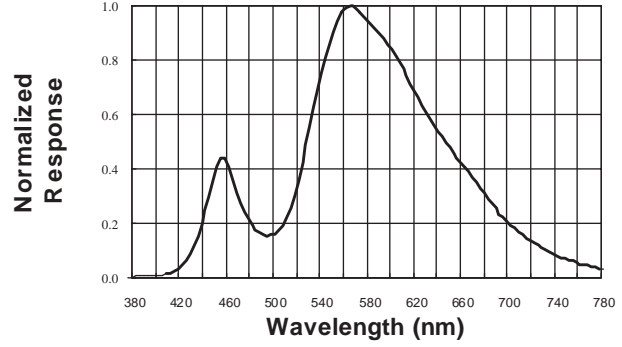

Forward Current vs. Forward Voltage

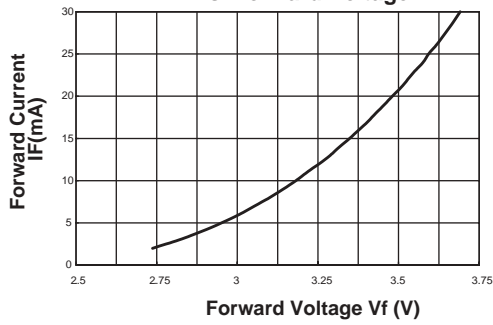

Relative Luminous Intensity vs. Forward Current

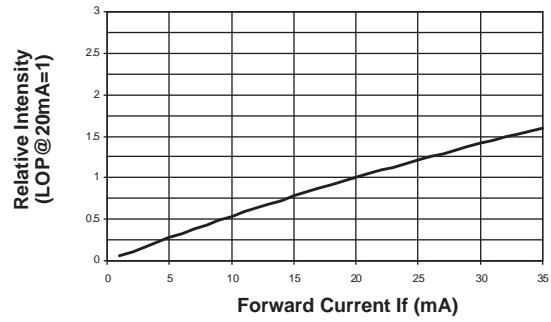

Forward Current vs. Chromaticity Coordinates (CIE1931 x, y)

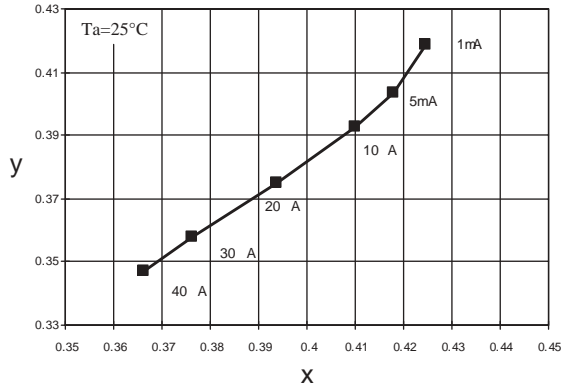

Forward Current Derating Curve

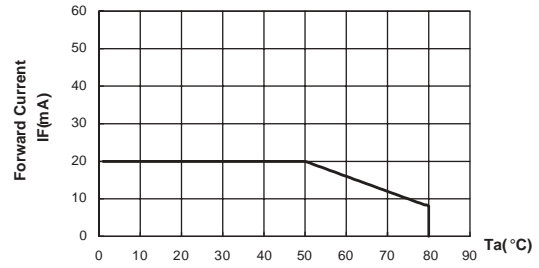

Beam Pattern

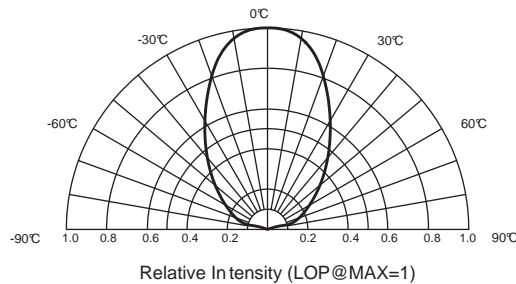

**LED**  
**LEDTRONICS INC**<sup>®</sup>  
 23105 KASHIWA COURT  
 TORRANCE, CA 90505

**-PROPRIETARY-**  
 This document contains Proprietary information of LEDTRONICS, INC.<sup>™</sup> It may not be copied, used or disclosed for any purpose without the prior express written consent of LEDTRONICS, INC.<sup>™</sup>

.XXX ± .010 TOLERANCE PER ANSI-Y14.5 (UNLESS OTHERWISE STATED)  
 .XX ± .025  
 ANGLES ± 0°:30'  
 FRACT. ± 1/32

TITLE		SPL330CIW1KH-3S			
DWG NO	SCALE	SHEET	DATE		
DSMS0072-B	NTS	3 OF 3	08-05-05		
CODE IDENT NO.	DWG BY	CHK BY	QA	MNFG	CUSTOMER
8Z410	RM				