

LTR	REVISION	DATE	APPD
-	RELEASED	12-08-11	

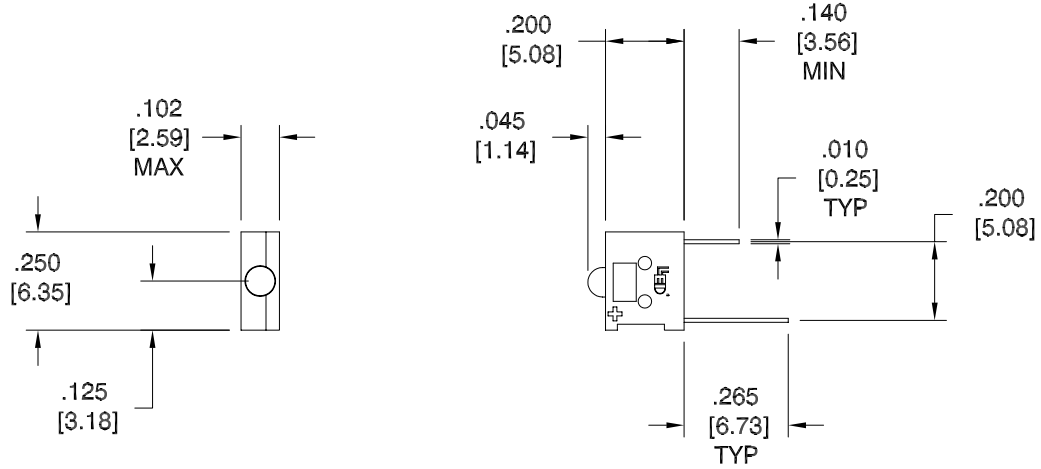

NOTES:

1. ALL DIMENSIONS ARE IN INCHES [MILLIMETERS].
2. LED COLOR: YELLOW
3. LENS APPEARANCE: YELLOW DIFFUSED
4. BASE MATERIAL: VALOX UL RATING UL94V-1 MIN / 94V-0 PREFERRED
5. BASE COLOR: BLACK



REVISION NOTIFICATION	
<input type="checkbox"/>	PMA
<input type="checkbox"/>	UL
<input type="checkbox"/>	MADE IN USA
<input type="checkbox"/>	CUSTOMER _____
<input type="checkbox"/>	OTHER

LED[®]
LEDTRONICS,™ INC.
 23105 KASHIWA COURT
 TORRANCE, CA 90505

-PROPRIETARY-
 This document contains Proprietary information of LEDTRONICS,™ INC. It may not be copied, used or disclosed for any purpose without the prior express written consent of LEDTRONICS,™ INC.

.XXX ± .010 TOLERANCE PER ANSI-Y14.5
 .XX ± .025 (UNLESS OTHERWISE STATED)
 ANGLES ± 0°,30'
 FRACT. ± 1/32

TITLE 555M-3401-001					
DWG NO SDPC0671-CUST		SCALE 2:1		SHEET 1 OF 2	
DATE 12-08-11		MFG		R&D BJ	
CODE IDENT NO. 8Z410	DWG BY GP 12-08-11	CHK BY PL 12-12-11	QA	MFG	R&D BJ 12-09-11

● Absolute maximum ratings(Ta=25°C)

Parameter	Symbol	Rating	Unit
Power Dissipation	Pd	100	mW
Forward Current	I _F	30	mA
Peak Forward Current* ¹	I _{FP}	150	mA
Reverse Voltage	V _R	5	V
Operating Temperature	Topr	-40°C~85°C	
Storage Temperature	Tstg	-40°C~100°C	
Soldering Temperature	Tsol	260°C max (for 5 seconds)	

*¹Condition for I_{FP} is pulse of 1/10 duty and 0.1msec width.

● Electrical and optical characteristics(Ta=25°C)

Parameter	Symbol	Condition	Min.	Typ.	Max.	Unit
Forward Voltage	V _F	I _F =10mA	-	2.0	3.0	V
Luminous Intensity	I _v	I _F =10mA	1.0	3.0	-	mcd
Reverse Current	I _R	V _R =5V	-	-	100	μA
Peak Wave Length	λ _p	I _F =10mA	-	585	-	nm
Dominant Wave Length	λ _d	I _F =10mA	-	-	-	nm
Spectral Line Half-width	Δλ	I _F =10mA	-	35	-	nm
Viewing Angle	2θ _{1/2}	I _F =10mA	-	30	-	deg
Radiant Intensity		I _F =10mA	-	-	-	μW/sr
Chromaticity Coordinates	X	I _F =10mA	-	0.	-	
	Y		-	0.	-	