

LTR	REVISION	DATE	APPD
-	RELEASED	04-25-11	

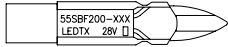

ACTUAL SIZE

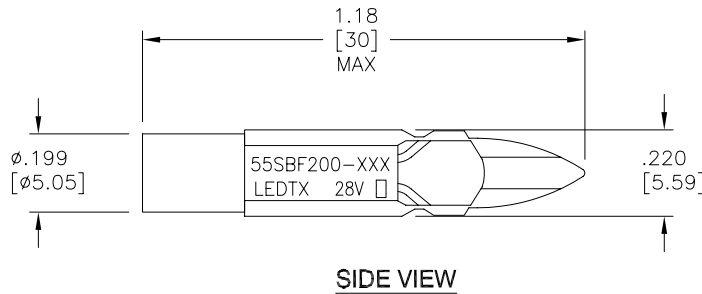
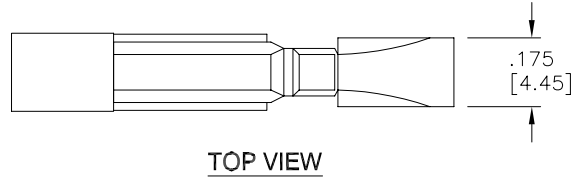

**NOTES:**

1. ALL DIMENSIONS ARE IN INCHES [MILLIMETERS].
2. ALL PARTS WITH (\*) ARE RoHS CERTIFIED.
3. SLEEVE MATERIAL: EPOXY
4. BASE MATERIAL: BLACK BAKELITE



55SBF200-0AG-028V*	AQUA GREEN	28 VDC	14	400	519	80°	*
55SBF200-0CW-028V*	COOL WHITE	28 VDC	14	160	8000K	90°	*
55SBF200-0PB-028V*	SUPER BLUE	28 VDC	14	125	462	85°	*
55SBF200-0UG-028V	SUPER GREEN	28 VDC	18	-	573	75°	
55SBF200-0UO-028V	SUPER ORANGE	28 VDC	18	-	610	95°	
55SBF200-0UR-028V*	ULTRA RED	28 VDC	18	85	650	85°	*
55SBF200-0UY-028V*	SUPER YELLOW	28 VDC	18	75	596	75°	*
55SBF200-1AG-028V*	AQUA GREEN	28 VDC	14	-	525	80°	*
LEDTRONICS PART NO.	COLOR EMITTED	INPUT VOLTAGE, V	READ mA (typ.)	lv mod (typ.)	λP nm	VIEWING ANGLE	
		ELECTRICAL TEST					

REVISION NOTIFICATION	
<input type="checkbox"/>	PMA
<input type="checkbox"/>	UL
<input type="checkbox"/>	MADE IN USA
<input type="checkbox"/>	CUSTOMER _____
<input type="checkbox"/>	OTHER

<p>LEDTRONICS, INC. 23105 KASHIWA COURT TORRANCE, CA 90505</p>	<p><b>-PROPRIETARY-</b> This document contains Proprietary Information of LEDTRONICS, INC. It may not be copied, used or disclosed for any purpose without the prior express written consent of LEDTRONICS, INC.</p>	<p>TITLE <b>55SBF200-XXX-028V</b></p>			
	<p>.XXX ± .010 TOLERANCE PER ANSI-Y14.5 .XX ± .025 (UNLESS OTHERWISE STATED) ANGLES ± 0°,30' FRACT. ± 1/32</p>	<p>DWG NO 55SBF200-28V-DC</p>	<p>SCALE 2:1</p>	<p>SHEET 1 OF 1</p>	<p>DATE 04-25-11</p>
	<p>CODE IDENT NO. 8Z410</p>	<p>DWG BY GP 04-25-11</p>	<p>CHK BY PL 04-26-11</p>	<p>QA</p>	<p>MFG</p>