

LTR	REVISION	DATE	APPD
6	040113-JH01: UPDATED LABEL & TEST DATA	04-02-13	GP

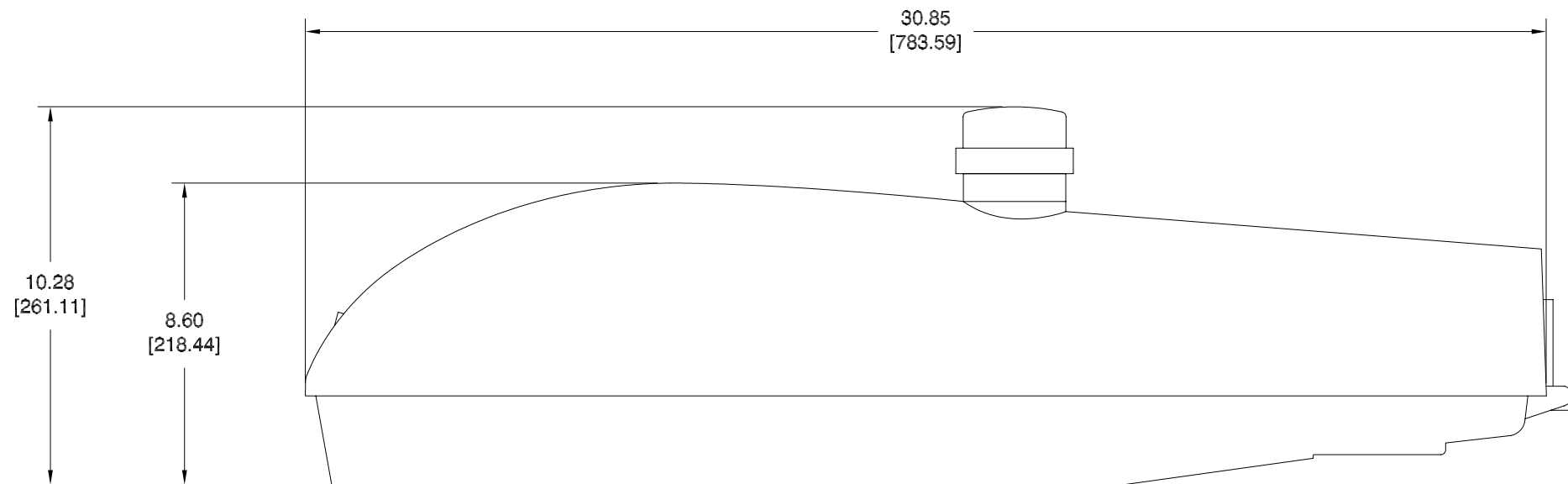

SIDE VIEW

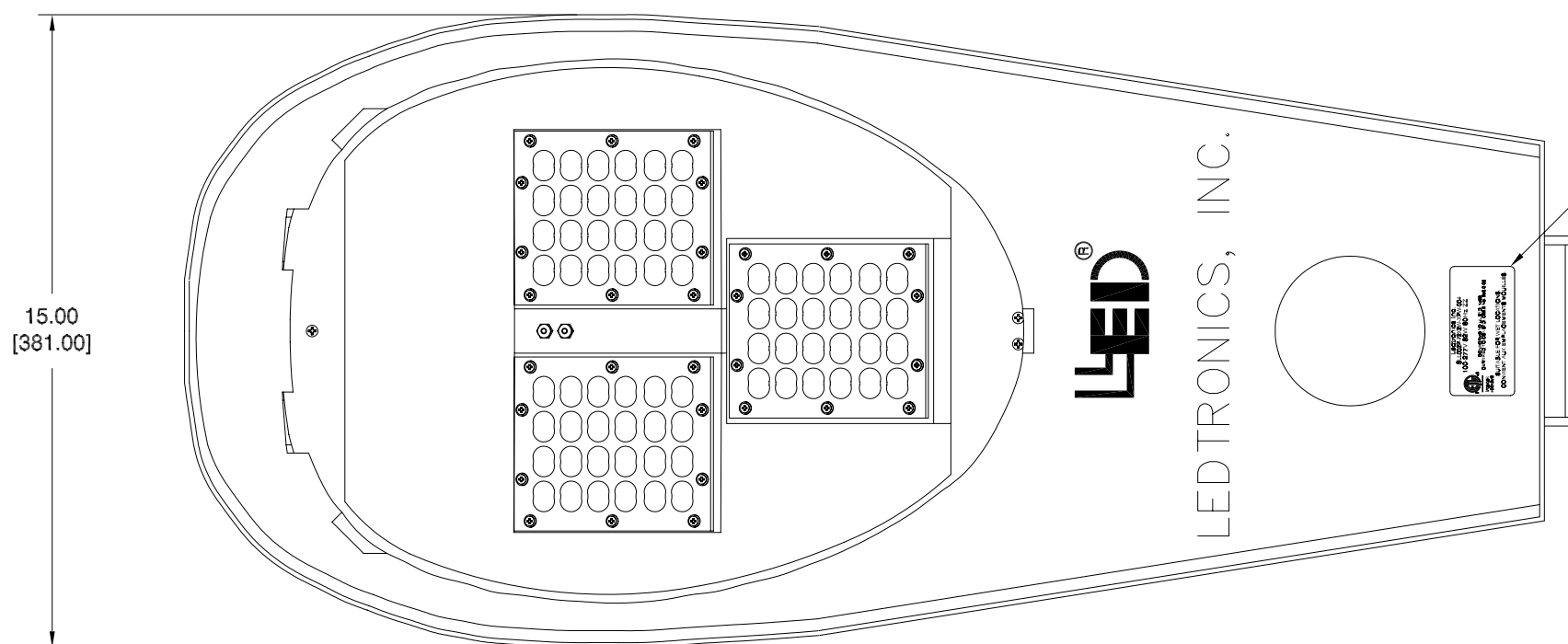

BOTTOM VIEW

Ledtronics Inc.
SLL002P-72X2W-XPW-004
100-277V 82W 60Hz ZZ

CONFORMS TO UL STD. 1598
CERTIFIED TO CSA STD. C22.2 No. 250.0-08

Intertek
4001379

SUITABLE FOR WET LOCATIONS.
CONVIENT AUX EMPLACEMENTS MOUILLES.



Intertek
4001379

NOTES:

1. ALL DIMENSIONS ARE IN INCHES [MILLIMETERS].
2. HOUSING MATERIAL: CAST ALUMINUM
3. LENS MATERIAL: CLEAR, TEMPERED HARDENED GLASS
4. WEIGHT: 20.1 lbs.

REVISION NOTIFICATION	
<input type="checkbox"/>	PMA
<input checked="" type="checkbox"/>	UL/ETL
<input checked="" type="checkbox"/>	MADE IN USA
<input type="checkbox"/>	CUSTOMER _____
<input type="checkbox"/>	OTHER

ELECTRO-OPTICAL CHARACTERISTICS

SLL002P-72X2W-XPW-004	PURE WHITE	120VAC	640-785	82	.99	81.9	6673	4223	5000K~5600K
		277VAC	275-335	82	.90				
LEDTRONICS PART NO.	COLOR EMITTED	INPUT VOLTAGE, V	INPUT CURRENT (mA)	ENERGY USED (Watts)	POWER FACTOR	EFFICACY lm/w	TOTAL LUMENS	FOOT CANDELA (typ)	COLOR TEMP. (Kelvin) REF.

LEDTRONICS, INC.
23105 KASHIWA COURT
TORRANCE, CA 90505

-PROPRIETARY-
This document contains Proprietary information of LEDTRONICS, INC. It may not be copied, used or disclosed for any purpose without the prior express written consent of LEDTRONICS, INC.

.XXX ± .010 TOLERANCE PER ANSI-Y14.5
.XX ± .025 (UNLESS OTHERWISE STATED)
ANGLES ± 0°.30'
FRACT. ± 1/32

TITLE		SLL002P-72X2W-XPW-004			
DWG NO	SCALE	SHEET	DATE		
SLL002020-CUST	1:4	1 OF 1	12-14-11		
CODE IDENT NO. 8Z410	DWG BY AG 12-14-11	CHK BY	QA RD 04-04-13	MFG LD 04-03-13	R&D BJ 04-03-13