

AC-2/20MHUVS Group

Type: Pulse Start Metal Halide
Electronic Ballast
Lamp Types: Two 20W ANSI Code M156
SLI lamps or cross reference GE,
Philips or Sylvania/OSRAM lamps

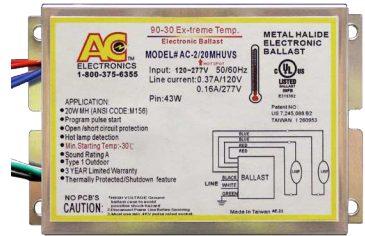

SPECIFICATIONS

Input Voltage	Number of Lamps	Lamp ANSI	Lamp Watts	Input Watts (typical)	Input Current (typical)	Power Factor	Max THD	Crest Factor	Ballast Factor	Bench Heat Test at 25°C Ambient
120	2	M156	20	45.44	0.377	.999	<10%	<1.7	1.00	55°C
277	2	M156	20	43.49	0.176	.994	<10%	<1.7	1.00	47°C

SAFETY & PERFORMANCE

- 120-277V, 50/60Hz Input Voltage
- UL Listed
- cUL Listed
- Type HL
- Type 1 Outdoor
- Sound Rated A
- Surge Protected
- Short Circuit Protection/Auto Shut Off
- Class P Thermally Protected (Inherent)
- EMI/RFI Meets FCC Part18 Subpart C
- Thermal Trigger Protection
- End of Lamp Life Protection
- Strike Fail Protection
- Lamp Fail Protection
- Open Circuit Protection
- Auto Restart
- No PCBs

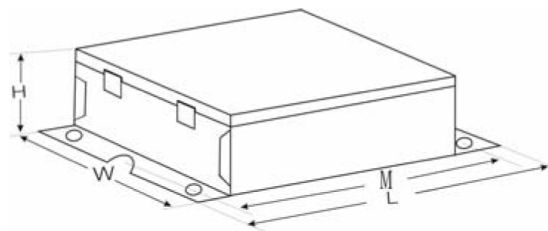

Dimensions	
Length (L)	5.42"
Width (W)	3.58"
Height (H)	1.26"
Mounting (M)	5.03"
Hole Diameter	0.20"
Weight	1.44 lbs.
Case Qty.	30 pcs.

APPLICATION

- Minimum Starting Temp -30°C
- Maximum Case Temp 90°C
- Remote Wiring Length up to 50 ft

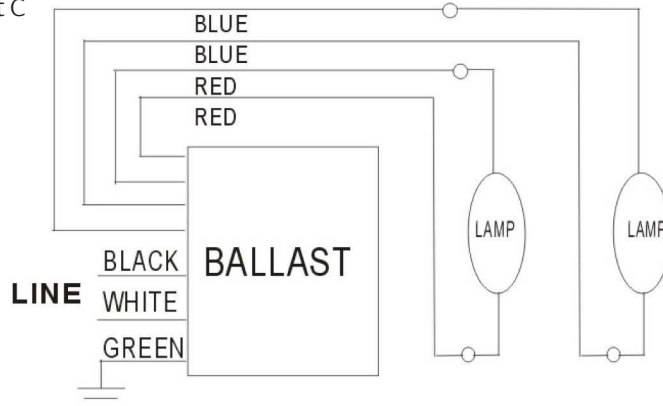

Wiring Lengths	
Black	9.8"
White	9.8"
Blue	9.8"
Red	9.8"
Green	9.8"
Yellow	9.8"

OPTIONS

AC-2/20MHUVBMS[†] (Bottom Mount: Stud to Stud: 2")

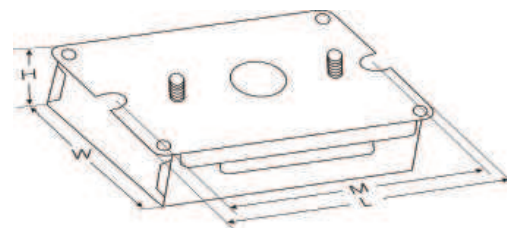

INSTALLATION

- Install in accordance with the National Electrical Code
- Use with 600V/4 KV pulse rated wire
- Use external ground wire
- Do not connect any lamp lead to neutral
- Mounting side of ballast package must be in complete contact with metallic fixture surface for proper thermal dissipation



WARRANTY

AC Electronics warrants to the purchaser that each electronic ballast will be free from defects in material or workmanship for a period of 3 years from the date of manufacture when properly installed and under normal conditions of use.

Administration & Distribution Center: 3401 Avenue D, Arlington, TX 76011
1-800-375-6355 • www.ace-ballast.com

Data is based upon tests performed by AC Electronics in a controlled environment and representative performance. Actual performance can vary depending on operating conditions. Specifications are subject to change without notice. All specifications are nominal unless otherwise noted.

