

# Round Trimming Potentiometer – 3309 9mm

# TSR-3309

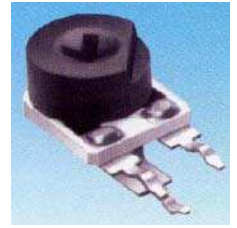

## 微 調 電 位 器

■ 單圈的/金屬陶瓷/工業用  
 ■ (Single Turn/ Cermet/ Industrial)

■ 2 種引線的安裝尺寸  
 ■ (2 Terminal Styles)

| 電氣特性 Electrical Characteristics |                      |
|---------------------------------|----------------------|
| Standard Resistance Range       | 10Ω - 2MΩ            |
| Resistance Tolerance            | ±30% std             |
| Absolute Minimum Resistance     | 1% max (≤2K=30Ω)     |
| Contact Resistance Variation    | 3% max               |
| Resistance                      | Essentially infinite |
| Adjustment Angle                | 235° nom             |

| 環境特性 Environmental Characteristics |                                 |
|------------------------------------|---------------------------------|
| Power Rating (50VDC max)           | 70°C, 0.5W                      |
| Temperature Range                  | -30°C ~ +100°C                  |
| Temperature Coefficient            | ±250ppm/°C                      |
| Load Life                          | 1,000 hours 0.5W @70°C (3% ΔTR) |

| 物理特性 Physical Characteristics    |  |
|----------------------------------|--|
| Mechanical Angle                 | 260°±10°   |
| Toque (Operating)                | 4.0oz-in.max   |
| Stop Strength                    | 7.0oz-in.max   |
| Terminals                        | Solderable pins                                      |
| Marking                          | Manufacturer's Trademark, resistance code, date code |
| Standard packaging               | 200pcs. Per bag                                      |
| Adjustment Tool                  | H-90   |
| Aqueous cleaning not recommended |  |

### 訂購指南 How to Order

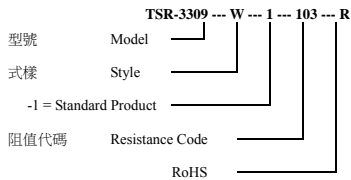

### 阻值代碼表 Standard Resistance table

| Resistance(Ohms) | Resistance Code |
|------------------|-----------------|
| 10               | 100             |
| 20               | 200             |
| 50               | 500             |
| 100              | 101             |
| 200              | 201             |
| 500              | 501             |
| 1,000            | 102             |
| 2,000            | 202             |
| 5,000            | 502             |
| 10,000           | 103             |
| 20,000           | 203             |
| 25,000           | 253             |
| 50,000           | 503             |
| 100,000          | 104             |
| 200,000          | 204             |
| 250,000          | 254             |
| 500,000          | 504             |
| 1,000,000        | 105             |
| 2,000,000        | 205             |

可按用戶要求提供特殊規格  
 Special resistances available.

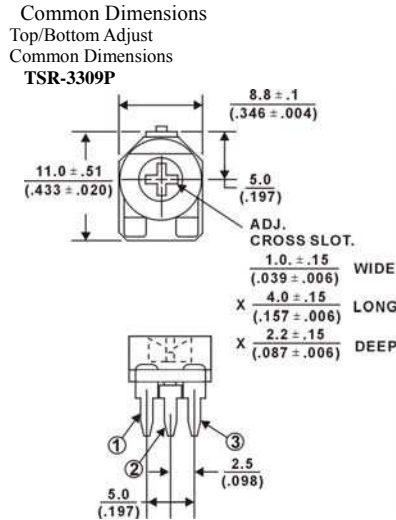

### SUGGESTED PWB LAYOUT – TSR-3309P

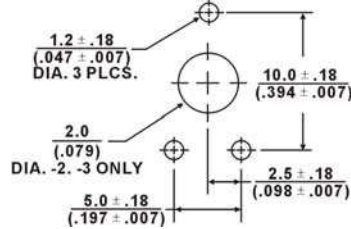

### TSR-3309P-2 Both Sides Adjust/Cross Slot

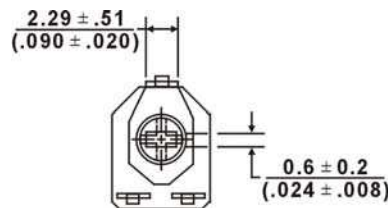
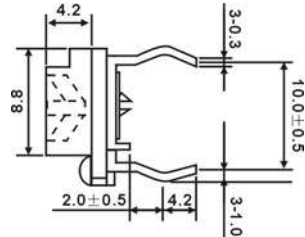

Slide Adjust  
 Common Dimensions

### TSR-3309W-1 Single Side (Front) Adjust

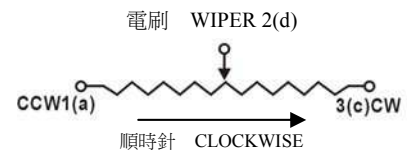
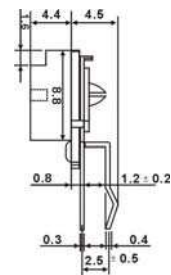
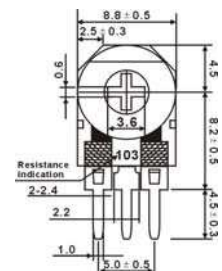

圖中公差：除注明外均為±0.25  
 Tolerance is ±0.25 if no identification