

MOTOR STARTING / RUNNING CAPACITOR

Suntan®

ELECTRICAL APPARATUE USE METALLIZED FILM WITH PRECISELY QUALITY CONTROL

FEATURES

TS11

- High safety. High reliability
- High I.R. (insulation resistance) small size.
- Low D.F. (dissipation factor), lower temperature rise.
- Durability and characteristics of frequency, etc..

S P E C I F I C A T I O N S

OPERATING CONDITION	-25°C~+70°C
CAPACITANCE RANGE	1uF~20uF(TS11-A~D、TS11-5~7、TS11-9) 1uF~100uF(TS11-11~18)
CAPACITANCE TOLERANCE	J(±5%)、K(±10%)
RATED VOLTAGE	250V 450V (AC)
WITHSTAND VOLTAGE	AC≥2U _R 2S(I _{max} ≤1.3 I _n A)
DISSIPATION FACTORY	≤0.003 1KHz(TS11-A~D、TS11-5~7、TS11-9) ≤0.004 1KHz(TS11-11~18)
INSULATION RESISTANCE	≥3000S

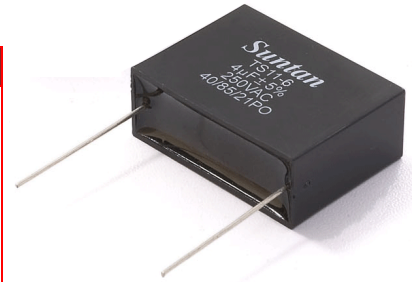

TS11-A

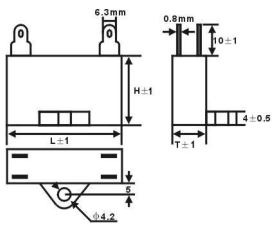

TS11-B

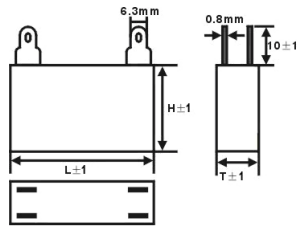

TS11-C

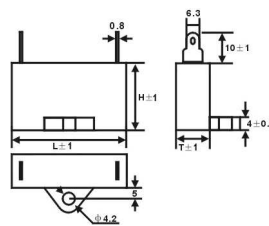

TS11-D

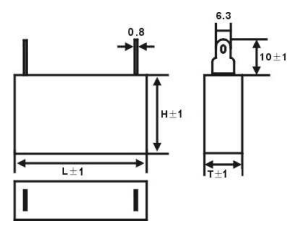

TS11-1

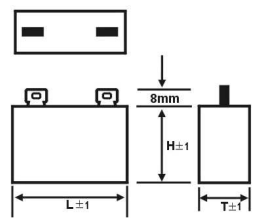

TS11-2

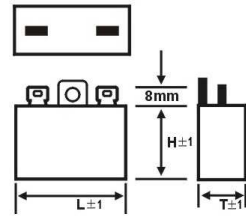

TS11-3

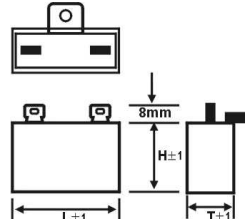

TS11-4

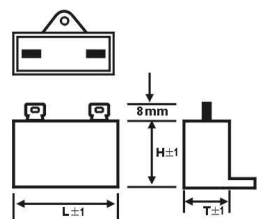

TS11-5

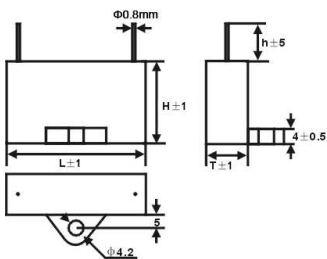

TS11-6

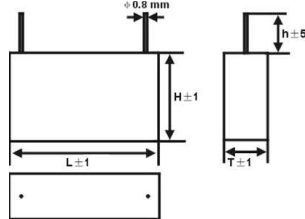

TS11-7

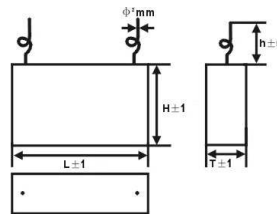

TS11-8

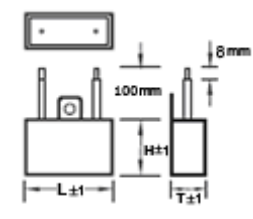

Dimensions (mm)

CAP	TS11-A, TS11-C, TS11-5, TS11-9						TS11-B, TS11-D, TS11-6, TS11-7					
	250VAC			450VAC			250VAC			450VAC		
uF	L	T	H	L	T	H	L	T	H	L	T	H
0.5	26.5	12.5	21	26.5	12.5	21	26.5	12	20	25.5	12	20
1	26.5	12.5	21	32	14	24	26.5	12	20	32	14	25
2	32	14	24	37	17	28	32	14	25	37	17	28
2.5	32	14	24	37	17	28	32	14	25	37	17	28
3	32	14	24	38	20	30	32	14	25	38	20	30
5	37	17	28	47	20	34	37	17	28	47	20	34
6	37	17	28	47	23	34	37	17	28	47	23	34
8	47	17.5	33	47	28	34	47	18	32	47	28	34
10	47	17.5	33	47	32	40	47	18	32	47	30	40
12	47	23	34	47	32	43	47	23	34	--	--	--
15	47	25	34	--	--	--	47	25	34	--	--	--
20	47	28	37	--	--	--	47	28	37	--	--	--

TS11-9

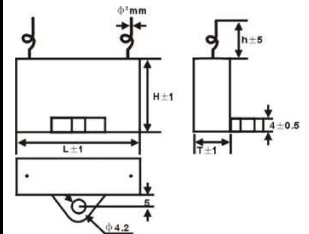

MOTOR STARTING / RUNNING CAPACITOR

Suntan®

ELECTRICAL APPARATUE USE METALLIZED FILM WITH PRECISELY QUALITY CONTROL

TS11

TS11-10

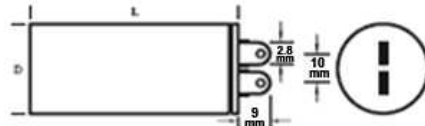

TS11-11

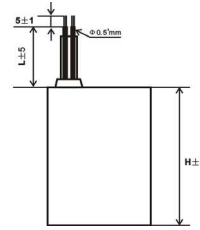
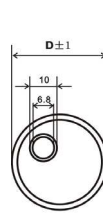

TS11-12

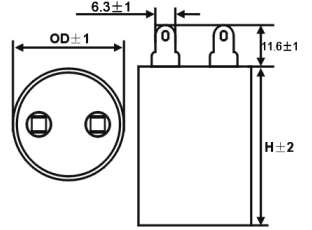

TS11-13

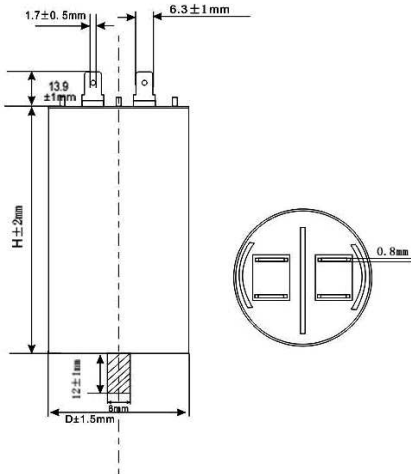

TS11-13 (only for 30x60)

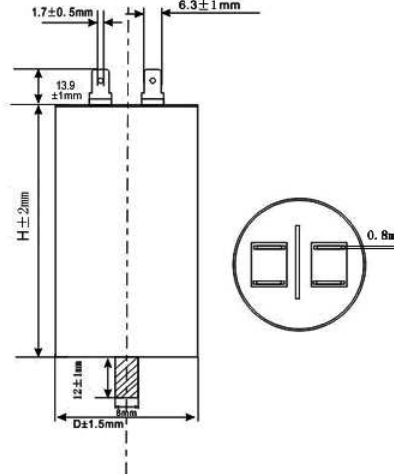

TS11-14

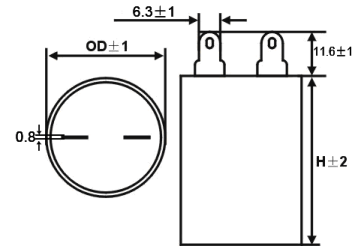

TS11-15

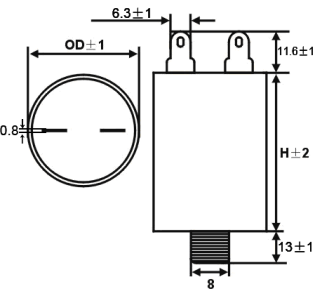

TS11-16

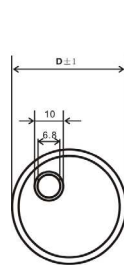

TS11-17

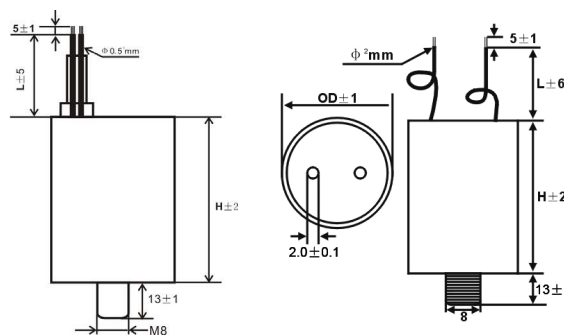

TS11-18

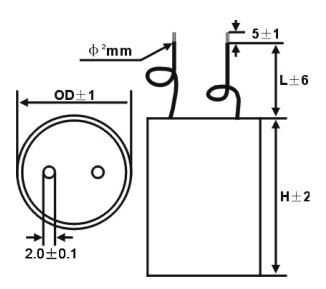

Dimensions (mm)

CAP	TS11-13,16,17				TS11-11,12,18				TS11-15				TS11-14			
	250VAC		450VAC		250VAC		450VAC		250VAC		450VAC		250VAC		450VAC	
uF	D	H	D	H	D	H	D	H	D	H	D	H	D	H	D	H
1	26	55	26	55	26	55	26	55	26	55	26	55	26	55	26	55
2	26	55	26	55	26	55	26	55	26	55	26	55	26	55	26	55
3	26	55	26	55	26	55	26	55	26	55	26	55	26	55	26	55
5	26	55	34	55	26	55	34	55	26	55	34	55	26	55	34	55
6	26	55	34	55	26	55	34	55	26	55	34	55	26	55	34	55
8	26	55	36	65	26	55	36	60	26	55	36	60	26	55	34	55
10	34	55	36	65	34	55	36	60	34	55	36	60	26	55	36	55
12	34	55	45	75	34	55	36	70	34	55	36	70	26	55	36	65
16	34	55	45	75	34	55	45	70	34	55	45	70	34	55	45	65
20	34	55	45	75	34	55	45	70	34	55	45	70	34	55	45	65
25	36	65	50	85	36	60	45	80	36	60	45	80	34	55	45	75
30	36	65	50	85	36	60	50	80	36	60	50	80	34	55	50	75
40	45	75	45	125	36	70	45	120	36	70	45	120	36	65	45	115
50	45	75	50	125	45	70	50	120	45	70	50	120	45	65	50	115
60	50	85	60	125	50	80	60	120	50	80	60	120	45	75	60	115
80	45	125	60	145	45	120	60	140	45	120	60	140	45	115	60	135
100	50	125	65	145	50	120	65	140	50	120	65	140	50	115	65	135

Note: Specifications are subject to change without notice. For more detail and update, please visit our website.