

8 7 6 5 4 3 2 1

E
D
C
B
A

E
D
C
B
A

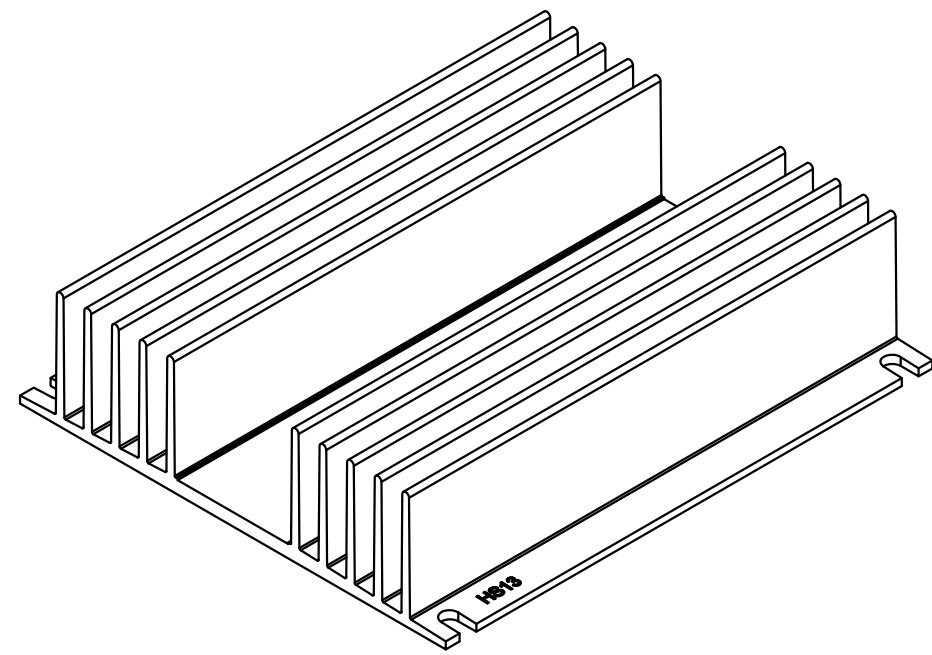
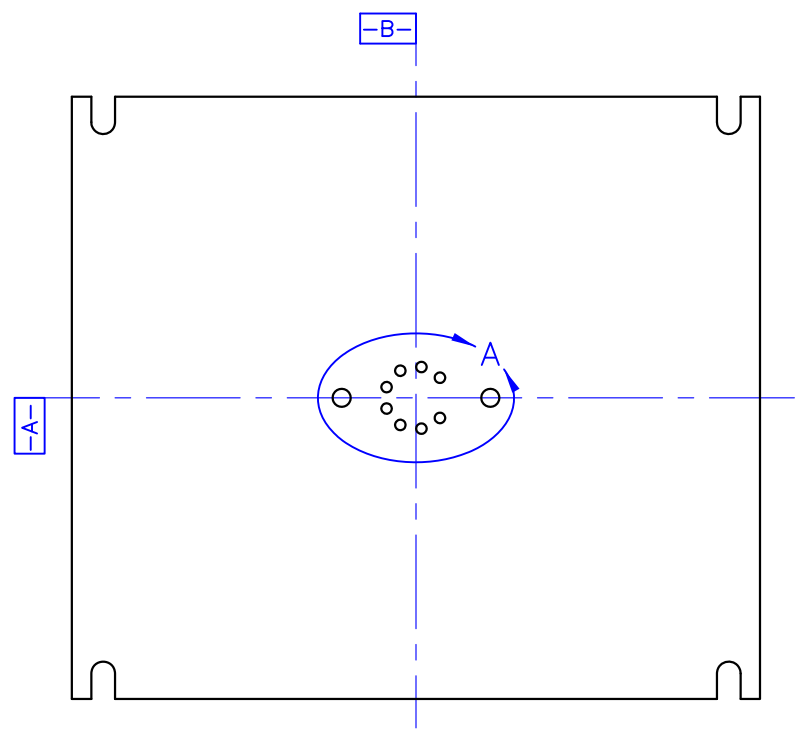
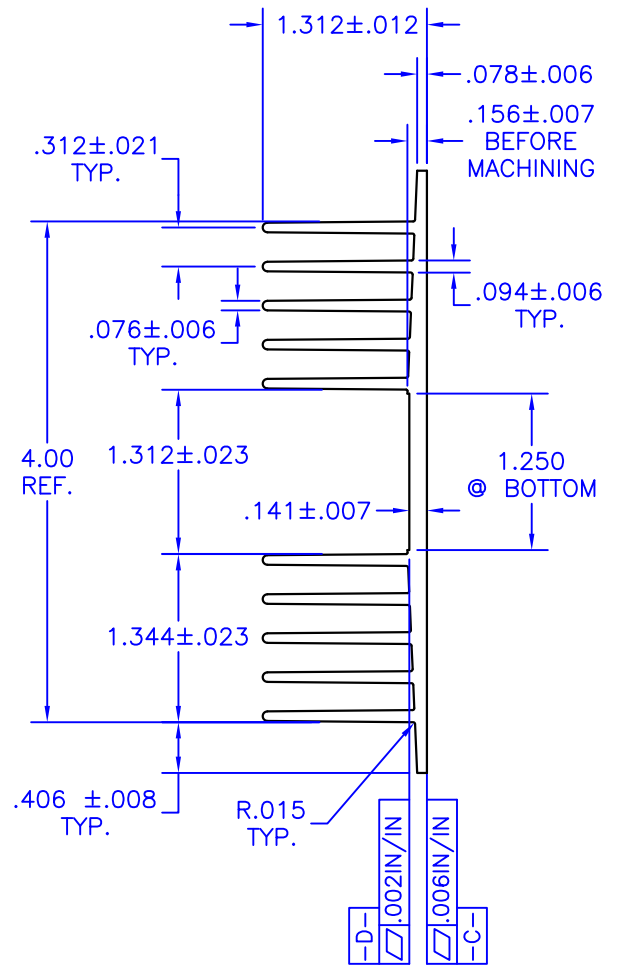
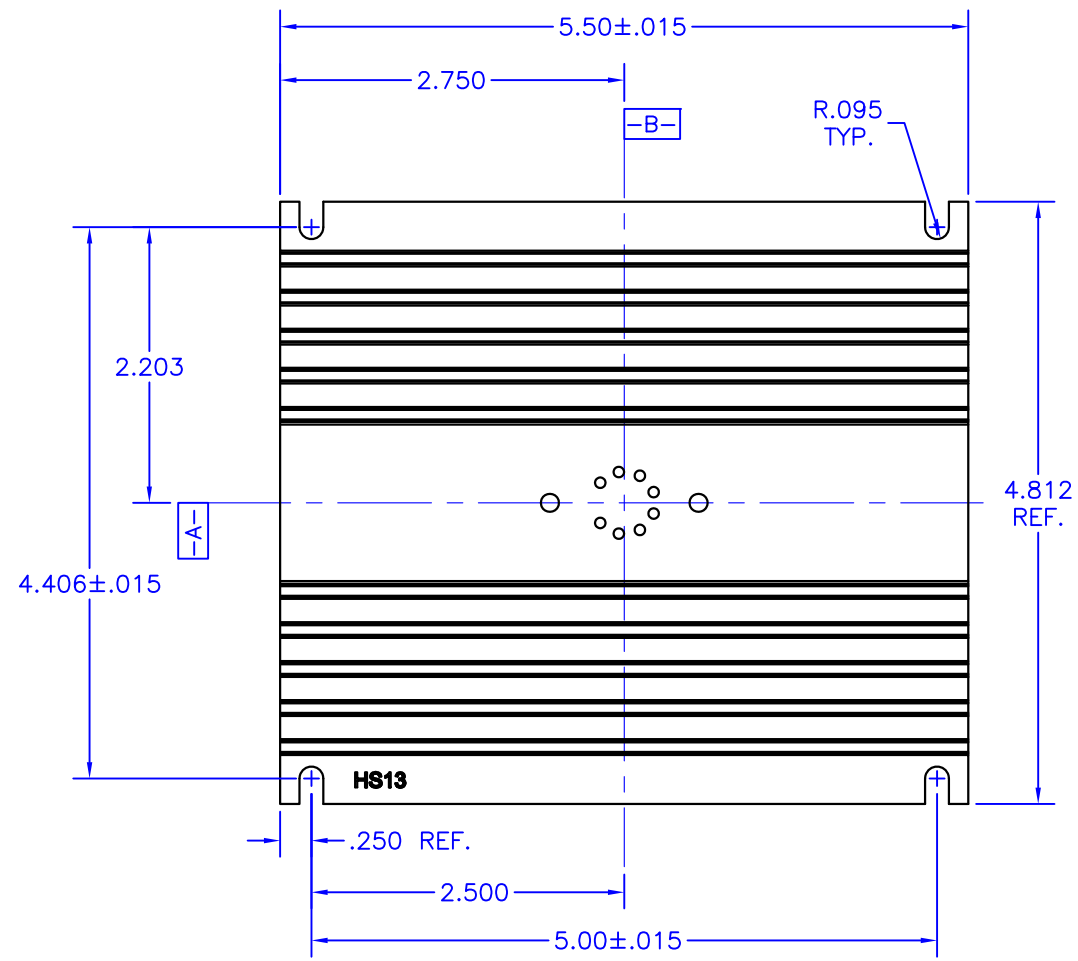

P1 HEATSINK
 MAT'L: 6063-T5 ALUMINUM (AAVID EXTRUSION #60840)
 FINISH: ANODIZE PER MIL-A-8625, TYPE II, CL 2, BLACK
 TYPICAL BREAKDOWN VOLTAGE > 300V

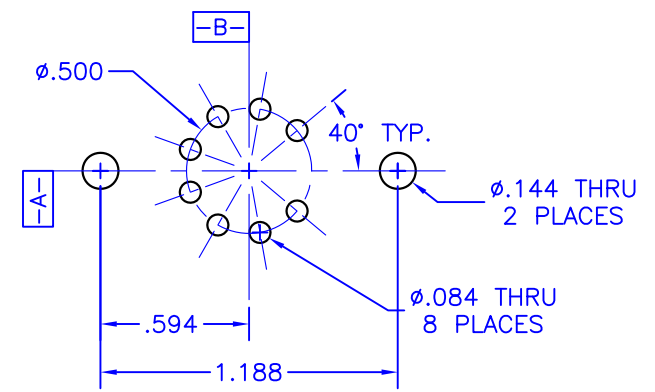

DETAIL A
SCALE: 2X

- NOTES:**
1. UNLESS OTHERWISE NOTED, ALL DIMENSIONS ARE IN INCHES.
 2. BREAK ALL SHARP EDGES, DE-BURR & REMOVE LOOSE CHIPS.
 3. MARK WITH CONTRASTING INK AS SHOWN, IF SPECIFIED BY PURCHASE ORDER.

TOLERANCES - UNLESS OTHERWISE SPECIFIED		TITLE: TO-3 HEATSINK		MODEL: HS13	
.XX = ±.05 [.002]		SUBJECT: MECHANICAL DRAWING		REV: H	
.XXX = ±.005 [.0002]		DRAWN BY: P.ECK		DATE: 14NOV12	
ANG. = ±2°		DCA: 12435		FILENAME: HS13	
APEX MICROTECHNOLOGY		SIL: 1 OF 1		REV: H	

8 7 6 5 4 3 2 1