

ITEM	Q'TY	PART NUMBER	PART DESCRIPTION
1	1	PM5	LED HOLDER, PANEL MOUNT, PRESS FIT, (5mm)
2	1	CC	HEADER CONNECTOR, .100" [2.54] PITCH
3	1	5SGT	T-1 3/4 (5mm) LED
4	1	BWS24-1007-RD	24AWG WIRE LEAD U.L. 1007, RED
5	1	BWS24-1007-BK	24AWG WIRE LEAD U.L. 1007, BLACK

REV	DESCRIPTION	DATE	APPROVED
A	ENGINEERING RELEASE.	08/15/03	MC

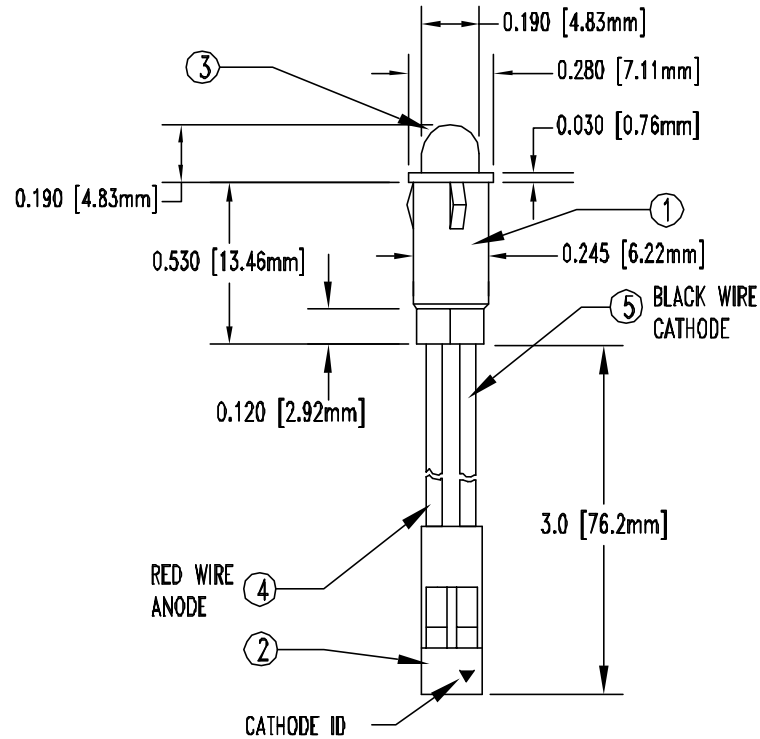
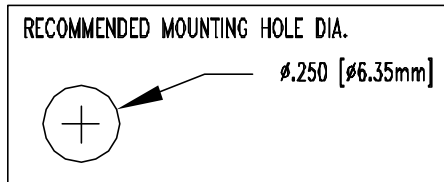

LED Part No.	Chip			Lens Appearance	Absolute Maximum Ratings				Electro-Optical Data @ 20mA			Viewing Angle (Deg.)
	Material	Emitted Color	Peak Wave Length $\lambda_P$ (nm)		$\Delta\lambda$ (nm)	Pd (mW)	If (Typ) (mA)	Peak (If) (mA)	Vf (V)		Iv (mcd)	
5SGT	GaP	SUPER GREEN	568	TINTED	30	100	30	150	Typ.	Max.	Typ.	20

### ABSOLUTE MAXIMUM RATINGS ( $T_a=25^\circ\text{C}$ )

REVERSE VOLTAGE \_\_\_\_\_ 5V

REVERSE CURRENT ( $V_R=5V$ ) \_\_\_\_\_ 100 $\mu$ A

OPERATING TEMPERATURE RANGE \_\_\_\_\_  $-25^\circ\text{C} \sim 85^\circ\text{C}$

STORAGE TEMPERATURE \_\_\_\_\_  $-30^\circ\text{C} \sim 100^\circ\text{C}$

LEAD SOLDERING TEMPERATURE(1/16" FROM BODY) \_\_\_\_\_  $260^\circ\text{C}$  FOR 5 SECONDS

UNLESS OTHERWISE SPECIFIED:  
DIMENSIONS ARE IN INCHES

**TOLERANCES**

DECIMALS	ANGULAR
.X $\pm .05$	X' $\pm 1^\circ$
.XX $\pm .02$	
.XXX $\pm .010$	

**Bivar®**  
4 THOMAS, IRVINE, CA.92618  
TEL: (949) 961-8808 FAX: (949) 961-3974

PART NAME:  
T-1 (5mm) PANEL MOUNT ASSEMBLY

DESIGNER DAVID GREEN	DATE 08/15/03	SIZE A	DWG NAME PM5SGTW3-CC	REV A
CHECKER M CHEN	DATE 08/15/03	SCALE 1=1	CAGE CODE 32559	SHEET 1 OF 1