

REVISIONS					
P	LR	DESCRIPTION	DATE	DMN	APVD
F		LOGO CHANGE	07APR2013	QL	KZ

**MECHANICAL:**

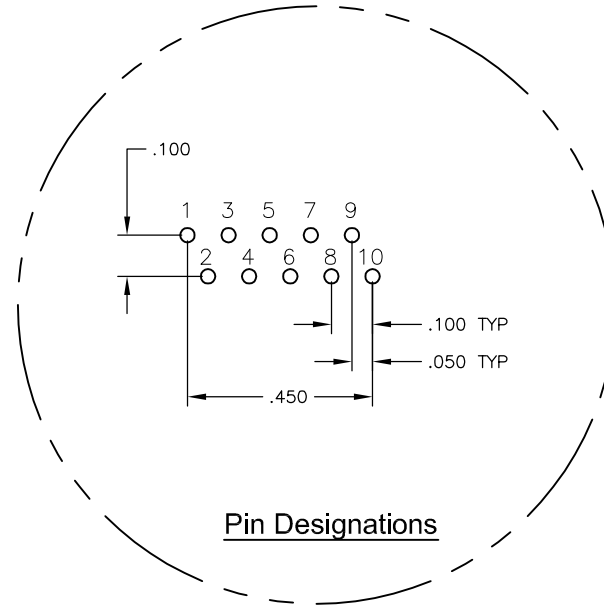
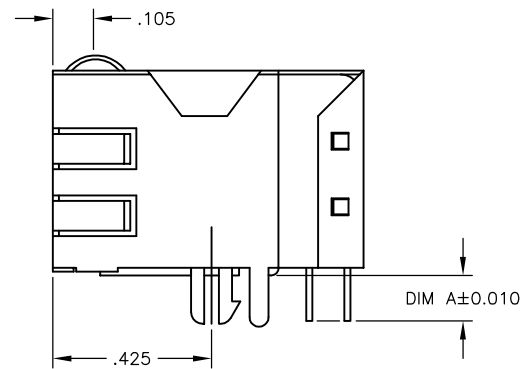
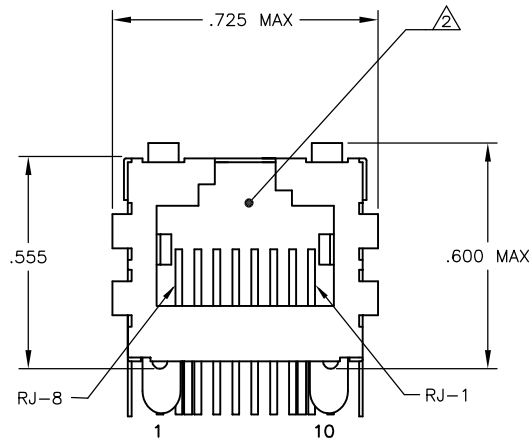
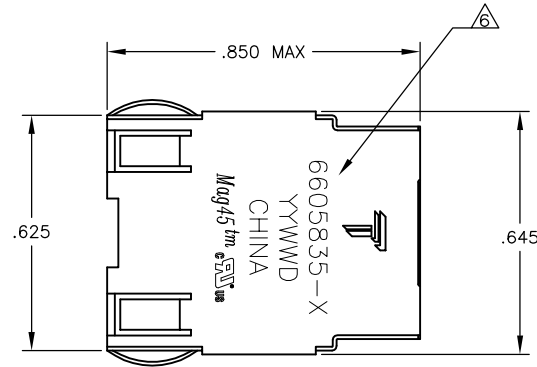

- △ MATERIALS:
  - HOUSING - THERMOPLASTIC PET(OR HIGH TEMPERATURE NYLON) POLYESTER
  - FLAMMABILITY RATING UL 94V-0.
  - SHIELD - .010" THICK, C26800 BRASS PREPLATED WITH 30μINCH MIN SEMI-BRIGHT NICKEL, SOLDER TABS POST DIPPED WITH 100μINCH MIN SAC SOLDER.
  - MOD JACK CONTACTS - 0.0157" x 0.018" PHOSPHOR BRONZE, 50μINCH MIN OVERALL NICKEL UNDERPLATE, WITH SELECT 50μINCH MIN HARD GOLD FINISH PLATE.
  - SOLDERTAILS WITH 100μINCH MIN MATTE TIN AND/OR SAC SOLDER DIP.
- △ RJ45 JACK CAVITY CONFORMS TO FCC RULES AND REGULATIONS PART 68, SUB PART F.
- △ MAGNETICS
  - IMPEDANCE: 100 OHMS
  - TURNS RATIO (CHIP: CABLE): 1:1 ALL FOUR PAIRS
  - OPEN CIRCUIT INDUCTANCE (OCL): 350mH MIN @100kHz, 0.1VRMS, 8mADC BIAS FROM 0°C TO 70°C, ALL FOUR PAIRS
  - ALL FOUR PAIRS BI-DIRECTIONAL
  - PERFORMANCE @ 25°C:
    - INSERTION LOSS (IL): 1.1dB MAX FROM 0.5MHz TO 100MHz
    - RETURN LOSS (RL): 18dB MIN FROM 0.5MHz TO 40MHz
    - 12-20LOG(f/80)dB MIN FROM 40.1MHz TO 100MHz
    - CROSSTALK ATTENUATION: 35dB MIN FROM 0.5MHz TO 40MHz
    - 33-20xLOG(f/50)dB MIN FROM 40.1MHz TO 100MHz
    - COMMON MODE REJECTION RATIO (CMRR): 30dB MIN FROM 0.5MHz TO 100MHz
    - ISOLATION VOLTAGE: 2250VDC (MAX) FOR 60 SECONDS WITH A RISE TIME OF 500V/SEC.
- 4. OPERATING TEMPERATURE: FROM 0°C TO +70°C.
- △ THE MAGNETICS ARE SYMMETRIC, AND SUPPORT AUTO-MDI/MDIX.
- △ TRP CONNECTOR LOGO, PART NUMBER, DATE CODE, COUNTRY OF ORIGIN AND AGENCY APPROVAL MARKING IN APPROXIMATE LOCATION SHOWN.
- 7. THE PART IS RECOMMENDED FOR WAVE SOLDERING PROCESS, PREHEAT TEMPERATURE IS 120°C TO 160°C, 120 SECONDS TO 180 SECONDS, PEAK SOLDERING TEMPERATURE IS 260 °C MAX, 10 SECONDS MAX.

**ELECTRICAL:**  
 7G05 SERIES GIGABIT CIRCUIT △ 3 △ 5

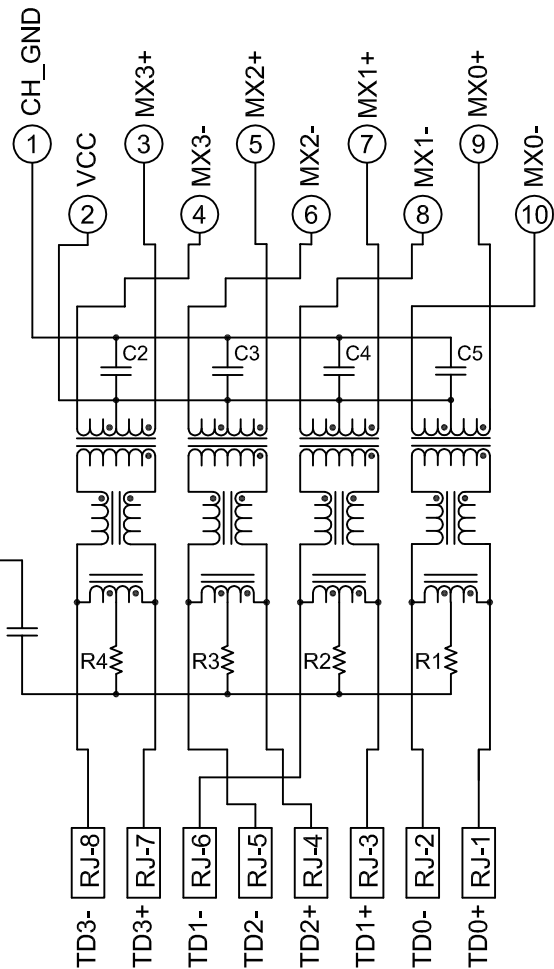

C1 = 1000pF, 2kV, CAPACITOR  
 R1-R4 = 75 OHMS, 1/16W RESISTORS  
 C2-C5 = 0.1uF, 50V, X7R CAPACITORS

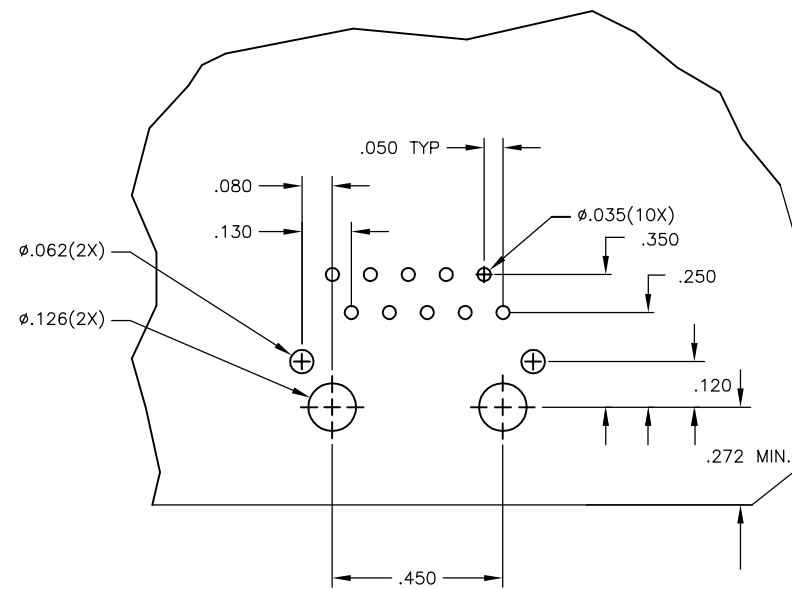
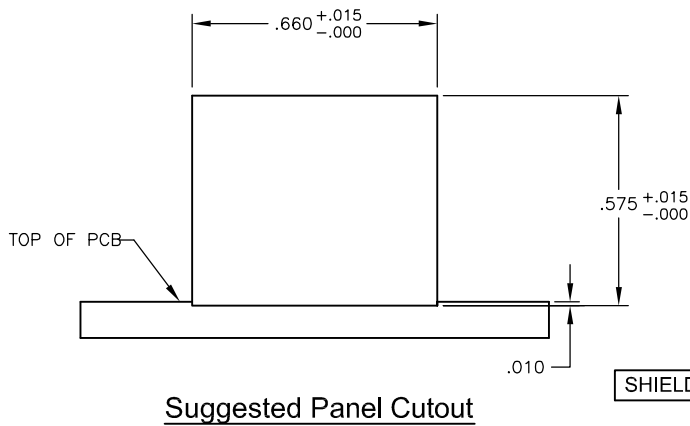

**Suggested PCB Layout**  
 (Component Side)

0.090	NORMAL TEMPERATURE	1-6605835-1
0.145	HIGH TEMPERATURE	6605835-2
0.145	NORMAL TEMPERATURE	6605835-1
DIM A	HOUSING MATERIAL	PART NUMBER

THIS DRAWING IS A CONTROLLED DOCUMENT.

DMN: L. VARELA - DOCKS	DATE: 04MAR2005
CHK: D. FAROLE	DATE: 04MAR2005
APVD: D. FAROLE	DATE: 04MAR2005

NAME: 1X1 MAG45(TM), MODULAR JACK, SHIELDED, DECOUPLING CAPACITOR, NO LEDS  
 APPLICATION SPEC: 108-2100  
 SIZE: A1  
 WEIGHT: -  
 CUSTOMER DRAWING: 100779  
 SCALE: NTS  
 SHEET: 1 OF 1  
 REV: F