

Stepping Motors

M35SP-11NK

OUTLINE

The thinnest model in MITSUMI's lineup.
High resolution and high response even in $\phi 35$.

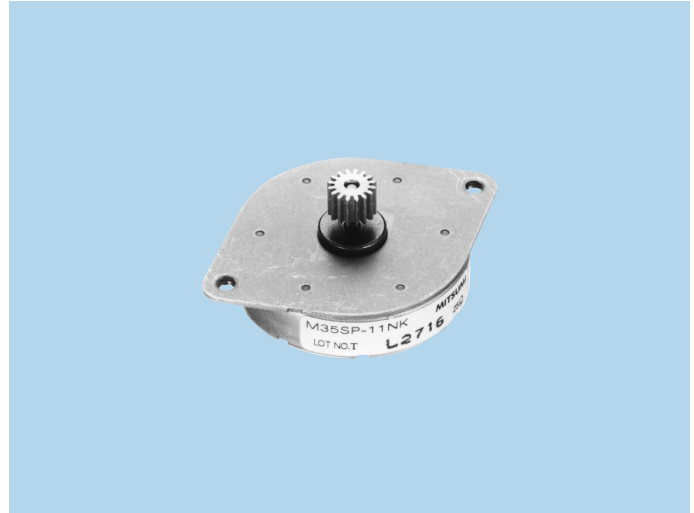

FEATURES

1. Thin, high resolution and high-output torque.
2. Superior running quietness and stability.

USES

Multifunction machines, scanners, etc.

SPECIFICATIONS

Item	M35SP-11NK	
Rated Voltage	DC 12V	DC 24V
Working Voltage	DC 10.8~13.2V	DC 21.6~26.4V
Rated Current/Phase	200mA(PEAK)	300mA(PEAK)
No. of Phase	2 Phase	
Coil DC Resistance	25Ω/phase±7%	
Step Angle	3.75°/step	
Excitation Method	2-2 Phase excitation (Bipolar driving)	
Insulation Class	Class E insulation	
Holding Torque	14.7mN·m	20.0mN·m
Pull-out Torque	8.90mN·m/1,200pps	12.1mN·m/1,800pps
Pull-in Torque	10.8mN·m/400pps	13.8mN·m/600pps
Max. Pull-out Pulse Rate	1,900pps	3,300pps
Max. Pull-in Pulse Rate	920pps	1,250pps

CHARACTERISTICS

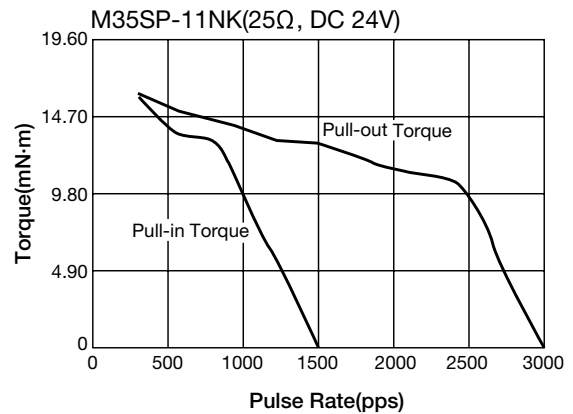
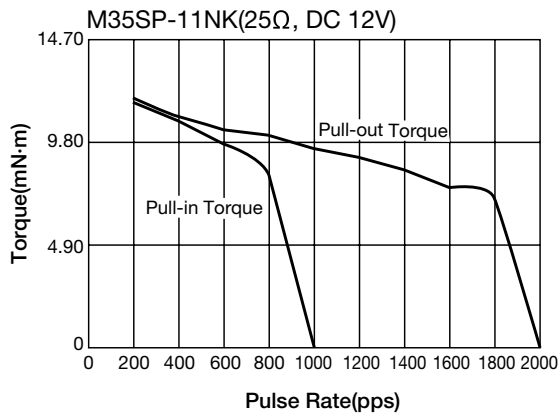

DIMENSIONS

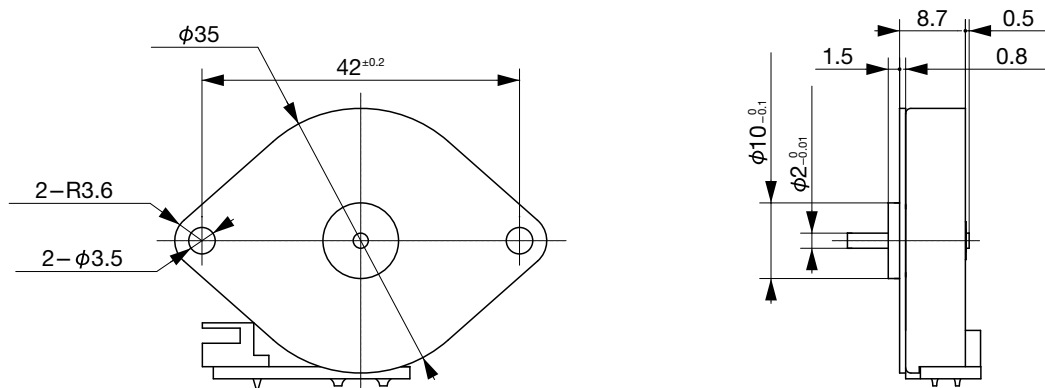

Unit : mm, General tolerance : ±0.5