

DC Mini-Motors M25N-2 Series

APPLICATIONS

Printer



SPECIFICATIONS

Items	Specifications
Rated Voltage	31.0V
Voltage Range	28.0~34.0V
Rated Load	23.4mN·m
No Load Speed	11,000rpm
No Load Current	100mA or less
Starting Torque	68mN·m
Rotation	CW/CCW

*Characteristics and the shaft length can be customized. Encoder is available as options.

CHARACTERISTICS

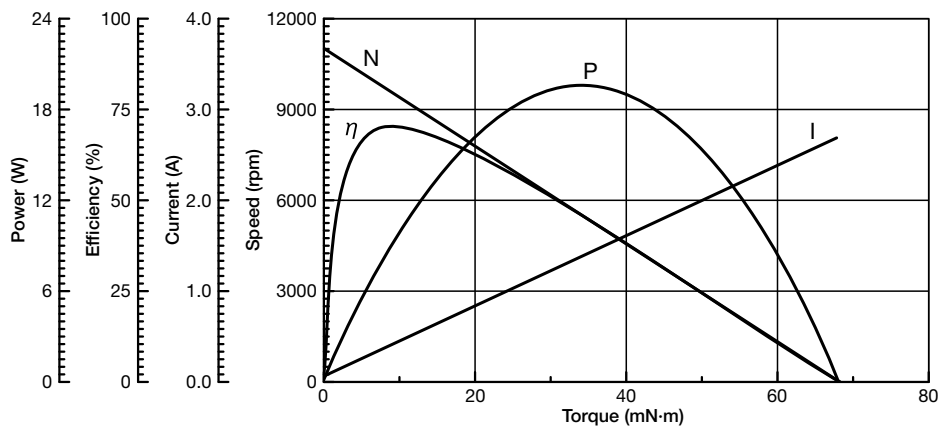

DIMENSIONS

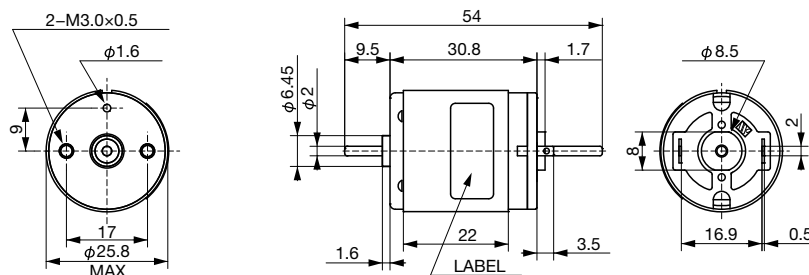

Unit : mm