



Silicon Bipolar Low Noise Microwave Transistors

MP42001

Features

- Low Noise Figure (.8dB Typical @ 60 MHz)
- Large Dynamic Range (+25dBm @ 1Db Compression Point)
- Gold Metalization
- Hermetic and Surface Mount Packages Available
- Can be Screened to JANTX, JANTXV Equivalent Levels
- Low 1/f Noise (1.0dB Typical @ 10 KHz)

Description

This series of NPN silicon transistors is designed to provide the low noise figure at frequencies from 10 to 1000 MHz. These transistors exhibit excellent noise figure vs. current characteristics which results in extremely low noise and wide dynamic range performance. These transistors find wide application in sophisticated radar and communications equipment at VHF/UHF.

Applications

The MP42001 family of bipolar NPN transistors can be used for low noise, high associated gain. large dynamic range amplifiers up to approximately 1.0 GHz. These transistors can also be used as preamplifier or driver stages in the same frequency range.

Case Styles

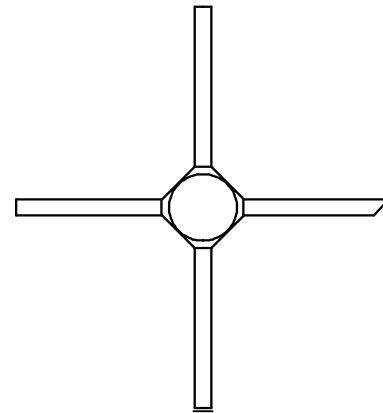

Micro-X

Specification Subject to Change Without Notice

M-Pulse Microwave
576 Charcot Avenue, San Jose, California 95131

Tel (408) 432-1480

Fax (408) 432-3440

Absolute Maximum Ratings
MP42001 Series

Collector-Base Voltage	V_{CB0}	20 V
Collector-Emitter Voltage	V_{CE0}	15 V
Emitter-Base Voltage	V_{EB0}	1.5 V
Collector Current	I_C	125 mA
Junction Operating Temperature	T_j	200°C
Storage Temperature Chip or Ceramic Packages Plastic Packages		-65°C to +200°C -65°C to +125°C
Total Power Dissipation at 25°C		
509 Case Style		450 mW
510 Case Style		1.2 W
35 Case Style		750 mW

Electrical Specifications @ 25°C
MP42001 Series

Parameter of Test	Condition	Symbol	Units	MP4200100 Chip	MP4200135 Micro-X	MP42001-509 TO-72
Gain Bandwidth Product	$V_{CE} = 10$ volts $I_C = 35$ mA	f_T	GHz	2.3 typ	1.5 typ	1.5 typ
Insertion Power Gain	$V_{CE} = 10$ volts $I_C = 28$ mA $f = 100$ MHz $f = 450$ MHz	$ S_{21E} ^2$	dB	30 typ 16 typ	29 typ 14 min	26 typ 12 min
Noise Figure	$V_{CE} = 10$ volts $I_C = 5$ mA $f = 60$ MHz $f = 450$ GHz	NF	dB	1.2 typ 1.7 typ	1.4 typ 1.9 typ	1.5 typ 2.3 typ
Unilateral Gain	$V_{CE} = 10$ volts $I_C = 5$ mA $f = 60$ MHz	GTU (max)	dB	30 typ	28 typ	28 typ
Power Out at 1 dB Compression $Z=50$ Ohms	$V_{CE} = 10$ volts $I_C = 10$ mA $f = 60$ MHz $f = 450$ MHz	P_{1dB}	dBm	N/A N/A	+5 typ +2 typ	+7 typ +4 typ

Specification Subject to Change Without Notice

Electrical Specifications @ 25°C
MP42001 Series

Parameter	Condition	Symbol	Min	Typical	Max	Units
Collector Cut-off Current	$V_{CB} = 10$ volts $I_E = 0 \mu A$	I_{CBO}	—	—	10	nA
Emitter Cut-off Current	$V_{EB} = 1$ volt $I_C = 0 \mu A$	I_{EBO}	—	—	1	μA
Forward Current Gain	$V_{CE} = 8$ volts $I_C = 7$ mA	h_{FE}	30	125	250	—
Collector-Base Junction Capacitance	$V_{CB} = 15$ volts $f = 1$ MHz	C_{CB}	—	----	1.7 1.3 1.2	pF (509) pF (510) pF (511)

Typical Scattering Parameters in the TO-72 Can Package
MP42001-509, $V_{CE} = 10$ Volts, $I_C = 5$ mA

Frequency (MHz)	S_{11E}		S_{21E}		S_{12E}		S_{22E}	
	Mag.	Angle	Mag.	Angle	Mag.	Angle	Mag	Angle
110	0.667	-83	8.74	122.6	0.040	48.9	0.765	-21.7
200	0.551	-116	6.02	104.7	0.054	45.7	0.649	-25.8
300	0.496	-138	4.32	92.4	0.064	48.1	0.597	-28.4
400	0.475	-155	3.45	83.1	0.070	50.9	0.578	-30.7
500	0.466	-167	2.79	75.0	0.080	55.8	0.570	-32.4
600	0.467	-178	2.38	69.1	0.088	59.9	0.551	-35.6
700	0.470	174	2.13	62.1	0.098	63.3	0.528	-38.6
800	0.474	167	1.87	57.3	0.114	65.4	0.511	-44.3
900	0.469	161	1.72	52.4	0.127	67.1	0.506	-50.4
1000	0.464	153	1.58	46.3	0.145	70.0	0.503	-56.4

MP42001-510, $V_{CE} = 10$ Volts, $I_C = 60$ mA

Frequency (MHz)	S_{11E}		S_{21E}		S_{12E}		S_{22E}	
	Mag.	Angle	Mag.	Angle	Mag.	Angle	Mag	Angle
100	0.76	-143	30.01	111	0.01	45	0.49	-30
200	0.80	-164	14.54	96	0.01	43	0.34	-22
300	0.81	-174	8.81	86	0.02	46	0.32	-20
400	0.82	-178	6.38	80	0.02	50	0.31	-21
500	0.84	178	4.92	75	0.02	56	0.31	-23
600	0.82	174	4.11	68	0.03	59	0.32	-26
700	0.82	172	3.38	63	0.03	63	0.32	-29
800	0.85	168	2.82	58	0.03	61	0.33	-33
900	0.92	172	2.32	59	0.03	64	0.34	-37
1000	0.83	162	2.28	49	0.04	64	0.35	-40

Specification Subject to Change Without Notice

Performance Curves

Specification Subject to Change Without Notice

M-Pulse Microwave
576 Charcot Avenue, San Jose, California 95131

Tel (408) 432-1480

Fax (408) 432-3440

Case Styles

**MP4200135
Micro-X**

Specification Subject to Change Without Notice

M-Pulse Microwave
576 Charcot Avenue, San Jose, California 95131

Tel (408) 432-1480

Fax (408) 432-3440

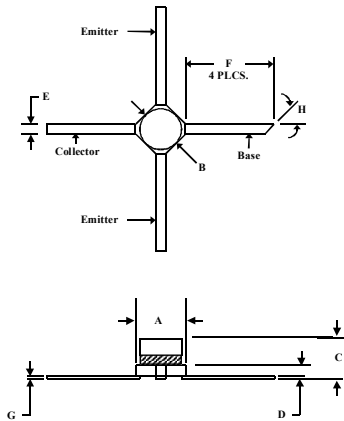

MP4200135

DIM.	INCHES		MILLIMETERS	
	MIN.	MAX.	MIN.	MAX.
A	0.092	0.108	2.34	2.74
B	0.079	0.087	2.01	2.21
C	—	0.070	—	1.78
D	0.019	0.025	0.48	0.64
E	0.018	0.022	0.46	0.56
F	0.150	—	3.81	—
G	0.003	0.006	0.08	0.15
H	45°		45°	

MP42001-509
TO-72

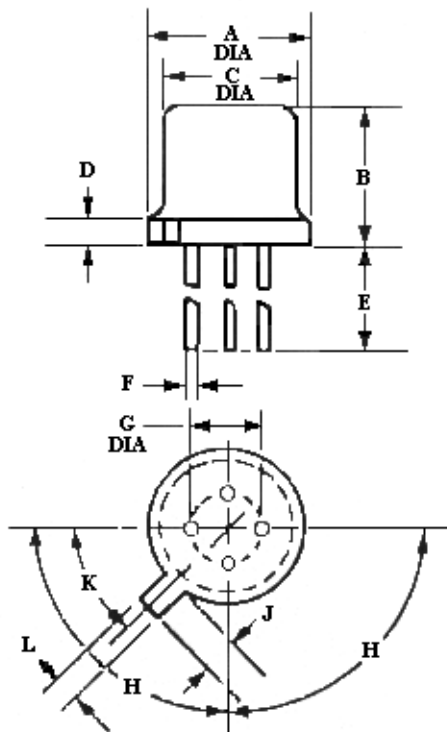

MP42001-509

DIM	INCHES		MILLIMETERS	
	MIN.	MAX.	MIN.	MAX.
A	0.350	0.370	8,89	9,40
B	0.240	0.260	6,11	6,60
C	0.315	0.335	8,00	8,51
D	—	0.040	—	1,02
E	0.500	—	12,70	—
F	0.016	0.021	0,41	0,53
G	0.190	0.210	4,83	5,33
H	89 DEG	91 DEG	89 DEG	91 DEG
J	0.029	0.043	0,74	1,09
K	43 DEG	47 DEG	43 DEG	47 DEG
L	0.028	0.034	0,71	0,86

Specification Subject to Change Without Notice

Case Styles (Cont'd)

Specification Subject to Change Without Notice

M-Pulse Microwave
576 Charcot Avenue, San Jose, California 95131

Tel (408) 432-1480

Fax (408) 432-3440