

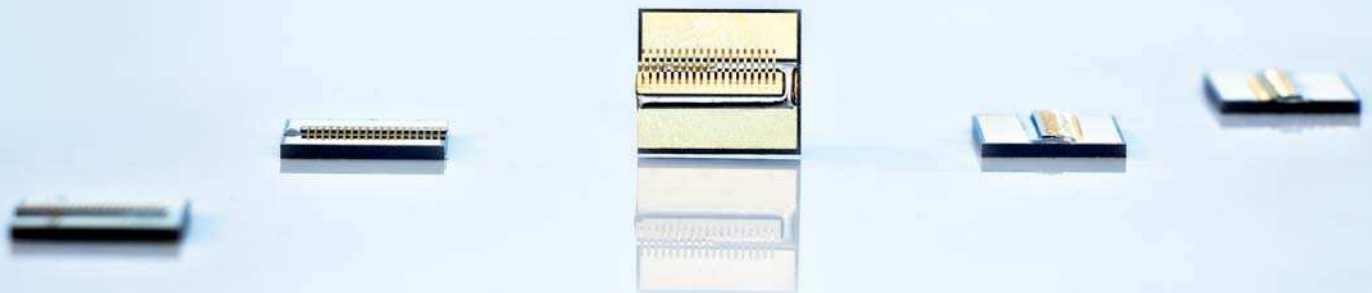

## Single Emitter Diode Lasers

cw, passively cooled



JOLD-8-BAS-1E

### Features:

- High optical output power of 8 W cw
- High efficiency, low divergences
- Lifetime > 10,000 h, high reliability

Design 215712124

### Applications:

- Pumping of solid-state lasers
- Print applications

# Single Emitter Diode Lasers

cw, passively cooled

## Specifications (Start of Life)

Product	JOLD-8-BAS-1E, Design 215712124	
Operation Mode	cw	
Maximum Optical Output Power	8	W
Emitter Width	200	µm
Center Wavelength at 25 °C	808	nm
Center Wavelength Variation at 25 °C	4	nm
Typical Spectral Bandwidth (FWHM)	3	nm
Maximum Spectral Bandwidth (FWHM)	5	nm
Typical Operation Current	8.5	A
Maximum Operation Current	10	A
Typical Threshold Current	1.2	A
Maximum Threshold Current	1.5	A
Typical Slope	1.1	W/A
Minimum Slope	0.9	W/A
Maximum Operating Voltage	2	V
Typical Fast Axis Divergence FWHM	25	°
Typical Fast Axis Divergence 95 %	47	°
Typical Slow Axis Divergence FWHM	8	°
Typical Slow Axis Divergence 95 %	10	°
Anode, Cathode Connectors	Via bond	
Operation Conditions	Cleanroom class 100, non-condensing atmosphere	
Expected Lifetime	> 10,000 h (constant current), under qualification	

### Cooling:

Mounting	To be soldered (< 280 °C) on cooled surface
Note	<b>Do not mount via any paste-like media!</b>
Operation Temperature	15 ... 30 °C heatsink temperature <b>See General User Information!</b>

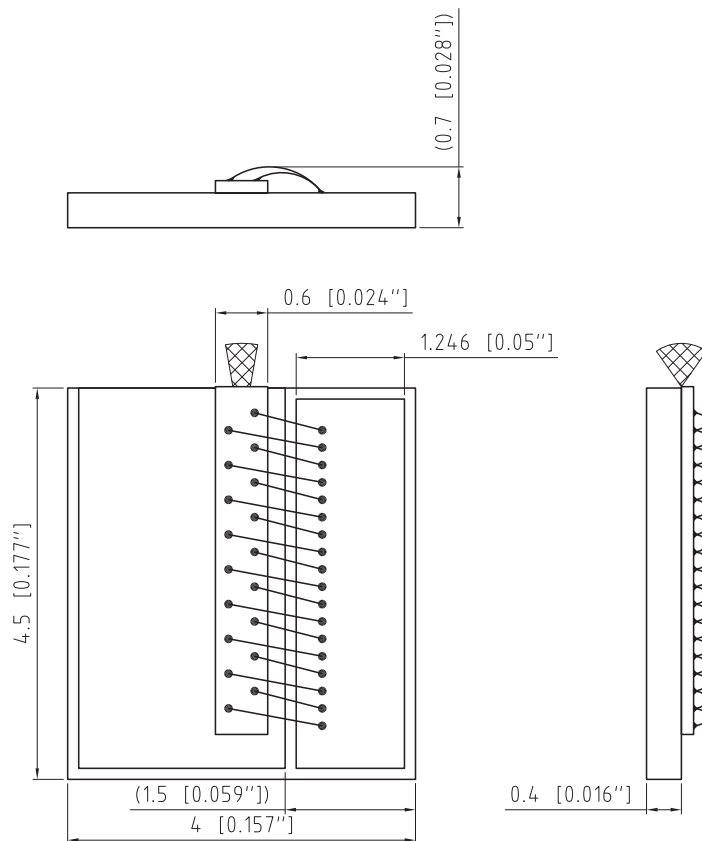

JENOPTIK | Lasers & Material Processing

JENOPTIK Laser GmbH

Goeschitzer Strasse 29 | 07745 Jena | Germany

Phone: +49 3641 65-3053 | Fax: +49 3641 65-4011

E-mail: sales-laser.lm@jenoptik.com | www.jenoptik.com/diodelasers