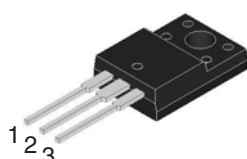
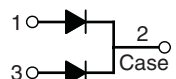

Isolated 8.0 Amp. Schottky Barrier Rectifier

<p>ITO-220AB</p>  <div style="text-align: center; margin-top: 20px;">  <p>Common Cathode Suffix "C"</p> </div>	<table style="width: 100%; border-collapse: collapse;"> <tr> <td style="text-align: center;">Voltage</td> <td style="text-align: center;">Current</td> </tr> <tr> <td style="text-align: center;">30 to 100 V</td> <td style="text-align: center;">8.0 A</td> </tr> </table> <ul style="list-style-type: none"> Plastic material used carries Underwriters Laboratory Classifications 94V-0 Metal silicon junction, majority carrier conduction Low power loss, high efficiency High current capability, low forward voltage drop High surge capability For use in low voltage, high frequency inverters, free wheeling, and polarity protection applications Guardring for overvoltage protection High temperature soldering guaranteed: 260 °C/10 seconds, 6.35mm from case. <p>MECHANICAL DATA</p> <ul style="list-style-type: none"> Cases: ITO-220AB molded plastic Terminals: Leads solderable per MIL-STD-750, Method 2026 Polarity: As marked Mounting position: Any Mounting torque: 5 in. - lbs. max Weight: 2.24 grams 	Voltage	Current	30 to 100 V	8.0 A
Voltage	Current				
30 to 100 V	8.0 A				

Absolute Maximum Ratings, according to IEC publication No. 134

		MBRF 830CT	MBRF 840CT	MBRF 850CT	MBRF 860CT	MBRF 8100CT
V_{RRM}	Maximum Recurrent Peak Reverse Voltage (V)	30	40	50	60	100
V_{RMS}	Maximum RMS voltage (V)	21	28	35	42	70
V_{DC}	Maximum DC blocking voltage (V)	30	40	50	60	100
$I_{F(AV)}$	Maximum Average Forward Rectified Current See Fig. Per Leg	8 A 4 A				
I_{FSM}	Peak Forward Surge Current, 8.3 ms Single Half Sine-wave Superimposed on Rated Load (JEDEC Method)	150 A				
T_j	Operating Junction Temperature Range	- 65 to + 150 °C				
T_{stg}	Storage Temperature Range	- 65 to + 150 °C				

Electrical Characteristics

		MBRF 830CT	MBRF 840CT	MBRF 850CT	MBRF 860CT	MBRF 8100CT
V_F	Maximum Instantaneous Forward Voltage at (Note 1) $I_F = 4 \text{ A}$, $T_c = 25 \text{ °C}$	0.55 V		0.70 V		0.80 V
I_R	Maximum Instantaneous Forward Current at Rated DC Blocking Voltage @ $T_c = 25 \text{ °C}$ @ $T_c = 125 \text{ °C}$	5.0 mA 50 mA				
R_{thj-C}	Typical Thermal Resistance Per Leg (Note 2)	6.0 °C/W				

Notes: 1. Pulse Test: 300µs Pulse Width, 1% Duty Cycle
2. Thermal Resistance from Junction to Case Per leg

Isolated 8.0 Amp. Schottky Barrier Rectifier

TYPICAL FORWARD CHARACTERISTICS

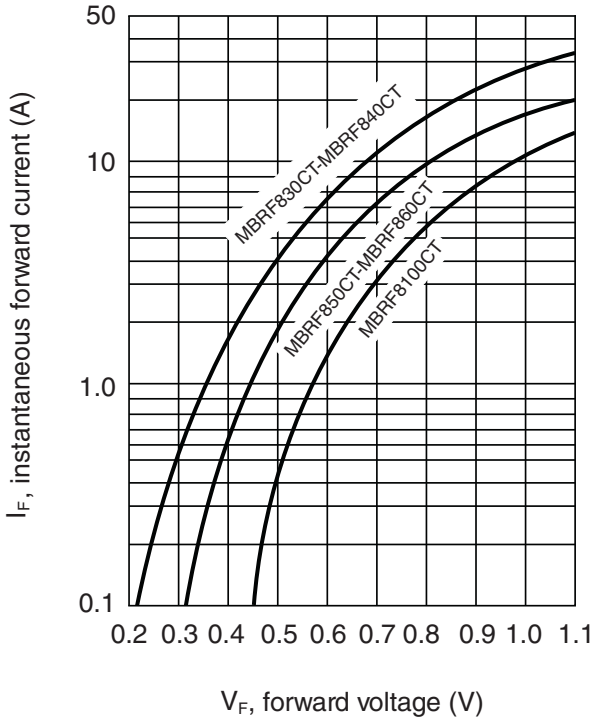

MAXIMUM FORWARD CURRENT DERATING CURVE

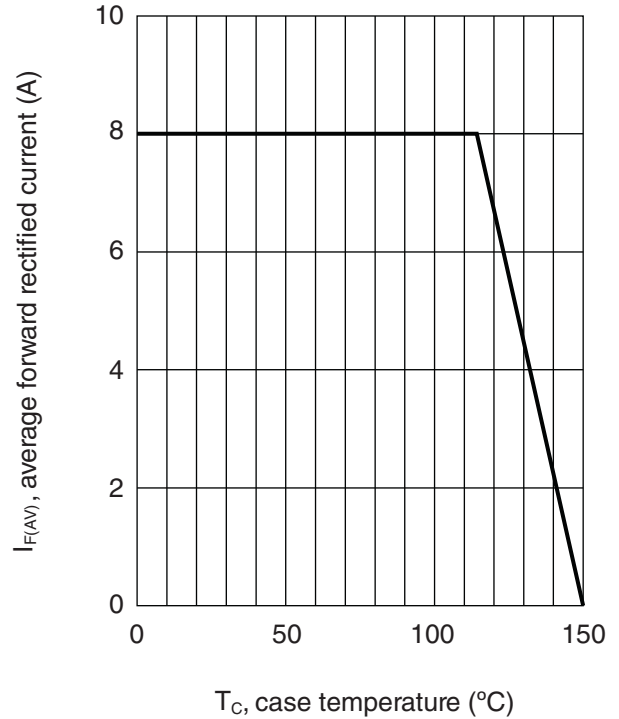

MAXIMUM NON-REPETITIVE FORWARD SURGE CURRENT

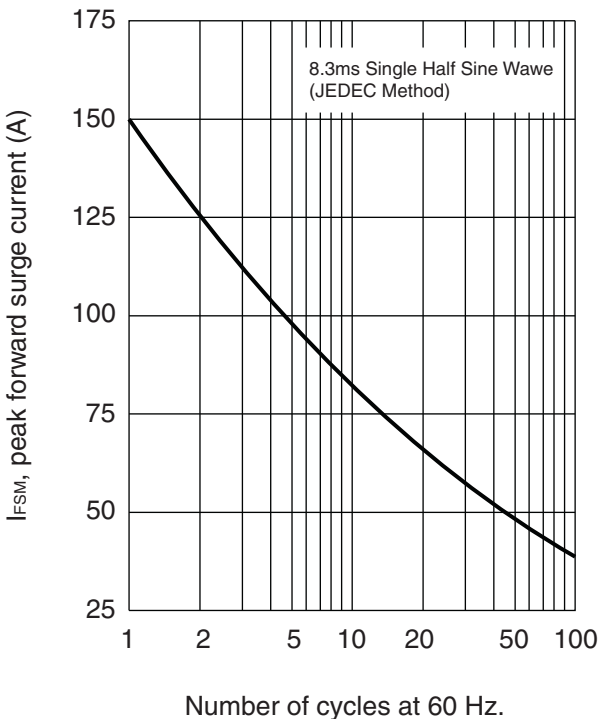

TYPICAL JUNCTION CAPACITANCE

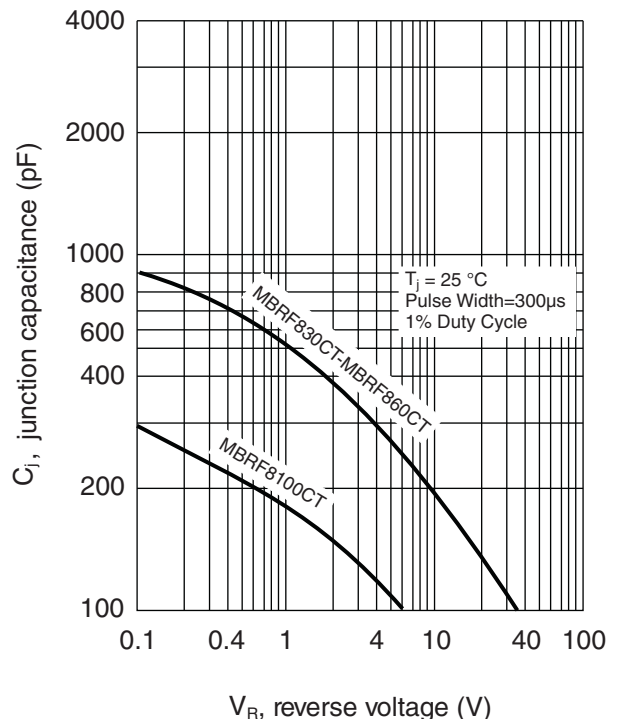

Rating And Characteristic Curves

TYPICAL REVERSE CHARACTERISTICS

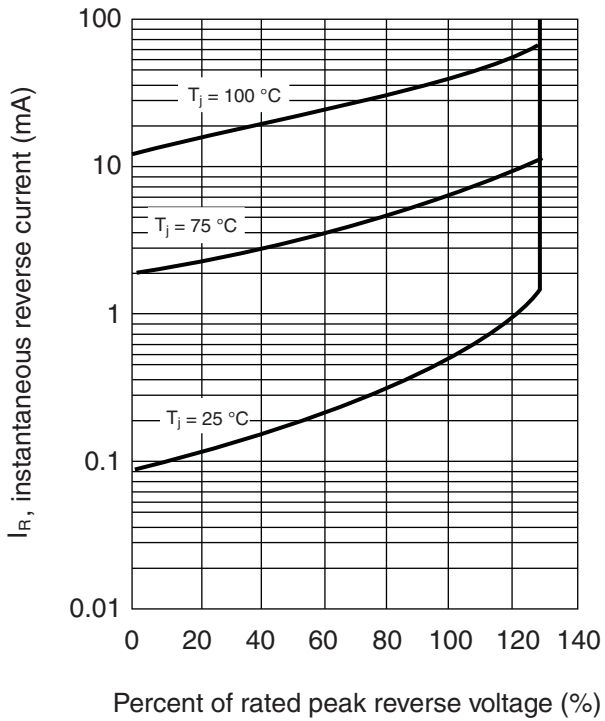

PACKAGE MECHANICAL DATA ITO-220AB

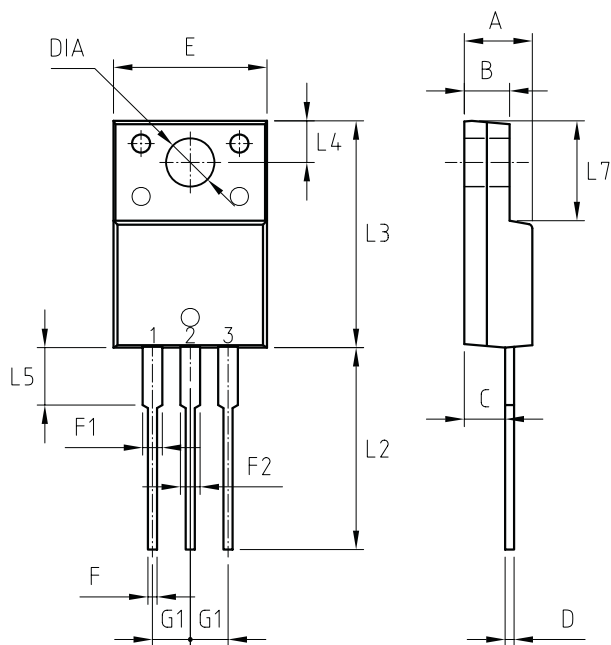

REF.	DIMENSIONS		
	Milimeters		
	Min.	Nominal	Max.
A	4.4	-	4.7
B	3.0	-	3.16
C	2.5	-	2.8
D	0.5	-	0.76
E	9.9	-	10.3
F	0.5	-	0.9
F1	1.1	-	1.4
F2	-	-	1.8
G1	2.4	2.55	2.7
L2	13.2	-	13.8
L3	14.8	-	15.5
L4	2.55	-	2.85
L5	3.7	-	4.1
L7	6.3	-	6.9
DIA	3.0	-	3.4