

1A Avg.

30 Volts

SBD

11DQ03L

■最大定格 Maximum Ratings

Item	Symbol	Conditions	Unit
くり返しピーク逆電圧 Repetitive Peak Reverse Voltage	$V_{RRM}$	30	V
平均整流電流 Average Rectified Forward Current	$I_O$	50Hz, 正弦半波通電抵抗負荷 50Hz Half Sine Wave Resistive Load	1.0 1.0
実効順電流 R.M.S. Forward Current	$I_F(RMS)$		1.57
サージ順電流 Surge Forward Current	$I_{FSM}$	40 50Hz正弦半波, 1サイクル, 非くり返し 50Hz Half Sine Wave, 1cycle, Non-repetitive	A
動作接合温度範囲 Operating Junction Temperature Range	$T_{jw}$		-40~+150
保存温度範囲 Storage Temperature Range	$T_{stg}$		-40~+150

■OUTLINE DRAWING(mm)

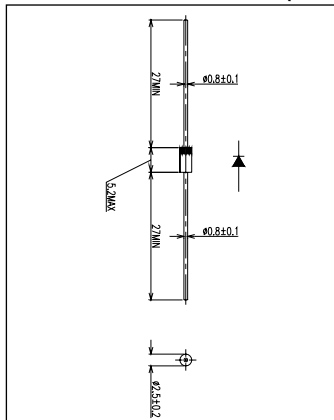

■電氣的・熱的特性 Electrical/Thermal Characteristics

Item	Symbol	Conditions	Min.	Typ.	Max.	Unit
ピーク逆電流 Peak Reverse Current	$I_{RM}$	$T_j=25^{\circ}C, V_{RM}=V_{RRM}$	—	—	1	mA
ピーク順電圧 Peak Forward Voltage	$V_{FM}$	$T_j=25^{\circ}C, I_{FM}=1A$	—	—	0.45	V
熱抵抗 Thermal Resistance	$R_{th(j-a)}$	接合部・周囲間 Junction to Ambient	—	—	130	$^{\circ}C/W$
			—	—	81	$^{\circ}C/W$

\*1: 単体フィン無し/ Without Fin or P.C. Board  
\*2: プリント基板実装 / P.C. Board Mounted (L=8mm, Print Lands=10×10 mm, Both Sides)

■定格・特性曲線

