

M2 x 0.4 TAP x  $\frac{4.0}{.157}$  DP.  
 (4) HOLES ON A  $\frac{20.6}{.811}$  DIA. CIRCLE

Millimeters  
 Inches

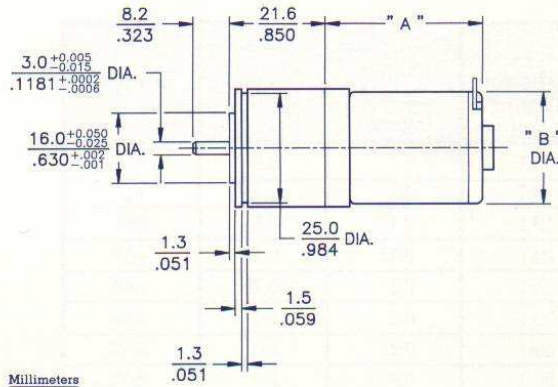

**230 DC  
 Gear Motor**

**Features:**

Small size, lightweight and compact design • Input shaft and output shaft have the same center line • Decreased noise and smooth rotation due to the use of high-precision gears • Coreless motor design • Options available, see Options section



365 E. Prairie Street  
 Crystal Lake, Illinois 60014  
 ☎ 815/459-3080 FAX: 815/459-3227  
 Toll Free: 1-800-228-6207

Model Number	Rated Voltage (VDC)	Rated Output (Watts)	Rated Load (g-cm)	Rated Speed (RPM)	Rated Current (mA)	No Load Speed (RPM)	No Load Current (mA)	"A" Dim. (mm)	"B" Dim. (mm)
230-1	12.0	0.92	30	3000	140	3600	30	41.0	25.5
230-2	24.0	0.33	10	3250	37	4260	12	35.6	25.6

## GEARHEADS

Reduction Ratio	Continuous Output Torque (kg-cm)	Momentary Output Torque (kg-cm)	Efficiency
5:1	0.1	0.5	81%
8:1	0.1	0.5	81%
10:1	0.1	0.5	81%
20:1	0.15	0.75	66%
25:1	0.15	0.75	66%
30:1	0.2	1.0	66%
40:1	0.2	1.0	66%
50:1	0.4	2.0	66%
60:1	0.4	2.0	66%
75:1	0.4	2.0	66%
80:1	0.4	2.0	66%
90:1	0.4	2.0	66%
100:1	0.6	3.0	66%
120:1	0.6	3.0	66%
150:1	0.6	3.0	66%
200:1	0.6	3.0	53%
300:1	1.0	5.0	53%
500:1	1.0	5.0	53%
750:1	1.0	5.0	53%
1000:1	1.0	5.0	53%
1200:1	1.0	5.0	53%
1500:1	1.0	5.0	53%
2000:1	0.6	3.0	43%
3000:1	0.6	3.0	43%
3600:1	0.6	3.0	43%
6000:1	0.6	3.0	43%

230-1 (12.0 VDC)

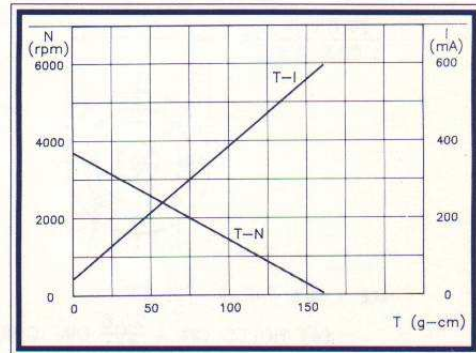

230-2 (24.0 VDC)

