

## SILICON EPITAXIAL POWER TRANSISTORS

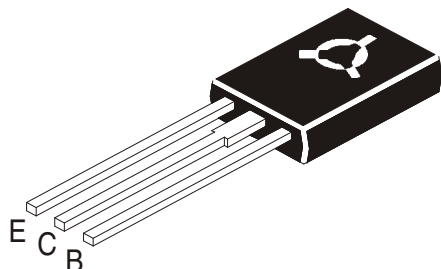

**BD131**      **NPN**  
**BD132**      **PNP**

**TO-126**  
**Plastic Package**

### General Purpose Medium Power Applications

#### ABSOLUTE MAXIMUM RATINGS

| DESCRIPTION   | SYMBOL    | BD131       | BD132 | UNIT        |
|---|-----------|-------------|-------|-------------|
| Collector -Base Voltage                             | $V_{CBO}$ | 70          | 45    | V           |
| Collector -Emitter Voltage                          | $V_{CEO}$ | 45          | 45    | V           |
| Emitter-Base Voltage                                | $V_{EBO}$ | 6           | 4     | V           |
| Collector Current Continuous                        | $I_C$     | 3           |       | A           |
| Peak  | $I_{CM}$  | 6           |       | A           |
| Base Current Peak                                   | $I_{BM}$  | 0.5         |       | A           |
| Reverse Base Current Peak                           | $-I_{BM}$ | 0.5         |       | A           |
| Total Device Dissipation upto $T_{amb}=60^{\circ}C$ | $P_{tot}$ | 15          |       | W           |
| Junction Temperature                                | $T_j$     | 150         |       | $^{\circ}C$ |
| Storage Temperature Range                           | $T_{stg}$ | -65 to +150 |       | $^{\circ}C$ |

#### Thermal Resistance

|                                |                |   |     |
|--------------------------------|----------------|---|-----|
| From Junction to Mounting Base | $R_{th(j-mb)}$ | 6 | K/W |
|--------------------------------|----------------|---|-----|

#### ELECTRICAL CHARACTERISTICS ( $T_a=25^{\circ}C$ unless specified otherwise)

| DESCRIPTION                          | SYMBOL        | TEST CONDITION                                       | MIN | MAX | UNIT    |
|--------------------------------------|---------------|--|-----|-----|---------|
| Collector Cut-off Current            | $I_{CBO}$     | $V_{CB}=50V, I_E=0$ <b>BD131</b>                     |     | 50  | nA      |
|                                      |               | $V_{CB}=40V, I_E=0$ <b>BD132</b>                     |     | 50  | nA      |
|                                      |               | $V_{CB}=50V, I_E=0, T_j = 150^{\circ}C$ <b>BD131</b> |     | 10  | $\mu A$ |
|                                      |               | $V_{CB}=40V, I_E=0, T_j = 150^{\circ}C$ <b>BD132</b> |     | 10  | $\mu A$ |
| Emitter Cut-off Current              | $I_{EBO}$     | $V_{EB}=5V, I_C=0$ <b>BD131</b>                      |     | 50  | nA      |
|                                      |               | $V_{EB}=3V, I_C=0$ <b>BD132</b>                      |     | 50  | nA      |
| Collector-Emitter Saturation Voltage | $V_{CE(sat)}$ | $I_C = 0.5A, I_B = 50mA$                             |     | 0.3 | V       |
|                                      |               | $I_C = 2A, I_B = 200mA$                              |     | 0.7 | V       |
| Base-Emitter Saturation Voltage      | $V_{BE(sat)}$ | $I_C = 0.5A, I_B = 50mA$                             |     | 1.2 | V       |
|                                      |               | $I_C = 2A, I_B = 200mA$                              |     | 1.5 | V       |
| DC Current Gain                      | $h_{FE}$      | $V_{CE} = 12V, I_C = 0.5A$                           | 40  |     |         |
|                                      |               | $V_{CE} = 1V, I_C = 2A$                              | 20  |     |         |

#### Dynamic Characteristics

|  |                   |   |    |     |     |
|--|-------------------|---|----|-----|-----|
| Collector Capacitance                            | $C_C$             | $I_E = 0, V_{CB} = 5V, f = 1MHz$ <b>BD131</b>                     |    | 60  | pF  |
| Transition Frequency                             | $f_T$             | $I_C = 0.25A, V_{CE} = 5V, f = 35MHz,$<br>$T_{amb} = 25^{\circ}C$ | 60 |     | MHz |
| DC Current Gain Ratio of the Complementary Pairs | $h_{FE1}/h_{FE2}$ | $V_{CE} = 12V, I_C = 0.5A$  |    | 1.2 |     |

## TO-126 Plastic Package

### TO-126 (SOT-32) Plastic Package

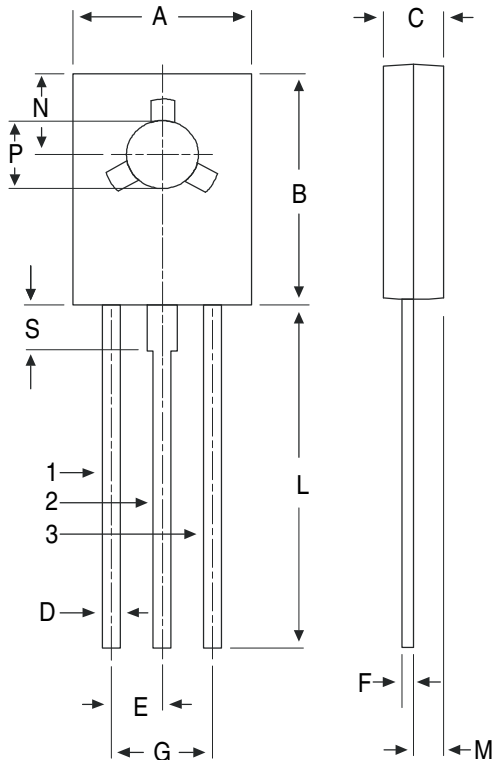

| DIM | MIN       | MAX  |
|-----|-----------|------|
| A   | 7.4       | 7.8  |
| B   | 10.5      | 10.8 |
| C   | 2.4       | 2.7  |
| D   | 0.7       | 0.9  |
| E   | 2.25 TYP. |      |
| F   | 0.49      | 0.75 |
| G   | 4.5 TYP.  |      |
| L   | 15.7 TYP. |      |
| M   | 1.27 TYP. |      |
| N   | 3.75 TYP. |      |
| P   | 3.0       | 3.2  |
| S   | 2.5 TYP.  |      |

All dimensions in mm.

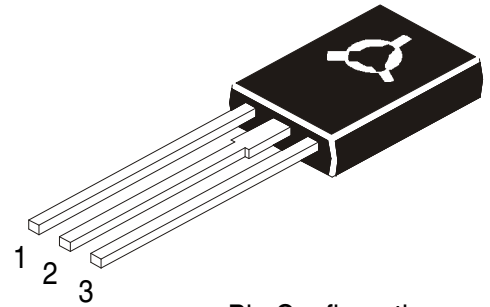

#### Pin Configuration

1. Emitter
2. Collector
3. Base

### TO-126 TUBE PACKING

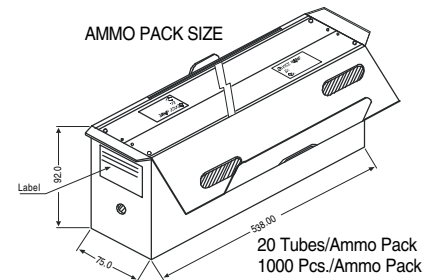
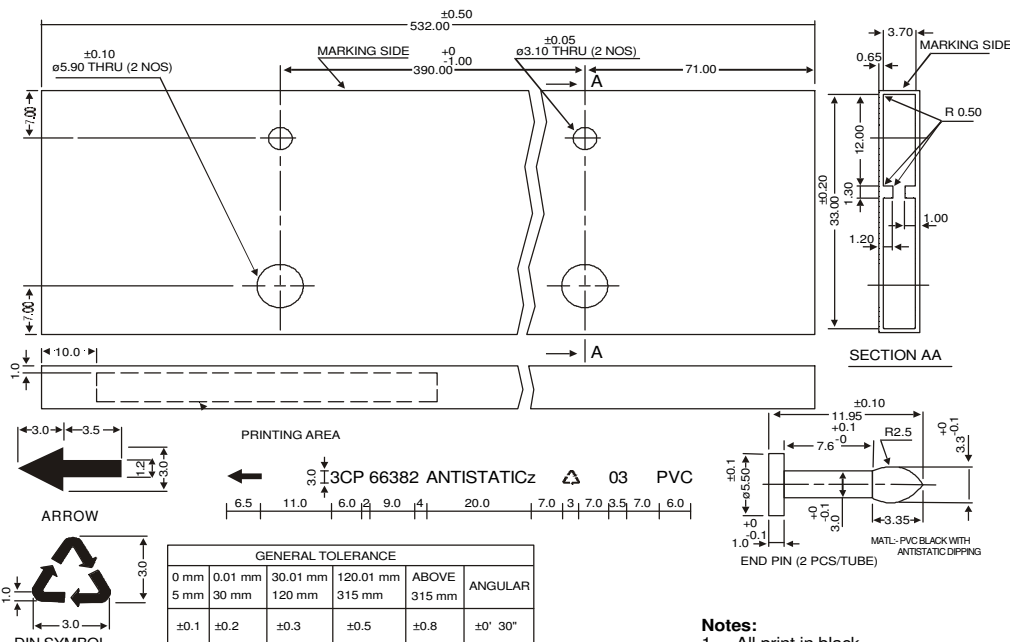

### Packing Detail

| PACKAGE     | STANDARD PACK   |                | INNER CARTON BOX  |     | OUTER CARTON BOX  |     |        |
|-------------|-----------------|----------------|-------------------|-----|-------------------|-----|--------|
|             | Details         | Net Weight/Qty | Size              | Qty | Size              | Qty | Gr Wt  |
| TO-126 Bulk | 500 pcs/polybag | 340 gm/500 pcs | 3" x 7.5" x 7.5"  | 2K  | 17" x 15" x 13.5" | 32K | 31 kgs |
| TO-126 Tube | 50 pcs/tube     | 73 gm/50 pcs   | 3" x 3.7" x 21.5" | 1K  | 19" x 19" x 19"   | 10K | 15 kgs |

BD131\_132Rev\_1 120403D

### **Disclaimer**

The product information and the selection guides facilitate selection of the CDIL's Discrete Semiconductor Device(s) best suited for application in your product(s) as per your requirement. It is recommended that you completely review our Data Sheet(s) so as to confirm that the Device(s) meet functionality parameters for your application. The information furnished in the Data Sheet and on the CDIL Web Site/CD are believed to be accurate and reliable. CDIL however, does not assume responsibility for inaccuracies or incomplete information. Furthermore, CDIL does not assume liability whatsoever, arising out of the application or use of any CDIL product; neither does it convey any license under its patent rights nor rights of others. These products are not designed for use in life saving/support appliances or systems. CDIL customers selling these products (either as individual Discrete Semiconductor Devices or incorporated in their end products), in any life saving/support appliances or systems or applications do so at their own risk and CDIL will not be responsible for any damages resulting from such sale(s).

CDIL strives for continuous improvement and reserves the right to change the specifications of its products without prior notice.



CDIL is a registered Trademark of  
Continental Device India Limited

C-120 Naraina Industrial Area, New Delhi 110 028, India.  
Telephone + 91-11-2579 6150 Fax + 91-11-2579 9569, 2579 5290  
e-mail sales@cdil.com www.cdil.com, www.cdilsemi.com