

A durable three pin panel plug, with solder lug / spade terminals. Can be mounted above the panel on any thickness of material or below the panel for up to 2,0mm thick material. Suitable for use measuring instruments, SMPS, ITE and OA.

For panel cut-out, use punch number 974-0010 (pull through) or 906-0050 (punch and die).

Weight approximately 10g.

Approvals UL, CSA and TUV.

MATERIAL

HOUSING : Nylon 66, black
UL 94 V0

CONTACTS : Brass, nickel plate

ELECTRICAL

Voltage Rating : 250 Vac
Current Rating : 10 Amps
Insulation : 1000 M Ω @500 Vac
Resistance
Withstanding Voltage : 2000 Vac for 1 minute
between line to gnd.
Temperature Range : -20°C to +80°C

Dimensions

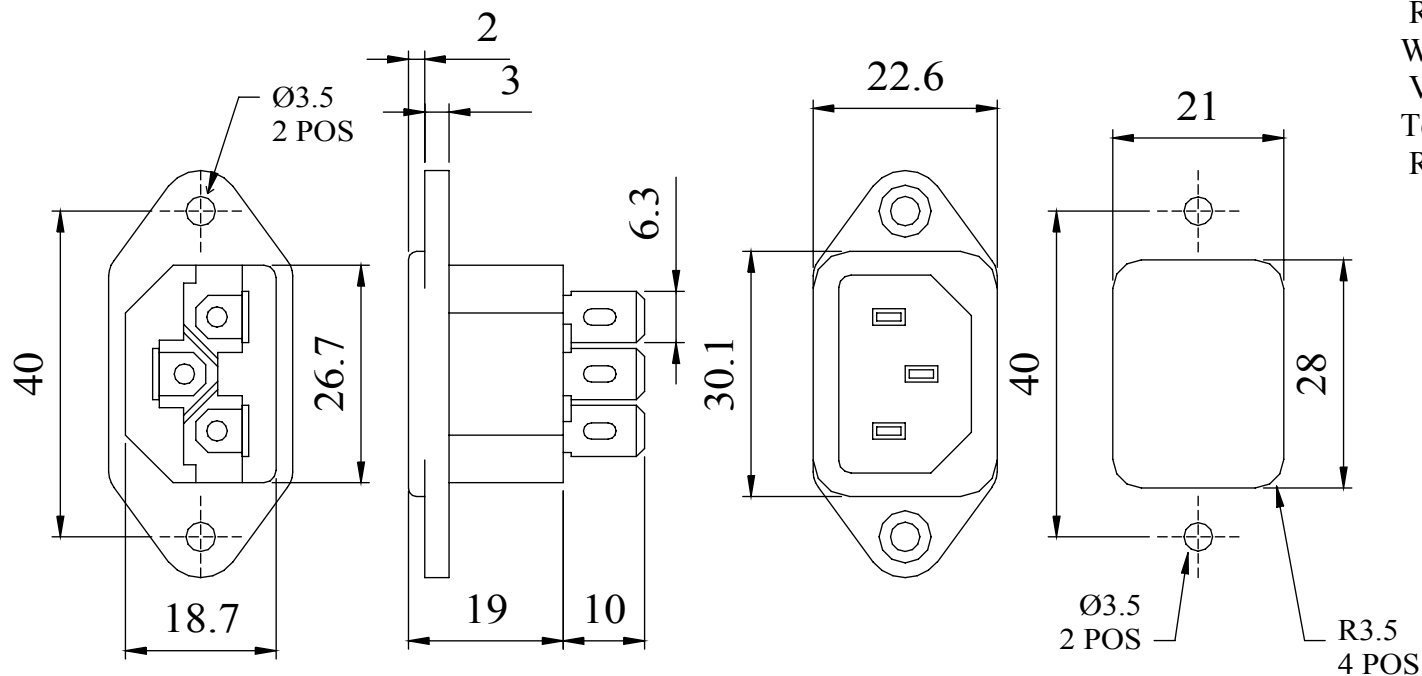

Tel No. +44(0)1724 273200 Website www.dem-uk.com



PROPRIETARY AND CONFIDENTIAL
THE INFORMATION CONTAINED IN THIS DRAWING IS THE SOLE PROPERTY OF
ALPHA 3 MANUFACTURING.
ANY REPRODUCTION IN PART OR AS A WHOLE WITHOUT THE WRITTEN PERMISSION OF
ALPHA 3 MANUFACTURING IS PROHIBITED.



UNLESS OTHERWISE SPECIFIED:
DIMENSIONS ARE IN MILLIMETRES
LINEAR TOLERANCE:
NO DECIMAL PLACES $\pm 0.5\text{mm}$
1 DECIMAL PLACE $\pm 0.25\text{mm}$
2 DECIMAL PLACES $\pm 0.125\text{mm}$
ANGULAR TOLERANCE: $\pm 1^\circ$

FINISH MAINS CONNECTOR
PANEL
PLUG

IF IN DOUBT ASK
DO NOT SCALE DRAWING

MATERIAL SEE NOTE

DEBURR AND BREAK
SHARP EDGES

DRAWN BY
APPROVED BY

THIRD ANGLE PROJECTION



SPB
WC

SHEET 1 OF 1

SCALE 1:1
A4

TITLE GENERAL SPECIFICATION
MAINS CONNECTOR
PANEL PLUG

DRAWING NO. 520-0010

ISSUE 02
Release