

YESC/YESC Kaizen Header Connection Systems

DESCRIPTION

Connector-to-PCB (Printed Circuit Board) providing power source to device

MARKET NEEDS

Increasing system functionality necessitates a method to connect the vehicle wiring to the device electronics

BENEFITS

Interfaces designed to mate with standard in-line YESC/YESC Kaizen connection systems

Many products designed in accordance with USCAR specified interface dimensions (0.64/1.5 unsealed)

Many products capable for use in High Temperature IR Reflow soldering temperatures (260°C)

Products currently available for 0.64, 1.5, 2.8, and 6.3 blade sizes

Many products available which satisfy impending Pb-free RoHS mandates

Variety of connector-to-board attachment methods available

STATUS

In production now

Structure:

0.64 mm -

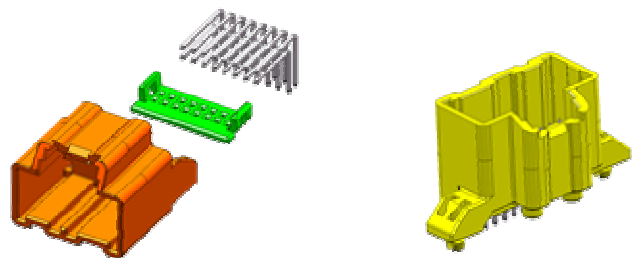

1.5 mm -

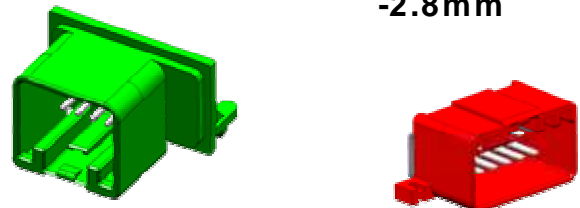

-2.8 mm

6.3 mm -

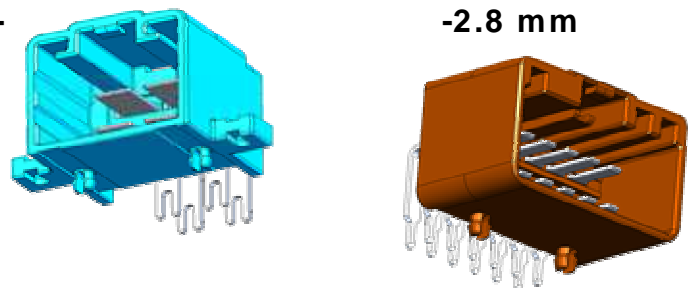

-2.8 mm

Hybrid -

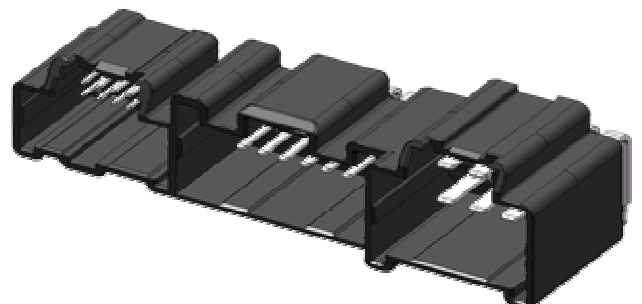

For more detailed product information email info@us.yazaki.com or call 888-942-9152 (option 5)