

CK LOCK SWITCHES

RoHS COMPLIANT

GENERAL ELECTRICAL & MECHANICAL SPECIFICATION

Switch Rating:	150mA @ 250V ac/dc
Life:	>10,000 Cycles
Operating Temperature:	-30°C to +85 °C
Proof Voltage:	1,500Vac (Initial)
Insulation Resistance:	>999 MΩ at 500Vdc (Initial)
Contact Resistance:	<20mΩ (initial)
Moulding Material:	Polyamide 6.6 G.F.
Contact/Terminal Material:	Brass CZ108 Ag Plated
Lock Housing:	Zinc Alloy Bright Cr Plated
Keys:	Mild Steel Ni plated



GENERAL FEATURES

- Made in UK.
- Moulded Single Wafer Lock switch.
- Two part construction. The lock is inserted into the panel from the front. The CK module either bracketed or snap-on, from the rear of the panel.
- Switch indexed 30°, 60° or 90°.
- All contacts are non-shorting (BBM).
- Solder or printed circuit terminals.
- Keys removable at 60° or 90° angles.
- Two keys per lock. Additional keys to order.
- Keys to pass (common combination) or differ (different combinations)

CK LOCK SWITCH MODULE TERMINAL LAYOUTS (VIEWED FROM THE KEY) POSITION1

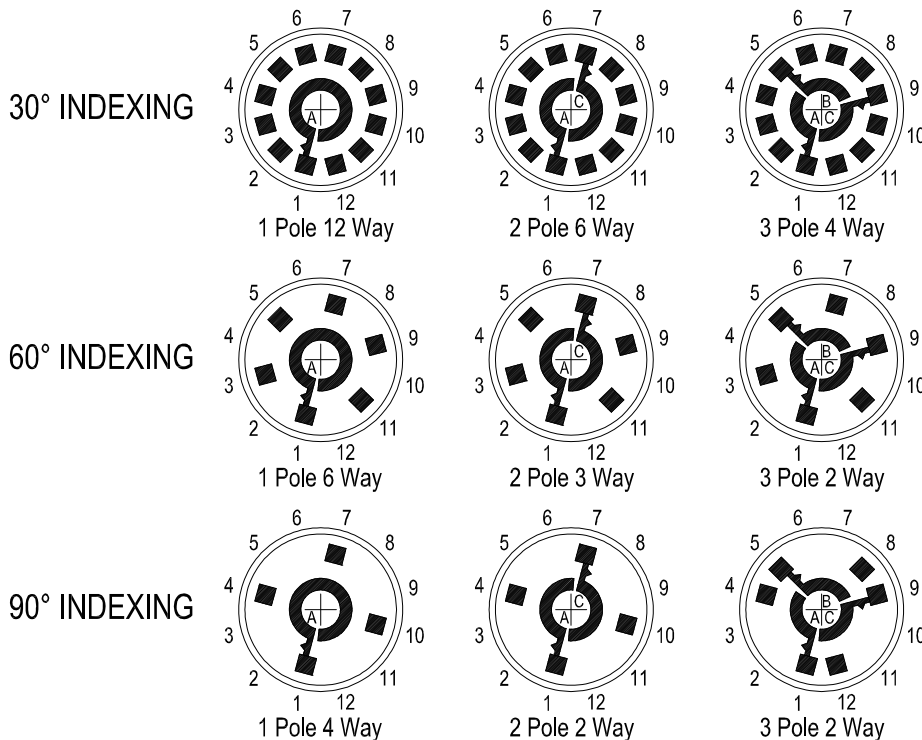

MOUNTING DETAILS CK LOCK SWITCHES

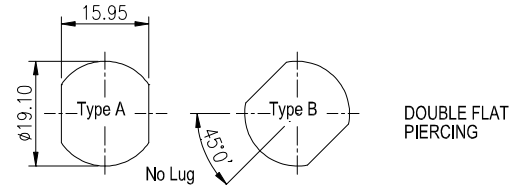

ALTERNATE MOUNTING DETAILS FOR BRACKETED CKL, CKIS LOCK SWITCHES

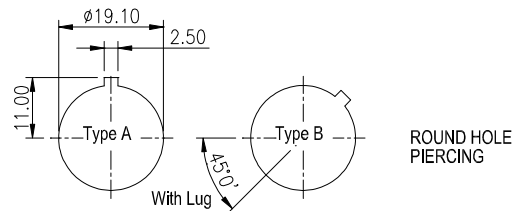

LOCK MOVEMENT

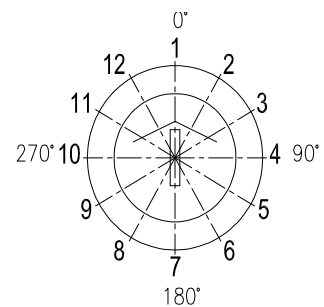

CK LOCK SWITCHES

CKL5 Lock switch with Snap on CK Module

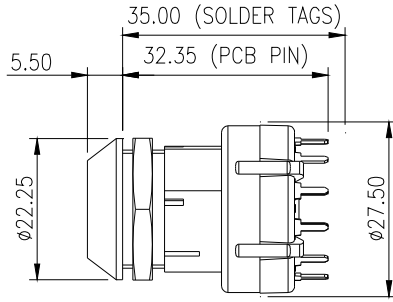

DESCRIPTION

LOCK TYPE: 5 Disc
LOCK MOVEMENT: 60° or 90° Steps.
LOCK COMBINATIONS: 200 differs or all to pass (same key for all locks).
KEY TYPE: Flat, single entry (key can be inserted into the lock only one way up).
MASTER KEY SYSTEM AVAILABLE: Yes.
MAXIMUM PANEL THICKNESS: 3.4mm.
MODULE TYPE: Snap-on
MODULE INDEXING ANGLES: 30°, 60°, 90° (keys can be inserted/withdrawn at 60° or 90° angles).

KEY CODE
S = Same
D = Differs

CONTACT
B = BBM
M = MBB (30° Index Only)

SWITCH POSITIONS
02 = 2 Positions
03 = 3 Positions
12 = 12 Positions
13 = Continuous Rotation

CONTACT PLATING
S = Silver (Standard)
G = Gold
F = Gold Flash

ORDERING CODE

Build your part number by filling in the empty boxes with the appropriate numbers and letter

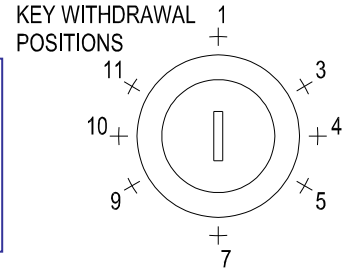

C K L 5

TOTAL LOCK MOVEMENT	KEY WITHDRAW POSITION	TOTAL LOCK MOVEMENT	KEY WITHDRAW POSITION
A = 90°	1	G = 180°	1,3,5,7
B = 90°	1,4	H = 60°	1,3
C = 180°	1,7	J = 240°	1,3,5,7,9
D = 180°	1,4,7	K = 120°	1,3,5
E = 360°	1,4,7,10	L = 270°	1,4,7,10
F = 360°	1,3,5,7,9,11	M = 300°	1,3,5,7,9,11

SWITCH INDEX ANGLE
3 = 30°
6 = 60°
9 = 90°

NUMBER OF SWITCH POLES
1 = 1 POLE
2 = 2 POLE
3 = 3 POLE
4 = 4 POLE

TERMINATION
S = SOLDER
P = PCB

CKL8 Lock switch with Snap on CK Module

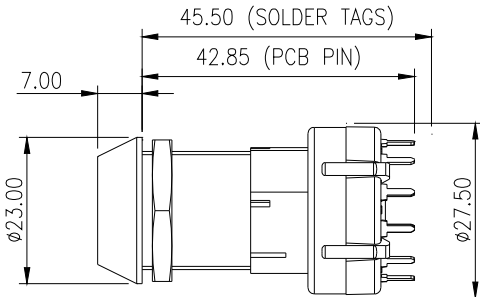

DESCRIPTION

LOCK TYPE: 8 Disc
LOCK MOVEMENT: 90° Steps.
LOCK COMBINATIONS: 2000 differs or all to pass (same key for all locks).
KEY TYPE: Flat, double entry (key can be inserted into the lock either way up).
MASTER KEY SYSTEM AVAILABLE: Yes.
MAXIMUM PANEL THICKNESS: 13.9mm.
MODULE TYPE: Snap-on
MODULE INDEXING ANGLES: 30°, 60°, 90° (but keys can only be inserted/withdrawn at 90° angles).

KEY CODE
S = Same
D = Differs

CONTACT
B = BBM
M = MBB (30° Index Only)

SWITCH POSITIONS
02 = 2 Positions
03 = 3 Positions
12 = 12 Positions
13 = Continuous Rotation

CONTACT PLATING
S = Silver (Standard)
G = Gold
F = Gold Flash

ORDERING CODE

Build your part number by filling in the empty boxes with the appropriate numbers and letter

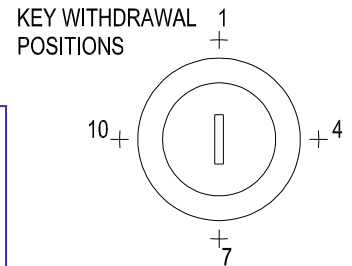

C K L 8

TOTAL LOCK MOVEMENT	KEY WITHDRAW POSITION	PANEL PIERCING 'A'	TOTAL LOCK MOVEMENT	KEY WITHDRAW POSITION	PANEL PIERCING 'B'
A = 30°	1		H = 90°	1+4	
B = 60°	1		J = 120°	1+4	
C = 90°	1		K = 150°	1+4	
D = 120°	1		L = 180°	1+4+7	
E = 150°	1		M = 270°	1+4+7+10	
F = 180°	1+7		N = 260°	1+4+7+10	
G = 360°	1+7				

SWITCH INDEX ANGLE
3 = 30°
6 = 60°
9 = 90°

NUMBER OF SWITCH POLES
1 = 1 POLE
2 = 2 POLE
3 = 3 POLE
4 = 4 POLE

TERMINATION
S = SOLDER
P = PCB