

REV	ECN. NO.	APP	DATE
A	EDIÇÃO INICIAL		
B	NOVO CÓDIGO		

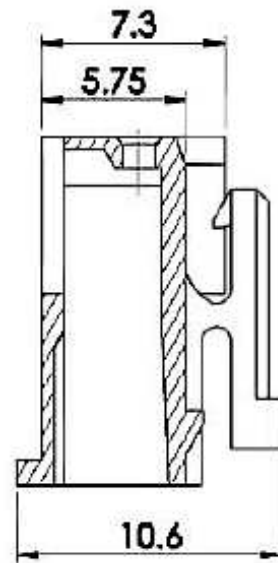

SEC. O-O'

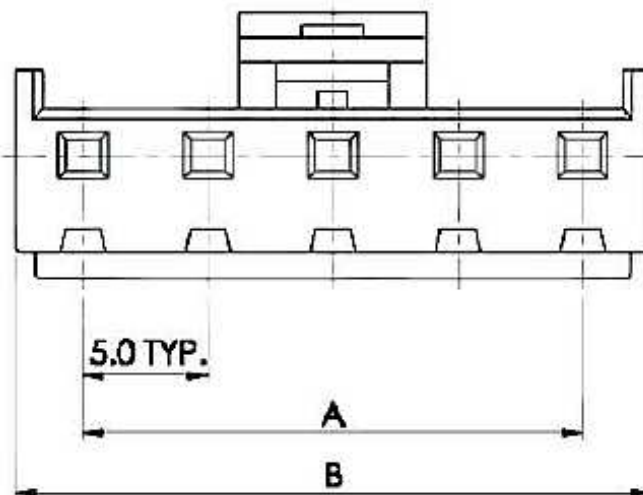
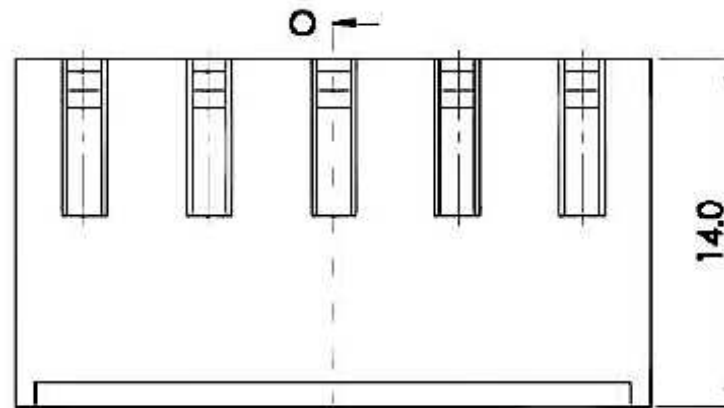

SPECIFICATIONS

- Current Rating : 7A AC,DC (AWG 18)
- Voltage Rating : 250V AC,DC
- Withstand Voltage : 1500V AC/Minute
- Contact Resistance : 10 mΩ Max.
- Insulation Resistance : 1000 MΩ Min.
- Temperature Range : -25°C to +85°C

HOW TO ORDER:

5000H[]R

1

1- Nr. of Positions
02 to 10

Circuits	Dim. A	Dim. B
2	5.0	10.4
3	10.0	15.4
4	15.0	20.4
5	20.0	25.4
6	25.0	30.4
7	30.0	35.4
8	35.0	40.4
9	40.0	45.4
10	45.0	50.4

 MATRIX		MATRIX TECNOLOGIA IND. E COM. LTDA.		
				UNIT mm
TOLERANCE: ±0.25				APP. BY
		MATL	CHK. BY	
		DWG. NO.	DR. BY FELIPE	