

REV	ECN. NO.	APP	DATE
A	EDIÇÃO INICIAL		

MATERIAL

Insulator - PBT(UL 94V-0)

Contact - Copper Alloy

SPECIFICATION

Current Rating: 1Amp DC

Contact Resistance: 30Milliohm min.

Dielectric Voltage: 500V AC for One Minute

Operatint Temperature: -40°C to 105°C

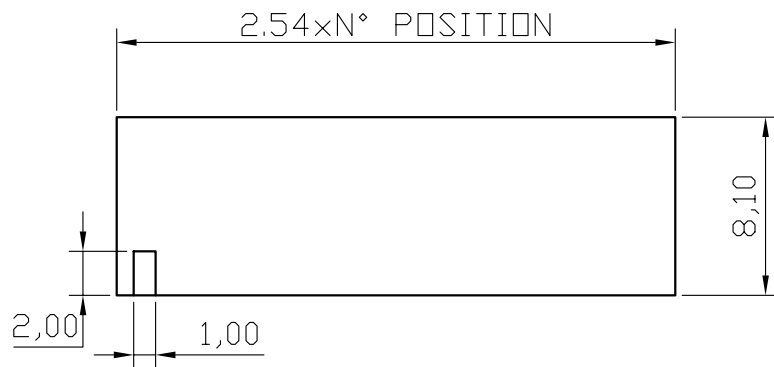
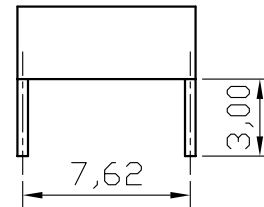
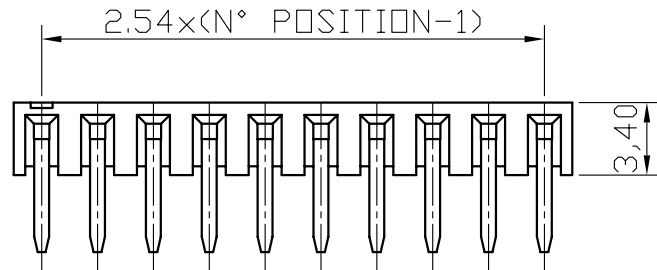

HOW TO ORDER:

MAT[][S][R][][S][][][R]

1 2 3 4 5 6 7

1- Nr. of Ways
Single Row: 1 to 40
Double Row: 2 to 80

2- Row Version:
(S)-Single Row
(D)-Double Row

3- Pin Style
(N)-90°
(R)-180°

4- Terminal Plating:
(E)-Sn
(D)-FLASH Au
(F)-0,38um Au
(G)-0,76um Au
(C)-0,38um Au/Sn
(H)-0,76um Au/Sn

5- Profile:
(E)-3,3mm
(G)-3,4mm

6- Pin Length:
(A)-3,0mm (Profile 3,4mm)

7- (R) RoHS Compliant



MATRIX Tecnologia Ind. e Com. Ltda.

UNIT mm	SCALE 3:1	TITLE 2.54mm FEMALE HEADER SIDE ENTRY SINGLE ROW H=3.4mm	DATE JULY 2007
TOLERANCE: ±0.25			APP. BY
		MATL	CHK. BY
		DWG. NO.	DR. BY DIEGO