

REV/	ECN. NO.	APP	DATE
A	EDIÇÃO INICIAL		

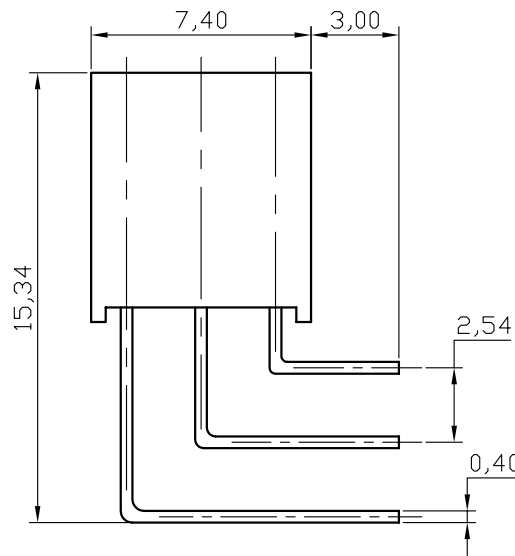
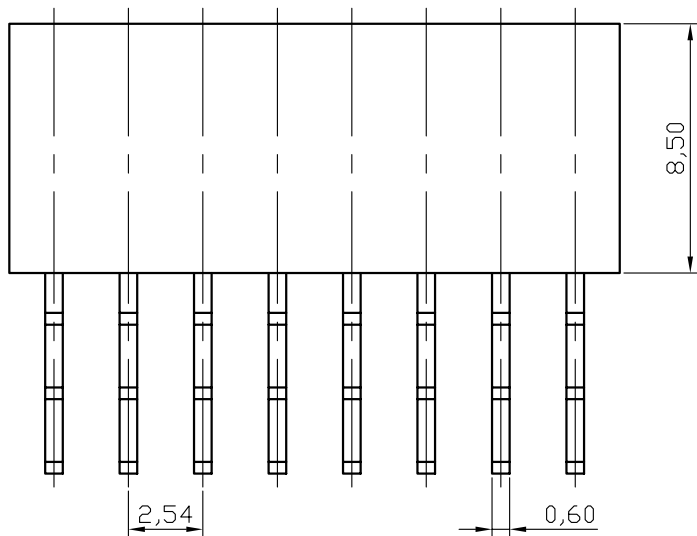

SPECIFICATIONS

Current Rating: 3Amps
 Insulator Resistance: 1000 Megaohms min.
 Contact Resistance: 20m ohms max.
 Dielectric Withstanding: 600V AC/DC
 Operating Temperature: -40°C to 105°C

MATERIALS

Contact Material: Phosphor Bronze
 Insulation Material: Polyester, UL 94V-0
 P.B.T

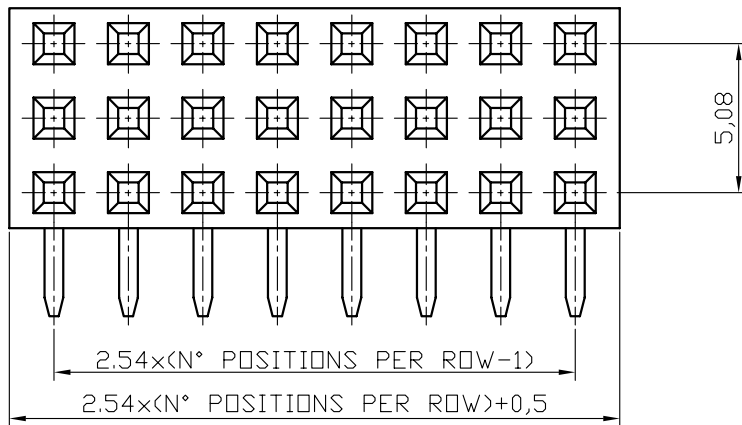

HOW TO ORDER:
MAT[][T][N][][S][][R]
1 2 3 4 5 6

- 1- Nr. of Ways
Triple Row: 9 to 96
- 2- Row Version:
(T)-Triple Row
- 3- Pin Style
(N)-90°
(R)-180°
- 4- Terminal Plating:
(E)-Sn
(D)-FLASH Au
(F)-0,38um Au
(G)-0,76um Au
(C)-0,38um Au/Sn
(H)-0,76um Au/Sn
- 5- Profile:
(S)-8,50mm
(W)-11,0mm
- 6- (R)RoHS Compliant

Recommended P.C.Board Hole Layout

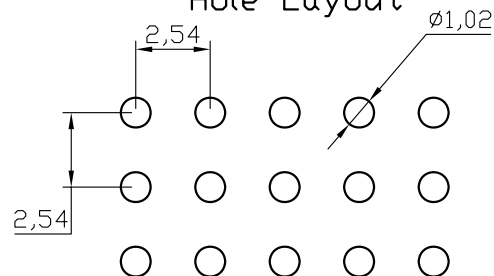

MATRIX Tecnologia Ind. e Com. Ltda.

0.0±	SCALE	TITLE	DATE
0.00±	UNIT mm	2.54mm FEMALE HEADER	JUNE 2007
0.000±		TRIPLE ROW 90° H=8.5mm	APP. BY
		MATL	CHK. BY
		DWG. NO.	DR. BY DIEGO