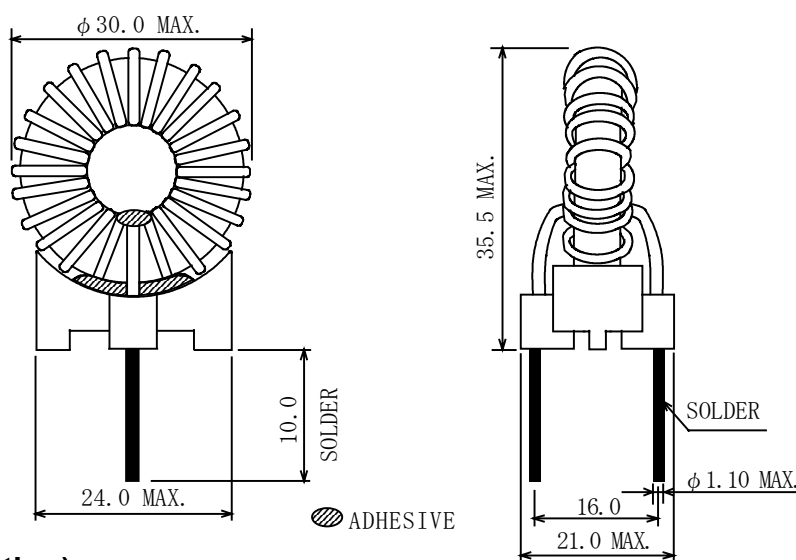

Type: PFN2029
◆ Product Description

- $\phi 30.0\text{mm} \times 35.5\text{mm}.$ MAX.
- Custom design is available

◆ Feature

- Iron dust core is used to realize better DC Saturation characteristics and higher noise absorption effect.
- Less leakage magnetic flux .
- Ideally used as Normal Mode chokes EMI suppression in power supplies or signal lines.
- Ideally used as Power Factor Correction choke
- Elimination for impulse noise.
- RoHS Compliance

◆ Dimensions (mm)

◆ Specification (For EMC application)

Sample No.	Inductance (μH) [MIN.] At 1kHz	D.C.R.($\text{m}\Omega$) [MAX.] (at20°C)	Rated Current (A)※1
PFN2029NP-NM42A	52	30	6.1
PFN2029NP-NM53A	83	38	5.4

※ Rated current: The DC current at which the temperature rise is $\Delta t=40^\circ\text{C}.$ ($T_a=20^\circ\text{C}$).

◆ Specification (For PFC application)

Sample No.	Inductance(μH) At 1kHz	D.C.R. ($\text{m}\Omega$) [MAX.] (at20°C)	Rated Current (A)※
5342-T010	$10.0 \pm 20\%$	8.5	10.0

※ Rated current: The DC current at which the inductance decreases to 90 % of it's initial value or when $\Delta t=40^\circ\text{C}$, whichever is lower($T_a=20^\circ\text{C}$).