

Type: LC-12

◆ **Product Description**

- ϕ 13.0mm Max.(L×W), 4.5mm Max. Height.
- In addition to the typical versions of parameters shown here, custom designs are available to meet your exact requirements.



◆ **Feature**

- Magnetically shielded construction.
- Max. Operating frequency 500kHz,
Max. Operating 1.7W (500kHz), 1.6W(300kHz), 0.54W(100kHz).
- Ideally used in Portable equipment, Drive for fluorescent display tube.
- RoHS Compliance

◆ **Dimensions (mm)**

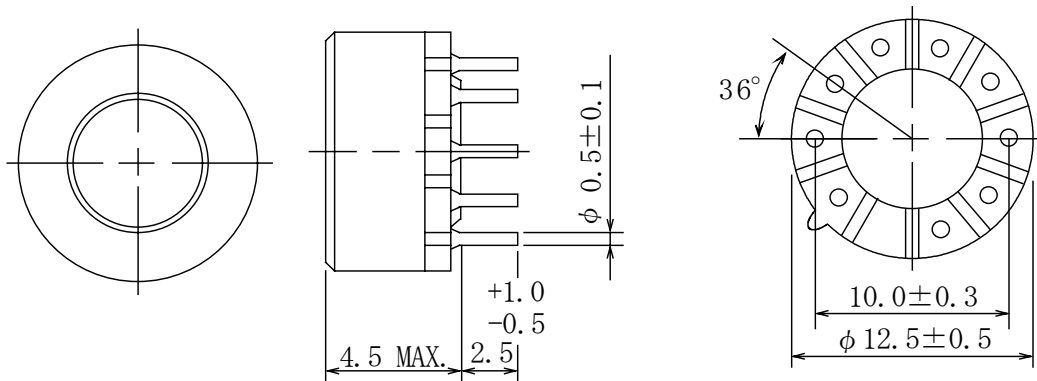

◆ **Schematics (Bottom)**

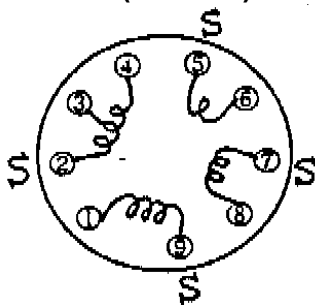

“S” is winding start

◆ **Specification**

Sample No.	Inductance (9-1) 1kHz/1V
0395 - T004	312 μ H \pm 30%