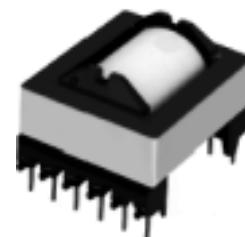
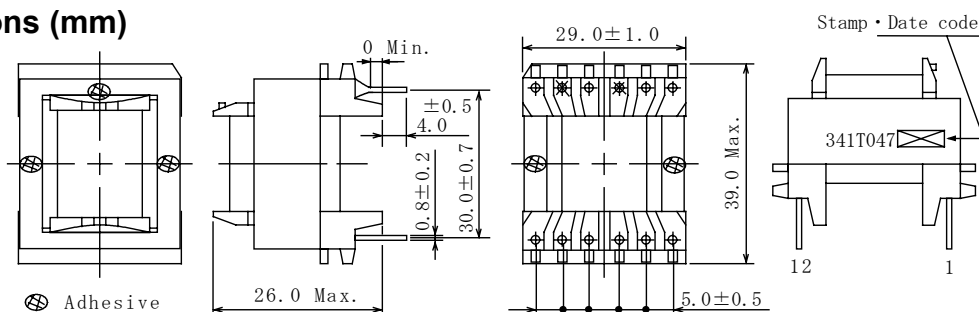
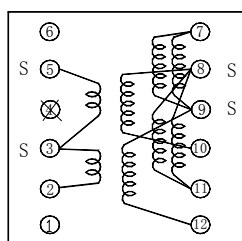
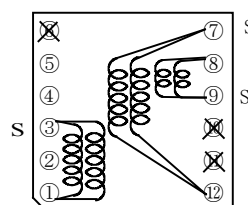

Type: ERH2826
◆ Product Description

- 39.0×30.5mm Max.(L×W), 26.0mm Max. Height.
- Custom design is available.

◆ Feature

- Max. Operating frequency 500kHz. Max Operating power 40W(500kHz)
- Ideally used in Switching regulator, EL inverter and Power Factor Correction choke.
- RoHS Compliance

◆ Dimensions (mm)

◆ Schematics (Bottom)
1. For General Transformer

2. For PFC choke

“S” is winding start

◆ Specification (For General Transformer)

Sample No.	Inductance (2-5) 100kHz/1V	D.C.R. (2-5)	D.C.R. (8-11)	Hi-pot Winding-winding 50/60Hz
3341-T052	6.0mH ± 25%	1.1Ω Max.	25.5mΩ Max.	AC 2500Vrms/1s.

◆ Specification (For PFC choke)

Sample No.	Inductance (1-3) 1kHz/1V	D.C.R. (1-3)	D.C.R. (7-12)	Rated Current (1-3)
3341-T049	500 μ H ± 15%	300mΩ Max.	380mΩ Max.	2.5 A

※ Rated current: The DC current at which the inductance decreases to 90 % of it's initial value or when $\Delta t=40^{\circ}\text{C}$, whichever is lower($T_a=20^{\circ}\text{C}$).