

PIN Power Inductor DEPI1615



Halogen Free



Description

- Ferrite core construction.
- Magnetically shielded.
- L × W × H: 16.0 × 15.2 × 14.0 mm Max.
- Product weight: 11.5g(Ref.)
- Moisture Sensitivity Level: 1
- RoHS compliance.
- Halogen Free available.

Environmental Data

- Operating temperature range: -40°C~+85°C (including coil's self temperature rise)
- Storage temperature range: -40°C~+85°C

Packaging

- Box packaging.

Applications

- Ideally used in digital AMP and large LCD etc.

Dimension - [mm]

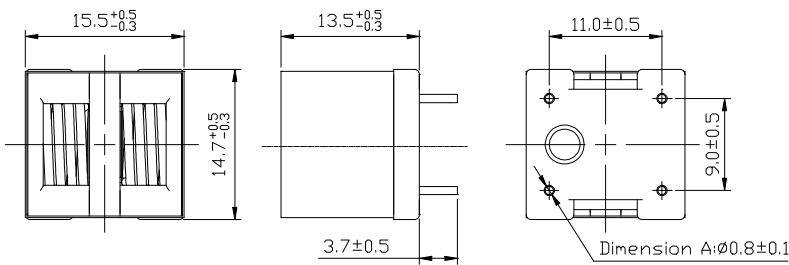

Schematics - [mm]

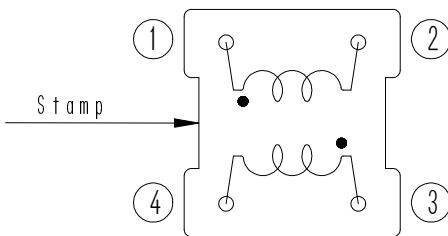

Electrical Characteristics

Part No.	Stamp	Inductance [Within] ※1		D.C.R. (mΩ) (at 20°C) [Max.]		Saturation (A) Current ※2		Temperature Rise current (A) ※3
		(1-2) Between	(3-4) Between	(1-2) Between	(3-4) Between	(20°C)	(105°C)	
DEPI1615NP-5R0N	5R0N	5 μH ±30%	5 μH ±30%	7.7(5.9)	7.7(5.9)	13	10	9.5
DEPI1615NP-100N	100N	10 μH ±30%	10 μH ±30%	10(7.6)	10(7.6)	9.6	7.6	8.0
DEPI1615NP-150N	150N	15 μH ±30%	15 μH ±30%	10(7.6)	10(7.6)	6.5	5.0	8.0
DEPI1615NP-220N	220N	22 μH ±30%	22 μH ±30%	10(7.6)	10(7.6)	4.2	3.2	8.0
DEPI1615NP-300N	300N	30 μH ±30%	30 μH ±30%	10(7.6)	10(7.6)	2.8	2.1	8.0

※1. Inductance measuring condition: at 100kHz.

※2. Saturation current: The value of D.C. current when the inductance decreases to 75% of it's nominal value.

※3. Temperature rise current: The value of D.C. current when the temperature rise is Δt=40°C(Ta=20°C).

PIN Power Inductor DEPI1615

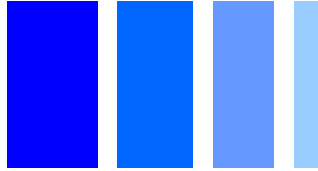

Saturation Current & Temperature Rise Graph

— L (20°C) — L (105°C) — ΔT

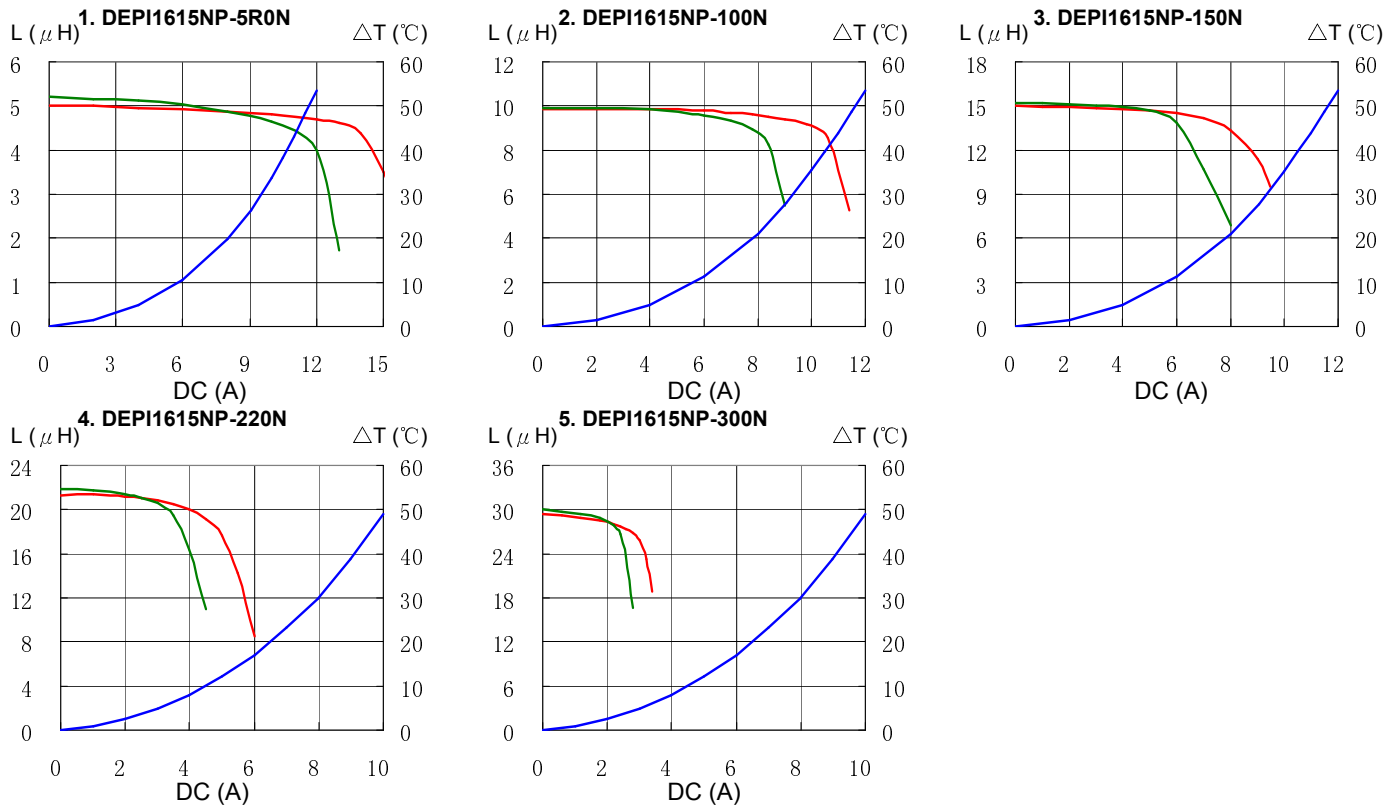

Please refer to the sales offices on our website - <http://www.sumida.com>

Hong Kong

Tel. +852-2880-6688
FAX. +852-2565-9600
sales@hk.sumida.com

Tokyo

Tel. +81-3-5202-7112
FAX. +81-3-5202-7105
sales@jp.sumida.com

Chicago

Tel. +1-847-545-6700
FAX. +1-847-545-6720
sales@us.sumida.com

Shanghai

Tel. +86-021-5836-3299
FAX. +86-021-5836-3266
shanghai.sales@cn.sumida.com

Seoul

Tel. +82-2-6237-0777
FAX. +82-2-6237-0778
sales@kr.sumida.com

Oberzell

Tel. +49-8591-937-0
FAX. +49-8591-937-103
contact@sumida-eu.com

Shenzhen

Tel. +86-755-8291-0228
FAX. +86-755-8291-0338
shenzhen.sales@cn.sumida.com

Singapore

Tel. +65-6296-3388
FAX. +65-6296-3390
sales@sg.sumida.com

Neumarkt

Tel. +49-9181-4509-110
FAX. +49-9181-4509-310
infocomp@eu.sumida.com

Taipei

Tel. +886-2-8751-2737
FAX. +886-2-8751-2738
sales@tw.sumida.com

San Jose

Tel. +1-408-321-9660
FAX. +1-408-321-9308
sales@us.sumida.com